

UW 

RESOURCE GUIDE

2023-24



WELCOME TO THE UNIVERSITY OF WISCONSIN-LA CROSSE!

WE LOOK FORWARD TO YOU JOINING OUR NEW CLASS.

This Resource Guide will provide you with important, often essential, information about our campus and community. We encourage you to read this guide throughout the summer and use it as a reference during your time at UWL.

La Crosse is recognized as one of the best places to live with its arts, restaurants, shopping, and outdoor recreation. With a population of 52,000, there is plenty to see beyond the campus. Your experience at UWL is full of exciting possibilities and your time on campus is the perfect opportunity to take advantage of what we have to offer. Take time to try new things, meet new people, and explore the area.

We are honored that you chose UWL to further your education and help guide your path to future success. The staff and faculty on our campus are here to support and assist you during your time here.

Once again, welcome to the UW-La Crosse family. We're glad you're here!

WELCOME

Campus Directory	4
Important Dates.....	5

ACADEMIC & STUDENT SUPPORT

Academic Advising	6-9
ACCESS Center	10
Career Services	11
Student Employment on Campus.....	11
Multicultural Student Services	12
Records & Registration	13-14
Student Support Services	10
Textbook Rental Services	15
Veteran Services	16

DAILY LIFE

Campus Dining Service.....	45-46
ID Card System	47
Information Technology Services	17-19
Parking & Transportation	20
Residence Halls	21-22
Textbook Rental	15
University Bookstore	15

FINANCIAL RESOURCES

Banking Services	23
Cashier's Office.....	24-26
Financial Aid	27
It Make\$ Cents! Money Management Center.....	29
Alumni & Friends Foundation	30
Scholarship Resource Center	28

HEALTH & SAFETY

Campus Safety/University Police	31
Counseling and Testing Center.....	32
Student Health Center	33-35
Student Life.....	36-37

INVOLVEMENT

Intercollegiate Athletics	38
New Student & Family Programs	39
Off-Campus Faith Communities	40
Recreational Sports Department	41-42
The Arts	43
University Centers.....	44-48

Campus Directory

www.uwlax.edu/info/a-z-directory

ACADEMIC ADVISING CENTER & CAREER SERVICES

608.785.6950
1209 Centennial Hall
advising@uwlax.edu

ACCESS CENTER

608.785.6900
124 Wimberly Hall
ACCESScenter@uwlax.edu

ADMISSIONS OFFICE

608.785.8939
2320 Student Union
admissions@uwlax.edu

CAMPUS OPERATOR

608.785.8000

CASHIER'S OFFICE

608.785.8719
121 Graff Main Hall
cashiers@uwlax.edu

COUNSELING AND TESTING CENTER

608.785.8073
2106 Centennial Hall
www.uwlax.edu/counseling-testing

DINING SERVICES

608.785.8891
1131 Student Union

FINANCIAL AID OFFICE

608.785.8604
215 Graff Main Hall
finaid@uwlax.edu

FOUNDATION OFFICE

608.785.6868
Cleary Alumni & Friends Center
foundation@uwlax.edu

ID CARD OFFICE

608.785.8891
1131 Student Union
uwlcardoffice@uwlax.edu

IT MAKE\$ CENTS!

608.785.8852
0130 Student Union
itmakescents@uwlax.edu

INFORMATION TECHNOLOGY SERVICES

608.785.8774
103 Wing Technology Center
helpdesk@uwlax.edu

MULTICULTURAL STUDENT SERVICES

608.785.8225
1101 Centennial Hall
omss@uwlax.edu

NEW STUDENT AND FAMILY PROGRAMS

608.785.8055
2320 Student Union
parents@uwlax.edu | fye@uwlax.edu

PARKING AND TRANSPORTATION SERVICES

608.785.8061
605 17th St. N.
parking@uwlax.edu

RECORDS AND REGISTRATION

608.785.8951
117 Graff Main Hall
records@uwlax.edu

RECREATIONAL SPORTS

608.785.5225
125 Recreational Eagle Center
recsports@uwlax.edu

RESIDENCE LIFE

608.785.8075
1000 Eagle Hall
housing@uwlax.edu

SCHOLARSHIP RESOURCE CENTER

608.785.8852
0130 Student Union
uwlships@uwlax.edu

STUDENT HEALTH CENTER

608.785.8558
Health Science Center
shcnetworking@uwlax.edu

STUDENT LIFE OFFICE

149 Graff Main Hall
608.785.8062
studentlife@uwlax.edu

STUDENT SUPPORT SERVICES

608.785.8535
2131 Centennial Hall
sss@uwlax.edu

STUDENT UNION INFORMATION CENTER & TICKET OFFICE

608.785.8877
Main Level, Student Union
ucfolio@uwlax.edu

TEXTBOOK RENTAL

608.785.8853
Lower Level, Student Union
textbook@uwlax.edu

UNIVERSITY BOOKSTORE

608.785.8855
Main Level, Student Union

UNIVERSITY CENTERS

608.785.8888
3200 Student Union
univcenters@uwlax.edu

UNIVERSITY POLICE

Non-Emergency 608.789.9000
Emergency 608.789.9999
605 17th St. N.

UWL ALUMNI ASSOCIATION

608.785.8489
Cleary Alumni & Friends Center
alumni@uwlax.edu

VETERAN BENEFITS

608.785.8631
233 Graff Main Hall
uwlveted@uwlax.edu

WHITNEY CENTER MENU HOTLINE

608.785.8899

Important Dates

FALL 2023 SEMESTER

New Student Orientation	Friday, September 1 – Monday, September 4
Residence Halls: New Freshman Move-in	Wednesday, August 30 – Saturday, September 2 (12 p.m.) (Date will be assigned to student)
Labor Day Holiday	Monday, September 4
Classes Begin	Tuesday, September 5
Fall Bill Payment Due	Monday, October 3
Family Weekend	Friday, October 20 – Sunday, October 22*
Last Day to Withdraw from Classes with a ‘W’	Monday, November 6
Winter Intersession Registration Begins	Thursday, November 9
Spring Registration Begins	Monday, November 13 (date will be assigned to student)
Last Day to Withdraw from the University	Friday, November 17
Thanksgiving Recess Begins	Wednesday, November 22 (Residence Halls Remain Open)
Classes Resume	Monday, November 27
Last Day of Classes	Wednesday, December 13
Final Exams	Friday, December 15 – Wednesday, December 20
Residence Halls Close	Friday, December 22

JANUARY 2024 WINTER INTERSESSION

Tuesday, January 2 – Friday, January 19
For the students taking Winter Intersession classes: All Residence Halls remain open;
a fee will be charged for students staying during this time.

SPRING 2024 SEMESTER

Residence Halls Open	Saturday, January 20
Classes Begin	Monday, January 22
Spring Bill Payment Due	Friday, February 16
Spring Break	Friday, March 8 (5:30 p.m.) – Sunday, March 17 (Residence Halls Remain Open)
Classes Resume	Monday, March 18
Last Day to Withdraw from Classes with a ‘W’	Friday, March 29
Summer Registration Begins	Thursday, March 28
Fall Registration Begins	Thursday, April 4 (Date will be assigned to student)
Last Day to Withdraw from the University	Friday, April 12
Last Day of Classes	Friday, May 3
Final Exams	Monday, May 6 – Friday, May 10
Residence Halls Close	Saturday, May 11

SUMMER 2024 SESSIONS

Reuter Hall available for summer residents.

Summer Session I:	Monday, May 20 – June 14
Summer Session II:	Monday, June 17 – Friday, July 12
Summer Session III:	Monday, July 15 – Friday, August 9
Summer Housing Ends	Friday, August 18

FOR FURTHER INFORMATION

Billing & Payment Deadlines:

See ‘Cashier’s Office’ on pages
24-26.

Academic Dates & Deadlines:

www.uwlax.edu/records/dates-and-deadlines

*Dates subject to change.

Academic Advising

A SPECIAL NOTE TO PARENTS AND FAMILIES

The first semester of college can be a stressful time. Many students have never lived away from home before and are now faced with new responsibilities and expectations. The Academic Advising Center (AAC) is here to help. Please encourage your student to make use of the AAC.

We want students to start making progress toward a degree. At the same time, we want students to feel free to do some investigating of different curriculum options. Students should strive to balance a planned, purposeful educational effort with the exploring that produces a well-rounded lifelong learner.

Please help us in this effort by affirming for your student that there is always some level of uncertainty about the college experience. Many students are unsure about what academic path to take and what their life's pursuit ought to be. That's okay! The undergraduate experience at UW-La Crosse helps students make good choices. The exploration that occurs along the way is an important developmental step for your student to take.

We hope you will join with the AAC to encourage your student to:

- Make an effort to 'connect' with at least one faculty member. Our faculty really does want to build relationships with their students.
- Visit the Academic Advising Center early in the first semester to learn about the wide range of services and support available.
- Learn about, and make use of, all the campus resources that UWL provides to make students' academic and social experiences the best they can be.

ACADEMIC ADVISING plays an important role in helping students achieve their educational goals. It is a process that encompasses student development along with the delivery of accurate, up-to-date information regarding career options, educational programs, courses of instruction, resources, and policies and procedures to most effectively aid the student in pursuing their educational goals.

It is important for students to consult their advisors regarding program development, major and career choices and concerns, course sequencing and course selection. Students are encouraged to make a connection with their advisor early in their college career. Students should schedule a minimum of one meeting with their advisor each semester.

Advisors are assigned to each undergraduate student based on their chosen major.

Students who have not declared a major are assigned to a faculty advisor in one of the colleges or to an advisor in the Academic Advising Center.

DEANS' OFFICES

Staff members are available in each college Dean's Academic Services Office to interpret and carry out university policy for the college. Students should contact their college Academic Services Office regarding graduation requirements, change of majors/minors, inter-college transfers, admission to programs, academic action appeals, petitions for exceptions to curriculum requirements and policies, and transfer credit evaluations. Staff members are also available to answer questions and give advice on a variety of other topics related to your student's journey through the curriculum.

Academic Advising

TUTORING SERVICES

Students who are seeking additional assistance in a specific academic area may contact the academic department to find out about tutoring services. Some departments have student tutors who work in a lab setting. Students can stop by for assistance during designated lab hours. Other departments require that students contact the faculty members for assistance.

Many UWL students utilize the Murphy Learning Center, a free tutoring service on campus. Tutors are available in subjects, such as: Accounting, Biology/Microbiology, Chemistry, Earth Science, Economics, Geography, History, Mathematics, Philosophy, Physics, and Psychology. In addition, The Writing Center consultants are available to assist with all of your writing needs. Visit www.uwlax.edu/murphy-learning-center for more information.

THE ACADEMIC ADVISING CENTER

608.785.6950 | 1209 Centennial Hall

advising@uwlax.edu

www.uwlax.edu/aaccs

The Academic Advising Center is an integral part of the advising partnership between UWL students, staff, and faculty.

We help students with questions and concerns, including:

- Selection of major and minor
- Connecting major/minor fields of study to life and career goals
- Registration questions and related policies/processes
- Explanation of courses, catalog requirements, and the General Education Program
- Information about graduate school opportunities

PRE-HEALTH STUDENT RESOURCE CENTER

608.785.6950 | 1209 Centennial Hall

prehealth@uwlax.edu

www.uwlax.edu/pre-health

Whether you are planning on a career as a physician, physical therapist, physician assistant, occupational therapist, or any of the numerous health-related career possibilities, we are here to support you.

The Pre-Health Student Resource Center provides:

- Comprehensive health professions information for students, faculty, and staff
- One-on-one and group academic and career advising with a focus on pre-health paths
- Workshops and events for career exploration, grad school preparation, and application tips
- Opportunities to explore, shadow, and network via our community partnerships
- Instruction of Introduction to Health Professions, HP 106 (for credit)

Academic Advising

COLLEGE OF BUSINESS ADMINISTRATION (CBA)

Nicole Vidden | Erin Flottmeyer
608.785.8090 | 1205 Wittich Hall
nvidden@uwlax.edu | eflottmeyer@uwlax.edu
www.uwlax.edu/cba

- Accountancy
- Business Analytics
- Economics
- Finance (Risk, Insurance and Financial Planning)
- Information Systems
- International Business
- Management
- Marketing
- Undecided in College of Business Administration

SCHOOL OF EDUCATION (SOE)

Jen Pinnow
608.785.8127 | 260 Morris Hall
jpinnow@uwlax.edu
www.uwlax.edu/soe

- Early Childhood Education (ECE; birth - grade 3)
- Elementary/Middle Education (EME; grades K-9)
 - Elementary/Middle Education (K-9) and Special Education (K-12) dual certification
 - Elementary/Middle Education (K-9) and Teaching English to Speakers of Other Languages (K-12) dual certification
 - Elementary/Middle Education (K-9) and Spanish Education (K-12)
 - Elementary/Middle Education (K-9) and French Education (K-12)
- K-12 Education (grades K-12)
Majors include French; Spanish; Art; Music; Physical, Adapted, and School Health Education
- Secondary Teacher Education Program (STEP; grades 4-12)
Majors include Broad Field Social Studies (concentrations in History, Political Science, Sociology), English, Mathematics, Science (concentrations in Biology, Chemistry, Physics)
- Undecided in School of Education

COLLEGE OF ARTS, SOCIAL SCIENCES, AND HUMANITIES (CASSH)

including the School of Visual and Performing Arts (VPA)

Britta Osborne
608.785.8113 | 138 Wimberly Hall
bosborne@uwlax.edu
www.uwlax.edu/cassh

- Archaeological Studies (Cultural Anthropology)
- Art
- Communication Studies (Interpersonal Communication, Media Studies, Organizational and Professional Communication, Public Communication and Advocacy)
- Economics
- English (Literary & Cultural Studies, Medical Professions, Writing & Rhetoric)
- French (Business)
- German Studies (Business)
- History (Regional, Topical, and World)
- Music (Jazz Performance, Performance, Piano Pedagogy, Theory)
- Philosophy
- Political Science
- Pre-Law Track (pre-professional track; students will still need to select a major)
- Psychology
- Public Administration
- Race, Gender, and Sexuality Studies
- Sociology
- Spanish
- Theatre & Dance (Arts Administration, Design/Technical, General, Musical Theatre, Performance, Stage Management)
- Undecided in the College of Arts, Social Sciences, and Humanities (including the School of Visual and Performing Arts)

Academic Advising

COLLEGE OF SCIENCE AND HEALTH (CSH)

Carla Burkhardt | Guy Herling

608.785.8218 | 105 Graff Main Hall

cburkhardt@uwlax.edu | gherling@uwlax.edu

www.uwlax.edu/csh

- Biochemistry ASB
- Biology (Aquatic Science, Biomedical Science, Molecular Genetics & Cell Biology, Environmental Science, Plant & Fungal)
- Chemistry (ACS Certification, Business, Environmental Science)
- Clinical Laboratory Science
- Computer Engineering
- Computer Science (Cybersecurity)
- Exercise & Sport Science - Exercise Science (Fitness track, Pre-Professional track)
- Exercise & Sport Science - Sport Management
- Geography (Geographic Information Science, Environmental Science, Humans & the Environment)
- Mathematics (Applied Math)
- Microbiology (Biomedical, Business, Environmental Science)
- Nuclear Medicine Technology
- Physics (Applied, Astronomy, Biomedical, Business, Computational, Optics)
- Public Health and Community Health Education
- Radiologic Science (Radiation Therapy, Diagnostic Medical Sonography, Radiologic Technology)
- Recreation Management (Community, Generalist, Outdoor, Tourism & Event Management)
- Statistics (Actuarial Science)
- Therapeutic Recreation
- Undecided in College of Science and Health

PRE-PROFESSIONAL TRACKS

UWL students are provided the opportunity to complete requirements in a variety of pre-professional fields on the campus prior to applying to other colleges and universities for admission to their professional programs.

NOTE: Pre-professional tracks are not a major, but are declared alongside a major.

College of Science and Health

608.785.8218 | 105 Graff Main Hall

www.uwlax.edu/csh/pre-professional-programs

- Engineering (dual degree available)
- Forestry (Conservation, Natural Resources, Wildlife Management)

Pre-Health Student Resource Center

608.785.6950 | 1209 Centennial Hall

www.uwlax.edu/pre-health

- Athletic Training
- Chiropractic
- Clinical Exercise Physiology
- Dentistry
- Genetic Counseling
- Medical Dosimetry
- Medicine
- Occupational Therapy
- Optometry
- Pharmacy
- Physical Therapy (dual degree available)
- Physician Assistant Studies
- Podiatry
- Veterinary Medicine

Student Support Services

www.uwlax.edu/sss | 2131 Centennial Hall | 608.785.8535

Student Support Services (SSS) is a federally funded TRIO program serving first-generation college students (neither parent has a four-year degree), students who come from income-eligible households based on federal guidelines, and students with a documented disability.

Upon acceptance into SSS, all students are assigned to an SSS advisor. The advisor assesses each participant individually and offers guidance based on individual need. The advisor will meet with the participant at least twice a semester and may provide the student with academic, career, personal, or financial aid advising. Areas of guidance traditionally include course selection, declaring a major, study skills, financial literacy, career readiness, and referrals to appropriate offices.

The SSS staff also includes math and writing specialists who offer professional tutoring in their respective areas, as well as a trained team of peer tutors who can help in various math and science courses. In addition, SSS will arrange specialized tutoring for students requiring academic support in courses not covered by regular tutors.

Additionally, SSS offers grant aid (supplemental financial aid) to Pell-eligible students who demonstrate significant unmet financial need. Students have the opportunity to apply for grant aid twice yearly, in fall and spring semesters.

SSS students have access to quiet, centrally-located study spaces; assistive technology; peer mentoring; free printing; a food pantry; cultural, de-stressing, and social events; and a safe, supportive community of belonging.

Finally, SSS can only serve 350 students annually, so selection into the program is based on eligibility requirements as well as a student's academic need and level of commitment. Once a student is selected for participation in SSS, they can utilize SSS services and programming until graduation.

To apply, visit www.uwlax.edu/sss/getting-started

Questions? Contact us at sss@uwlax.edu.



UW-La Crosse Student Support Services



@uwlaxsss

ACCESS Center

www.uwlax.edu/center/access | 124 Wimberly Hall | 608.785.6900

The ACCESS Center provides services to students attending UWL who have a documented disability. ACCESS Center staff will meet with students and, based on documentation, determine appropriate academic accommodations to help students accomplish their academic goals and give them the support they need to graduation.

If you have a documented physical, sensory, psychological, or learning disability that is challenging you, get the support and assistance you deserve to help you make the most of your education and campus life activities.

Career Services

www.uwlax.edu/aaccs | 1209 Centennial Hall | 608.785.8514

An important part of the educational experience is finding a meaningful career. The Career Services Office assists students in their career decision-making by helping them identify career options, learn about potential employers, gain relevant experiences, and conduct their job search.

OUR SERVICES:

INDIVIDUAL CAREER ADVISING APPOINTMENTS:

Students meet with advisors to explore internship opportunities, job market and employment trends in their field, and discuss job search strategies and graduate and professional school options that match their career and life goals.

INTERSHIPS:

The Career Services Office coordinates hundreds of internship experiences each year allowing students to gain experience related to their academic and occupational goals. Planning for an internship begins early, commonly in their sophomore year.

HANDSHAKE:

This online career management tool is a one-stop resource for part-time and summer jobs, internships, jobs for graduates, on-campus interviews and campus career events.

JOB SEARCH DOCUMENTS AND SKILLS:

Advisors guide students through the job search process by assisting them with resumes, cover letters, and interviewing skills.

GRADUATE SCHOOL ASSISTANCE:

Students meet with career advisors for assistance with graduate school searches and the application process.

CAREER EVENTS:

Career Services sponsors several major career events each year. These events provide students an opportunity to visit informally with representatives from health services, education, business, government, and industry. Cooperating employers visit campus to share information with students on career options with their organizations.

PRESENTATIONS:

Career Services staff members regularly speak to classes and student groups about career-related topics.

Student Employment on Campus

144 Graff Main Hall | 608.785.8013

Many students enjoy the benefits of working part-time while going to school. Working part-time is a great way to assist with paying for the cost to attend college. Part-time work also helps students to improve their time management and organizational skills, while they are gaining valuable work experience.

With over 1,000 student employment jobs awarded annually, students are encouraged to first ask their major department if there are any openings in which the student could work and learn more about their field within their major department. Other opportunities may be listed in Handshake (Career Services job portal) or in the Financial Aid Office.

FOR MORE INFORMATION, VISIT:

www.uwlax.edu/finaid/info/student-employment/
or
[www.uwlax.edu/human-resources/services/
onboarding-center/student-employees/](http://www.uwlax.edu/human-resources/services/onboarding-center/student-employees/)

Multicultural Student Services

www.uwlax.edu/mss | 1101 Centennial Hall | 608.785.8225

The Office of Multicultural Student Services (OMSS) uses a student-centered approach to academic excellence, leadership, and the personal/social development of African American/Black, Indigenous/American Indian, Hispanic/Latinx, Asian American, Hmoob, and biracial or multi-ethnic students at UWL. We strive to assist students' success through academic and financial retention.

We provide leadership opportunities and advocacy to support cultural awareness, identity development, and to foster connections and a greater sense of belonging. In addition, the office provides access to multicultural resources for the campus and broader community. OMSS models servant leadership through racial and cultural experiences. We value and support access, equity, human understanding, shared values, and respect for individual differences. Our goal is to assist students to graduate from the university and prepare them to contribute to their communities and society at large.

AREAS OF SERVICE AND OUTREACH:

- Academic and financial aid retention
- Personal guidance, support, and advocacy for students
- Academic Success Institute (summer bridge program)
- Advising & peer tutoring
- Cultural, educational, and social programming
- Leadership development
- Personal/financial guidance, support, and advocacy for students
- Pre-college programs and tutoring
- Student employment opportunities
- Transfer student advisement

STUDENT ORGANIZATIONS

OMSS leadership and involvement opportunities provide practical, life-long learning for students as well as compliment the academic mission of the university.

Students are encouraged to take advantage of leadership experiences provided by OMSS. Students usually have the opportunity to plan, execute and participate in activities. These include multicultural and diversity student organizations' leadership workshops, attend various retreats, conferences and much more.

OMSS provides leadership training, advisement, and administrative support for the eight active multicultural student organizations listed below:

ALANA

Asian, Latina, African, Native American Womxn

ASO

Asian Student Organization

BSU

Black Student Unity

DiSTEM

Diversity in Science, Technology, Engineering and Mathematics

HOPE

Hmong Organization Promoting Education

IOPA

Intercultural Organization Promoting Awareness

LASO

Latin American Student Organization

NASA

Native American Student Association

Records & Registration

www.uwlax.edu/records | 117 Graff Main Hall | 608.785.8951

Many services are available to students through the online student system called WINGS Student Center. The system requires a student's username and password. Students were sent their username and password when they applied for admission. Students use the WINGS Student Center to register for classes, display their schedules, pay bills and access tax information, add Campus Cash, access grades and GPAs, update their address, check their registration time and the name of their advisor, display their financial aid award, verify their enrollment, request advisement reports, request unofficial or official transcripts, and apply for graduation.

GRADES

Final grades are available on the WINGS Student Center as soon as instructors submit them. Grade point averages (GPAs) are calculated approximately ten days after the last final exam day. Grade reports are not mailed. Instructors notify students directly or through the online learning management system of any in-progress and/or midterm grades. Midterm grades are not posted in WINGS.

ADDRESSES

Students must keep the University informed of any address changes. Students can update their addresses using the WINGS Student Center. Students will be prompted at the beginning of each semester to update their local address unless they live in a residence hall.

CONFIDENTIALITY OF ACADEMIC RECORDS

UWL fully complies with the Family Educational Rights and Privacy Act of 1974 as amended (FERPA). FERPA was designed to protect the privacy of education records, to establish the right of students to inspect and review their education records, and to provide guidelines for the correction of inaccurate or misleading data through informal and formal hearings. A copy of the written procedures may be found on the Records and Registration website (www.uwlax.edu/records/FERPA).

DIRECTORY INFORMATION

UWL designates the following categories of student information as public or "directory information." Such information may be disclosed by the institution for any purpose, at its discretion.

- Names, addresses, campus email addresses, telephone numbers, enrollment status, enrollment dates, academic level (e.g., first year, sophomore, etc.), and school/college.
- Previous institution(s) attended; past and present participation in officially recognized sports and activities; physical factors (height, weight, etc. for athletes).
- Program(s) of study, awards, honors including Dean's List, expected graduation date, degree(s) and credential(s) awarded and earned.

In addition to the items listed above, UW-La Crosse has designated photographs and images that are taken of students at university-sponsored activities as information that may appear in university publications, brochures, etc. without the written consent of students. Addresses are not considered confidential and will be released if requested by a third party.

Currently enrolled students may withhold disclosure of information under FERPA. Students may restrict release of some or all directory information in their WINGS Student Center by the following navigation: Self-Service>Campus Personal Information> FERPA Restrictions. This page is also sometimes called Privacy Settings. Students who do not want directory information released must make changes to their privacy settings prior to the end of the second week of the fall semester. UWL assumes that the lack of a specific request from the student in WINGS for the withholding of directory information, within the time period mentioned above, indicates individual approval for disclosure. Please note that restrictions to name and home address will exclude the student's name from appearing in newspaper listings of the Dean's List and graduation and will prevent potential employers from verifying graduation status. It should be noted that restrictions will prevent certain information from being released, and that students risk being omitted from communication from the University.

UWL cannot release academic records, including grades and GPA to third parties without written permission from the student. Because of this federal law restricting access (even to family members), it is important that students and families maintain good communication about sharing information.

Records & Registration

www.uwlax.edu/records | 117 Graff Main Hall | 608.785.8951

ENROLLMENT VERIFICATIONS

A student may need to provide verification of enrollment for certain situations, such as: health and car insurance, scholarships, loans, and employment. Self-service verification and good student discount is available on WINGS Student Center, and we urge students and families to use this service.

FOUR-YEAR GRADUATION AGREEMENT

The University offers entering first-year students the opportunity to participate in an agreement that ensures graduation within four years of a student's initial enrollment. If the student satisfies all of the conditions of the agreement, but degree completion is delayed because the University did not fulfill its requirements of the agreement, then UW-La Crosse will relieve the student of tuition for the required course(s) remaining after the four-year time period. The agreement must be signed within the first seven weeks of a student's initial enrollment. Not all academic programs are included as part of this formal agreement. For more information on the four-year graduation agreement, visit www.uwlax.edu/admissions/a-four-year-graduation-agreement

REGISTRATION

New first-year students will meet with advisors during the registration period of their chosen registration date. Students will notice some classes have already been added to their schedule based on their chosen major and/or college. After advisement, students will log into their WINGS Student Center to enroll in additional classes. Students will learn how to use Schedule Planner, UWL's registration tool, to build the rest of their class schedule and complete their registration for the fall semester. UWL staff and peer advisors will be on hand to help with any registration questions that may come up during the enrollment process.

Because new first-year students will continue to register throughout June, students will not be able to change their schedule using WINGS until all registration dates have passed. Students may add classes in WINGS through September 11, 2023 and drop classes through September 18, 2023 without instructor permission. Changes after those dates will require instructor permission and in some cases, additional approvals.

When AP scores have been received in July, UWL will evaluate the scores and post appropriate credits to the student's record. If a student registered for a course that is no longer necessary, the Registrar's Office will contact the student to adjust the fall registration.

In November, students register for the winter/spring term using the WINGS Student Center registration system. They are assigned a registration time according to the number of credits they have earned. Students should consult with their faculty or academic advisor prior to registration.

Students should be aware of the following information before attempting to change their schedule:

- You cannot add a class that is "Closed."
- Many classes are already filled to capacity. Once you drop a class, it is unlikely you will be able to add it back to your schedule.
- Do not drop a class from your schedule to add another class unless you have determined the class you want to add is both open and does not have a time conflict with the rest of your schedule. Using the SWAP method of enrollment helps you avoid losing your seat if the other class you want is full.
- If you are enrolled in a class with both a lecture and lab, dropping one part will likely drop the other part, depending on the class. Chemistry 103 lectures, labs and discussions are linked in groups and are not "mix and match." If you are enrolled in CHM 103 and need this class, please do not attempt to change sections.

DATES, DEADLINES, AND POLICIES

Important dates and deadlines for each term can be found at www.uwlax.edu/records/dates-and-deadlines

Policies are also explained in the UWL catalog. Students should make sure they are familiar with these references.

University Bookstore

www.uwlax.edu/bookstore | www.uwlshop.com | 1151mgr@follett.com | Main Level, Student Union | 608.785.8855

The University Bookstore offers an assortment of leisure reading books, course study aids, and classroom resource material not offered through Textbook Rental. Also available in the store are insignia sportswear, gifts and novelties, gift cards, school supplies, basic electronics, calculators, beverages, snacks, and health and beauty aids. Purchases may be made by: cash, debit cards, major credit cards, Apple Pay, Google Pay, and Campus Cash.



Textbook Rental

www.uwlax.edu/textbook-rental | textbook@uwlax.edu | Lower Level, Student Union | 608.785.8853

Textbook Rental Services provides UWL undergraduate students with an economical alternative to purchasing textbooks. Textbook Rental Services is a book rental system supported by segregated fees, which is included in the undergraduate student bill. Students interested in building a professional library may special order textbooks at any time during the semester from the University Bookstore. Students may borrow books from Textbook Rental Services for a short-term reference and research provided there are some in stock and that all students have a copy of the required book for the required class.

FALL TEXTBOOK CHECKOUT BEGINS

MONDAY
AUGUST 21, 2023

DUE DATE FOR FALL TEXTBOOKS

THURSDAY
DECEMBER 21, 2023

HOURS OF OPERATION

MONDAY - FRIDAY
8:00 AM - 4:30 PM

PLEASE NOTE: The above dates are for the Fall 2023 term ONLY. Please visit www.uwlax.edu/textbookrental for specific dates and deadlines for each term.

TEXTBOOK CHECKOUT INFORMATION

An email will be sent to all incoming first-year students during the first week of August 2023 with more information about the textbook checkout process. This email will be sent to student's @uwlax.edu email address. Physical Student ID cards are required to check out textbooks! Only students are allowed to check out their textbooks. No one else is allowed even with the student's ID.

Veteran Services

www.uwlax.edu/veteran-services | 233 Graff Main Hall | 608.785.8631

AREAS OF SERVICE AND OUTREACH

The Veteran Educational Benefits Office serves as the campus focal point for veteran and military-related education benefits. We're here to facilitate your transition from military service to UWL. Veteran Ed Benefits Office staff advise students on benefit options, assist in the application process, serve as the School Certifying Official to the VA or WI Department of Veteran Affairs, and connect veteran/military-connected students with resources on campus and in the community. If you are eligible for veteran-related education benefits, please contact the office to submit your eligibility documents.

UWL SPECIFIC BENEFITS

- Fully staffed Veterans Educational Benefits Office
- Resident tuition rate for veterans and family members under Veterans Choice Act 702/301
- Resident tuition rate for non-resident students who are members of the Wisconsin National Guard or Reserve members when they enroll at UW-La Crosse and have been a member of the qualifying unit for the six-month period immediately preceding the beginning of any semester or session at UW-La Crosse
- Priority Registration for veterans and current service members
- Transfer credit for completed military coursework
- Equivalency credit for General Education GE09 for completing Basic Training
- Approved University Military Duty Withdrawal Policy
- Approved Short Term Military Absence Policy
- Active Student Veterans Association (SVA) chapter
- Dedicated Veterans Lounge within Student Union
- Military Science Department /Army ROTC offered on campus
- Military-connected speakers and presentations

FEDERAL BENEFITS

- Federal Tuition Assistance
- Ch. 33 - Post 9/11 GI Bill
- Ch. 30 - Montgomery GI Bill-Active Duty
- CH. 31 - Veteran Readiness & Employment
- Ch. 1606 - Montgomery GI Bill- Selected Reserve
- Ch. 35 - Survivors and Dependents Educational Assistance

STATE BENEFITS

- WI GI Bill
- National Guard Tuition Assistance



UW-La Crosse Veteran Services



Information Technology Services

www.uwlax.edu/its | www.uwlax.edu/its/helpdesk | 103 Wing Technology Center | 608.785.8774

STUDENT TECHNOLOGY GUIDE

Information Technology Services (ITS) provides computing, network, and educational technology services. A variety of services and support are provided including: help desk, technology consultation, email, printing, file storage, password management, web applications, and more. The Student Technology Guide is available at: kb.uwlax.edu/91037ITS

ITS COMPUTER LABS & RESOURCES

PC and Mac computers are available for use in the Murphy Library. They are loaded with a wide variety of application software including Microsoft Office and Adobe Creative Cloud. Scanners and color/black and white laser printers are available for use.

EAGLE HELP DESK

Technology help is available to students at the Eagle Help Desk. This includes assistance with campus email, file storage, Microsoft Office, Windows OS, macOS, and other campus-supported software. The Eagle Help Desk is your first point of contact for technology questions. Contact us at 608.785.8774, helpdesk@uwlax.edu or stop by room 103 in the Wing Technology Center. Our hours are Monday-Friday from 7:30 a.m.-4:30 p.m. (closed holidays). More info at: uwlax.edu/its/helpdesk

OFFICE 365 PRO PLUS FOR STUDENTS AND EMAIL ACCESS

Microsoft 365 is free for all enrolled students at UWL. This includes a UWL email account and access to download, install and use Microsoft Apps including Outlook, Word, Excel, PowerPoint, OneDrive (and more) on up to five devices (Windows, macOS, iOS, Android). Use Microsoft 365 web apps or download Microsoft Office at: portal.microsoftonline.com

VIRTUAL DESKTOP

Virtual Desktop allows UWL students using Windows, macOS, iOS or Android devices to connect to and use a virtual Windows desktop similar to those in the ITS Computer Classrooms Labs. More info at: kb.uwlax.edu/107263

WIFI: UWL-EAGLE

WiFi is available throughout campus. UWL-Eagle is a secure wireless network which requires you to enter your NetID and password. This should be your default wireless network for full access. More info at: uwlax.edu/its/network-telecom/campus-wireless-services

STUDENT PRINTING

You can print anywhere from your own computer and web connection, or from lab computers. All students receive a \$1.20 allocation at the beginning of the fall and spring semester. The cost per printed page is 5 cents for black & white and 60 cents for color. More info at: uwlax.edu/its/client-services-and-support/pay-for-print

LEARNING MANAGEMENT SYSTEM

Canvas is the innovative learning management system used by UWL faculty and instructional staff to enhance face-to-face instruction or teach courses totally online. Canvas allows “anytime, anywhere” access to course-related files, electronic dropboxes for assignments, online quizzes and tests, email, and grades. Though most faculty use Canvas for their courses, students should note that not all faculty utilize Canvas. If you do not see one of the courses on your course list, please contact the instructor to find out if the course will be activated in Canvas. You can connect by going to: uwlax.edu/canvas. Call Canvas Support first for any Canvas related issues at 1.833.826.8719.

WINGS

WINGS is the name for UWL’s Student Information System (SIS). This system provides students, faculty and staff with access to information relating to recruiting and admissions, records and registration, financial aid, student financials, and enhanced self-service capabilities. More info at: uwlax.edu/wings

ADDITIONAL INFORMATION

ITS provides a variety of other services, including classroom technology support. You can find this information on our web site at: uwlax.edu/ITS.

UWL encourages students to follow the UW System Regent Policy: “Acceptable Use of Information Technology Resources.” These policies can be found in the student and staff handbooks or on the UW System web site under Regent Policies at: wisconsin.edu/regents/policies/

Information Technology Services

www.uwlax.edu/its | www.uwlax.edu/its/helpdesk | 103 Wing Technology Center | 608.785.8774

FREQUENTLY ASKED QUESTIONS

ACCOUNT AND PASSWORD MANAGEMENT

Our convenient 24x7 self-service password and account management page is at: uwlax.edu/password.

Click on “First Time Access” if you have never used your NetID, “Password Management” to recover or reset your password, or “Account Locked” if you are locked out of your account. Remember your password expires every 365 days.

WHAT IS MULTI-FACTOR AUTHENTICATION?

UWL accounts require two forms of authentication for logging in (username/password and a code from a physical device). This makes your account more secure against attacks and compromises

More info at: kb.uwlax.edu/81129

WHAT COMPUTER SHOULD I BUY?

The brand and where to purchase a computer is up to each individual. Our website lists several vendors that provide discounted prices for students.

If you are buying a new laptop or desktop computer, or bringing one you currently own, please read our hardware recommendations at uwlax.edu/its/technology-purchases/purchasing to help ensure compatibility with campus resources.

Whichever choice you make, keep security in mind with your hardware, software, and how you use the Internet. Make sure your computer is covered by your homeowner’s or renter’s insurance.

WHY BUY A MOBILE COMPUTER?

Portability and flexibility are key factors for students. Whether working alone or in a group environment, students have the opportunity to have their mobile device with them at all times. With a mobile device, students can benefit from web applications and Virtual Desktop.

WHAT OPERATING SYSTEM AND SOFTWARE SHOULD I BUY?

Current versions of Windows and macOS are supported. Microsoft 365 is provided to all enrolled students and includes Microsoft. If Adobe applications are needed, Adobe offers a student discount on their website.

SHOULD I DOWNLOAD ANTIVIRUS AND ANTI-MALWARE SOFTWARE?

ITS encourages safe, virus free computing. Without antivirus software your computer can become severely infected. ITS recommends all computers have antivirus software installed before using the campus network. For more information go to:

uwlax.edu/its/client-services-and-support/antivirus-malware-information

DO I HAVE ACCESS TO ONLINE FILE STORAGE?

Yes! Microsoft OneDrive (1TB) and Google Drive (30GB) files can be accessed using your NetID from any computer with an internet connection. More info at: uwlax.edu/its/system-administration/filestorage

WHAT IS CYBER SECURITY?

Cyber security is an important aspect of students using the campus network and computer resources. Always be careful opening suspicious emails and files. If you are not sure, don’t click on a link. You can check if a web link is valid by hovering over it (without clicking) on your computer. You cannot do this on your smartphone, so be extra cautious.

ITS will never ask you for your password. If you receive any request for your password, please delete it immediately without a reply. If you inadvertently clicked on a link or provided your credentials, be sure to immediately change your password (if possible, on campus). If you need additional assistance, please contact the Eagle Help Desk.

NEED MORE INFORMATION?

Visit our Student Technology guide at: kb.uwlax.edu/91037

Check out our Knowledge Base (KB) site available 24x7 at: kb.uwlax.edu

Contact the Eagle Help Desk at: **608.785.8774**, helpdesk@uwlax.edu or support.uwlax.edu

Social Media:

Like us on Facebook @UWLITS
Follow us on Twitter @EagleHelpDesk

Information Technology Services

www.uwlax.edu/its | www.uwlax.edu/its/helpdesk | 103 Wing Technology Center | 608.785.8774

DUO 2-STEP AUTHENTICATION

UWL students will be required to utilize a 2-Step Authentication Process when logging into various applications, such as: Office 365, email, WINGS, and Canvas. This process will require each student to log-in with their NETID and password like always. Then they will need to go through an additional authentication step which confirms they are actually the person logging in.

WHAT IS DUO?

DUO is a multi-factor authentication system we call the 2-Step authentication process. This is occurring on each campus in adherence to UW System Security requirements. Our goal is to keep you and your data safe and secure. Using the DUO system will keep your data safe in the event of a compromised password.

LEARN MORE

A DUO for Students web site is available which provides information on this project and also includes important self-help guides: www.uwlax.edu/its/duo-for-students

HOW DOES DUO PROTECT MY ACCOUNT?

When logging in, you need your username/password along with the numerical code a DUO device generates. These codes change after a short time interval and can only be obtained from a DUO activated device which is assigned to your account. This makes your account more secure against online phishing attacks, because if your password becomes compromised, only you have access to the DUO device for your account.

WHAT OPTIONS DO I HAVE FOR DUO?

ITS recommends that students access DUO through the FREE app for smartphones, DUO Mobile. This app is available at the Apple App Store or Google Play. Some students may not have a smartphone or they may prefer to use a fob.*

**The UWL-approved and supported fob will be available for purchase at the University Bookstore for \$27.38 (\$25.95 retail plus tax). After purchasing a fob from the Bookstore students will need to bring it to the Eagle Help Desk to have it added to their DUO account.*

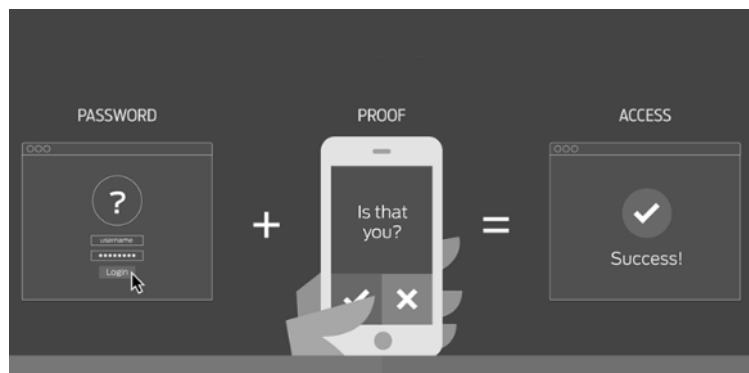

NAVIGATE

WHAT IS NAVIGATE?

Navigate is a student success app that can help you keep track of to-do list items and calendar reminders set by the University, manage any holds you may have on your account, view campus resources, schedule appointments with your academic advisor, view your class schedule, find study buddies within your classes, and more.

HOW DOES NAVIGATE HELP ME BE SUCCESSFUL AT UWL?

There's a lot to manage as a college student. Navigate Student makes it easier by letting you know how and when to get important things done. Through the personalized app, Navigate Student helps you make decisions, complete important tasks, and explore campus.

HOW DO I ACCESS NAVIGATE?

Search "Navigate Student" in your App Store/Google Play Store. When you open the app, you'll select "University of Wisconsin-La Crosse". Log in with your UWL credentials and take the initial intake survey to tell us a little bit more about you. From there you'll have access to all of the Navigate features!

Parking & Transportation Services

www.uwlax.edu/parking | 608 17th Street N | 608.785.8061

PARKING ON CAMPUS

Parking in a University of Wisconsin-La Crosse lot requires a permit or use the Passport Parking mobile app. Permits may be purchased online or at Parking Services for annual, semester, day, or overnight use. The Passport Parking mobile app is available for short-term parking.

PARKING PERMIT SALE

The online parking permit sale will begin in mid-July. Instructions for the online parking permit sale will be emailed to registered students at the end of June. The number of permits is limited and are sold based on student classification, starting with seniors. Once the permits are sold out, a wait list is established for the sale of returned permits. Current rates, rules, and more information is on the Parking Services website.

RESIDENT OR COMMUTER PERMIT

Students living in the residence halls may purchase a resident lot permit and students living off campus may purchase a commuter lot permit.

Motorcycle and moped parking permits are available for designated spaces around campus.

YOUR PLATE IS YOUR PERMIT

Parking Services uses license plate recognition (LPR) technology to enforce our parking lots. Enforcement officers scan license plates with vehicle-mounted cameras.

- Students are required to select a lot to park in and may only park in their assigned lot.
- One vehicle may be registered to your permit. Additional vehicles may be added if it is registered to a family member.

VISITOR PARKING

Visitors must purchase a permit to park on campus using one of the following options:

- Pay with the Passport mobile app.
- Visit Parking Services.

Visitor parking is prohibited in resident lots. 15 minute loading spaces are available in resident lots. Parking is free during the day on weekends in the commuter lots. Any overnight parking requires a permit.

GETTING AROUND

Travel on campus is best done by bicycle or on foot. Bikes should be locked to the racks around campus.

- Green Bikes is a bicycle recycling program supported by UWL's green fund and implemented by UWL Outdoor Connection. It only costs \$15 to rent a green bike. Payment of a \$25, \$50 or \$100 deposit (depending on the quality of the bike) is also required. Deposits will be returned when the bike is returned.
- Drift Cycle is a community bike share that offers an easy to use and affordable bike rental program, to residents, commuters and visitors of the La Crosse Area. Campus hosts two stations, one near the Student Union and another near Whitney Dining Center. Additional stations are spread throughout the city. To utilize this program, download the "DriftCycle" app on your phone.
- Jefferson Bus Lines and Coach USA provide service all over the United States. The bus stop is at the Student Union.
- Amtrak offers service to Milwaukee, Chicago, and Minneapolis where other train connections are available for trips to other parts of the United States.

- American Airlines has daily flights at the La Crosse Regional Airport (LSE).
- Groome Transportation provides airport shuttle service to the Rochester and Minneapolis airports.

CITY AND REGIONAL BUS SERVICE

The La Crosse Municipal Transit Utility (MTU) offers two bus services for UWL students. The Unlimited Passage (U-PASS) provides bus service on any MTU route in La Crosse or Onalaska at NO FARE when students show their UWL student ID. The U-PASS/Safety Bus also has NO FARE and runs Thursday, Friday, and Saturday nights from 9 p.m.-3 a.m. (10 p.m.-3 a.m. on Thursday evenings). The Safety Bus will run from on and off campus housing areas and downtown La Crosse every 15 minutes during these three nights and no identification is required. Students will have a safe ride home with their friends!

Scenic Mississippi Regional Transit (SMRT) buses run Monday-Friday to Crawford, La Crosse, and Vernon counties. Free internet service is provided on buses. Rides are \$3 each way and are not included in student fees. Discount cards are available for purchase. More information is available on the Parking Services website.

Residence Life

www.uwlax.edu/reslife | 1000 Eagle Hall | 608.785.8075

The Office of Residence Life strives to create affirming and inclusive homes for our residents where all people can achieve academic and social success through experiential learning and building meaningful relationships.

THE RESIDENCE HALLS

Approximately one-third of the undergraduate students enrolled in the university reside in one of the ten residence halls with a total population of roughly 3,000. First-year students are required to live on campus and occupy two-thirds of the available beds on campus. Eight of the ten residence halls offer a traditional living experience with community bathrooms and shared lounges. Eagle Hall is a suite-style hall which houses a mix of primarily first-year and second-year students. Reuter Hall offers, mostly upper-class students, single bedrooms in a shared apartment. Visit our website for more information about each of the residence halls and the amenities they offer including common spaces, kitchens, and gaming.

SUPPORT & INVOLVEMENT

We have a team of experienced, professional staff who are directly involved in monitoring services, counseling, relationship-building, community development and accountability. Each residence hall has a Resident Director and Resident Assistants (RAs). Resident Directors consist of our full-time Master-level and current Graduate-level staff who live in each community and supervise the RA team. Resident Assistants are full-time students who personally connect with the residents to assist them in developing a sense of belonging among other students.

Our team hosts a multitude of events, all centered around the goals of interpersonal, academic, and cultural growth. Students are encouraged to be actively involved in their living community.

Additionally, each residence hall has a Core Team that plans social events and engagement opportunities for the residence hall community. If you are interested in joining your hall's Core Team, be sure to let your Resident Assistant know at the start of the fall semester. This is a fantastic way to meet other residents in your building and make quick connections in the residence hall community.

EMPLOYMENT OPPORTUNITIES

The Office of Residence Life employs one of the largest number of students on campus. Positions include: Desk Assistant, Resident Assistant, Custodian Assistant, Mail Center Assistant, and Summer (Conference) Assistants. All positions focus on leadership and professional development and are supervised by both peer leaders and full-time staff. Getting a job in your residence hall is a great way to give back to your community and develop skills to prepare you for future opportunities. We encourage students to watch for position postings beginning in July when they arrive on campus.

SAFETY

All residence hall entrances are locked 24 hours a day. Hall residents and university staff can enter their residence hall with their ID cards. Any guests to the residence halls must be escorted by a hall resident at all times. Students are expected to carry their room key and student ID with them at all times and to keep their room door locked.

Blue Light Safety phones are located at the main entrance of every residence hall and throughout campus.

Fire safety procedures are explained at the beginning of the year. Fire drills are planned every semester. Smoke detectors are mounted in every room and fire extinguishers are located on every floor, wing, or cube.

Safety is our top priority. Please review our list of prohibited items on our website.

ROOM ASSIGNMENTS & MOVE-IN

Room assignments will be emailed to students. After receiving their room and roommate assignments, students should contact their new roommate. It is important that roommates determine who will bring what, such as a TV, microwave, and carpet. Move-in instructions and a map directing students to their hall will be emailed in early August. Students will be asked to sign up for a move-in time.

Residence Life

www.uwlax.edu/reslife | 1000 Eagle Hall | 608.785.8075

WHAT TO BRING, WHAT NOT TO BRING

Start with what makes a place feel like home. That might be a 4 cup coffee pot, a picture of your closest friends or a favorite blanket. Then fill in those boxes with necessities. Don't forget to talk to your roommate to make sure you are not doubling up on items. The rooms are not large and good planning can help it feel spacious while still having everything you need. Our students tell us that necessities include:

- Small microwave (1000 watts or less)
- Snacks
- One or two sets of plastic-ware (plates, forks, etc.)
- Sandals to wear in the shower and a shower tote to carry shampoo
- Pillow
- Extra-long twin size bedding (can be found at most stores)
- Fused power strip (surge protector)
- Umbrella
- 1 set of towels
- Hangers
- Laundry basket and laundry supplies
- School supplies
- Alarm clock
- If lofting a bed - furniture for under a loft (79" or less in length)
- Social Security Card and Photo ID
- Toilet paper, if you live in Eagle or Reuter

If you are in any hall besides Eagle or Reuter:

- Area rug
- Box fan

What should you leave at home? Most students tell us they brought too much stuff! Do you need 4 towels or will 1 towel do? Can you wait and bring your winter boots and coat after your next trip home? We also provide a lot of things for student use at our front desks like irons and ironing boards, pots and pans, vacuums, games, etc. Be sure to check the Residence Life policies to know what is not allowed as this is not an exhaustive list:

- Air Fryers
- Instant Pot
- Homemade lofts - we provide them
- Trash can and recycling bin - we provide them
- Fridge - we provide one
- Pets - other than fish!
- Air conditioners (we provide them for medical needs)
- Space Heaters
- Lamps with plastic shades, halogen lamps, or multiple light lamps
- Non-LED lights
- Non-fused or multi-plug outlets
- Hoverboards or electric skateboards
- Items with the potential for an open flame (Candles with wicks, incense to burn, fireworks/firecrackers)
- "Food board" - board which places weight on the built in bookshelves
- Items that produce wireless signals (routers, printers, etc.)

Bedding:

Mattress size is 33" x 79".
Extra long, fitted twin sheets will fit perfectly.

RESIDENCE LIFE WEBSITE

The Office of Residence Life provides updates and resources online at www.uwlax.edu/reslife to help students and families stay up to date on what is happening in the residence halls and on campus. Move-in instructions, maps, housing application information, and much more is available.

On-Campus Banking Services

www.uwcu.org | Room 1135, First Floor, Student Union | 608.232.5000, ext 3100

UW CREDIT UNION

UW Credit Union is a community-focused, member-owned not-for-profit and we make it easy for UW-La Crosse students to manage their finances. Enjoy fewer fees, better rates, and surcharge-free ATMs. Plus, free online, mobile and text banking, and more!

We are here for all students at our branch in the Student Union (next to the Eagle ID office) Monday through Friday, 9 a.m. to 5 p.m. Stop in to say “hello” and to pick up your Eagle debit card.

Official campus partner of financial services to the UW-La Crosse community.

www.uwcu.org

Federally Insured by NCUA.

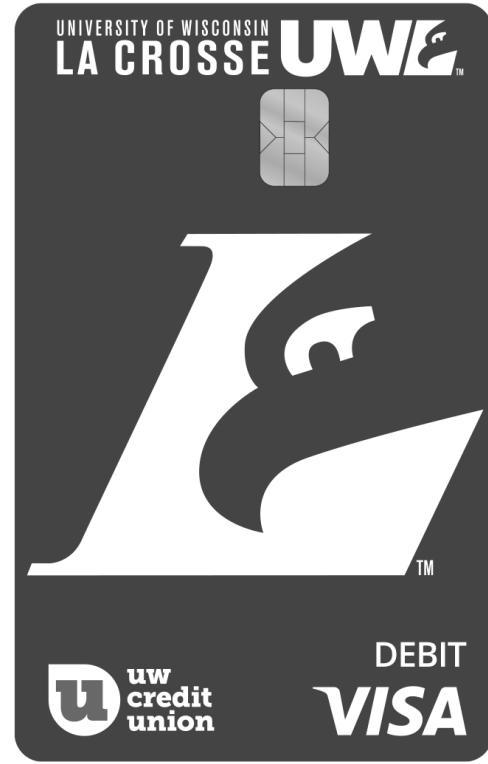

Off-Campus Banking Services

ALTRA FEDERAL CREDIT UNION

www.altra.org

ASSOCIATED BANK

www.associatedbank.com

BMO HARRIS BANK OF LA CROSSE

www.bmoharris.com

CITIZENS STATE BANK

www.citizensstatebank.us

COMMUNITY CREDIT UNION

www.communitycu.com

COULEE BANK

www.couleebank.net

MARINE CREDIT UNION

www.marinecu.com

PARK BANK

www.parkbankplace.com

RIVER BANK

www.riverbank.biz

STATE BANK OF LA CROSSE

www.statebankfinancial.com

US BANK

www.usbank.com

WELLS FARGO BANK-ONALASKA

www.wellsfargo.com

Cashier's Office

www.uwlax.edu/cashiers | 121 Graff Main Hall | 608.785.8719

2023-24 ESTIMATED YEARLY COSTS				
	TUITION & FEES*	ROOM Traditional Double	MEALS Stryker Classic Meal Plan	TOTAL
WISCONSIN	\$9,773	\$4,423	\$2,922	\$17,118
MINNESOTA**	\$10,875	\$4,423	\$2,922	\$18,220
MIDWEST TUITION RATE***	\$12,925	\$4,423	\$2,922	\$20,270
NON-RESIDENT	\$18,681	\$4,423	\$2,922	\$26,026

In addition to these costs, students can expect to spend from \$1,500 to \$2,000 each semester on personal costs such as transportation, clothing, and entertainment.

* UWL has a Textbook Rental Service which is included in the tuition cost.

** Minnesota residents must file for reciprocity under the Minnesota/Wisconsin Reciprocity Agreement. Those who don't apply, or who apply late and/or are not approved, will pay non-resident rates. Applications are available online at www.ohs.state.mn.us/ssl/reciprocity2023/index.cfm

*** The Midwest Tuition Rate includes selected students who are residents of Illinois, Indiana, Iowa, Kansas, Michigan, Missouri, Nebraska, North Dakota, Ohio or South Dakota. This program is managed by the Admissions Office.

TERMS AND CONDITIONS OF FINANCIAL RESPONSIBILITY

All students must electronically sign the [Terms and Conditions of Financial Responsibility at the time of registration each semester](#). New students have a checklist (to-do) item in their WINGS Student Center for signing this agreement. By agreeing to the terms, students agree to pay, in full, the amount of any fees, tuition, housing and meal plan costs, and other miscellaneous charges incurred in connection with attendance at UWL, on the dates indicated by UWL for each semester.

Payment is required on the 15th day of classes for fall and spring semesters. Finance charges start with the 2nd billing cycle in September (for fall) and February (for spring). The 1.50% finance charge is based on the outstanding balance and is assessed on any amounts not paid by the due date indicated on the student bill. Payment in full is required prior to registration for future semesters.

- **Online payment via an electronic check:** This is a fast, free and secure method of making a payment. The payment will post to WINGS within seconds. [This is the preferred method of payment as YOU control when payments are posted.](#) Payment is made through the WINGS Student Center under Finance, or through the Cashier's Office website: www.uwlax.edu/cashiers. Students, parents, and guests can make payments. Students will be charged \$20 for online payments returned for insufficient funds.

- **Online payment via Credit/Debit Card (MasterCard, VISA, Discover, American Express, & Diners Club):** Card companies charge a 2.75% convenience fee. Payment is made through the WINGS Student Center under Finances or through the Cashier's Office website. Students, parents, and guests can make payments.
- **Edvest/529 Plans:** Request your Edvest/529 distribution early. *Plan accordingly!* You **do not** need to wait for an official tuition statement from UWL to submit a request to Edvest/529 plan. Edvest/529 plans pay UWL directly using a paper check or ACH. At the current time, UWL has partnered with Flywire and Transact to accept 529 payments electronically. Some plans can take up to two weeks before the check reaches UWL so allow for processing and mailing time.
 - <https://www.uwlax.edu/info/cost-to-attend/>
- **Check and/or Cash payment at Cashier's Office.** Please note the student ID# on the check. Students will be charged a fee for checks returned for insufficient funds.
- **Check payment mailed to the Cashier's Office** will be posted to the student account on the business date received. Please make checks payable to UWL and note the student ID# on the check. Mail payments to UWL Cashier's Office:

121 Graff Main Hall
1725 State Street
La Crosse, WI 54601

Students will be charged a fee for checks returned for insufficient funds.

Cashier's Office

www.uwlax.edu/cashiers | 121 Graff Main Hall | 608.785.8719

SEMESTER BILLING SCHEDULE			
	FALL 2023	SPRING 2024	INFO
FIRST BILL EMAILED	September 1	January 19	Email from studentAR@uwlax.edu (around 5 p.m.) notifying that the bill is available
PAYMENT DUE	September 25	February 9	Payment is due by the 15th day of classes.
DAILY FINANCE CHARGES	September 26	February 10	Start accruing 1.50% finance charge. Bill must be paid to avoid future registration.

HOW TO VIEW THE BILL

Billing reminders are emailed to students at their official university email address. **Students have the option of setting up Parent Portal** accounts for parents to access their [billing](#) accounts and receive [billing](#) emails when new bills have been posted. See information below. Students can also print or email their bill from WINGS. Charges can be incurred throughout the semester. No paper bill is mailed to students' home address due to Family Educational Rights and Privacy Act (FERPA). FERPA is a Federal law that protects the privacy of student education records.

A \$25.00 non-refundable registration fee is charged each semester when registering for classes. Students are still responsible for this fee even if classes are dropped before the semester starts. This charge is automatically posted to your WINGS account and will be reflected on the billing statement.

Bill due dates are posted online at www.uwlax.edu/cashiers. The bill must be paid in full before a student can register for future semesters.

PARENT/GUARDIAN WINGS ACCESS

We have two separate options for Parent access. Your student can authorize your access to 1.) Online billing payment system and 2.) Individual student records. Your student is highly encouraged to set up both options early in the semester. Failure to set up Parent access prevents the Cashier's Office from speaking with parents regarding your student's account due to FERPA laws.

Give Parent/Guardian Access to VIEW/PAY BILL (Cashnet)

1. Students, log in to WINGS at wings.uwlax.edu with your NetID username and password.
2. Go to Finances (in the middle of the page)click on Grant Access to View/Pay Bill>scroll down to Parent Pins>click on Add New.
3. Upon completion, parent will receive their unique log in information. Additional instructions to pay can be found at www.uwlax.edu/cashiers payment options button.

Give Parent/Guest User Permission to VIEW Student Information (Comply with Federal FERPA Law)

1. Students, log in to WINGS at wings.uwlax.edu with your NetID username and password.
2. Click Main Menu>Self Service >Guest Users, Add a Guest User (green box).
Fill in your guest user name and guest user email address. Students can give parents or guests access to their WINGS Student Center account. Students control what parents or guests can view and do. It is a FERPA violation if we discuss an account without the student's permission. Access for each parent/guest remains in place until the student revokes the access.
3. Upon completion, parent or guest user will be notified.

If you have any questions regarding access, please contact the Cashier's Office.

Cashier's Office

www.uwlax.edu/cashiers | 121 Graff Main Hall | 608.785.8719

FINANCIAL AID DISTRIBUTION DATES	
FALL 2023	Begins September 6
SPRING 2024	Begins January 23

FINANCIAL AID REFUNDS & OTHER REFUNDS

If financial aid funds, scholarships or excess payments applied to the student's WINGS account are more than the balance due, the excess is paid back to the student as a refund. It is strongly encouraged to sign up for Nelnet.

UWL uses Nelnet to electronically deposit student refunds directly into the checking or savings bank account provided. The service is free, highly secure and utilizes SSL encryption, keeping information safe and private.

FOR THE FASTEST REFUND, fill out your banking information ahead of time to prevent delay in receiving refunds.

Students who do not sign up for direct deposit will receive their refund checks by mail to the permanent home address on file. Checks are mailed by default, so it is crucial that students always have their current address on file. If the address is not valid, students risk having their refund checks returned or lost. Allow two weeks for processing and mailing.

DO YOU NEED TO CHANGE YOUR ADDRESS FOR BILLING AND TAX REPORTING PURPOSES?

Access WINGS to view/change your individual student information regarding tuition/fees, local/legal addresses, class schedule, and tax reporting. The student's ID number and password are required to access WINGS.

Form 1098-T is the IRS Tuition Statement issued to all students who had qualified tuition and other related educational expenses billed to them during the previous calendar year. It serves to alert students that they may be eligible for federal income tax education credits as part of their Federal Income Tax Return. For the 2023 tax year, check with the UWL Cashier's website at www.uwlax.edu/cashiers for additional details.

WITHDRAWING FROM THE UNIVERSITY | FEES & REFUNDS

Any new or transfer students choosing not to attend prior to the first day of classes must contact the Admissions Office. If this is not done, students will be placed on class rosters and will be responsible for payment of tuition and fees.

Any student choosing to withdraw after classes have begun must complete the formal withdrawal process through the Office of Student Life, 149 Graff Main Hall. Please note students will be assessed a \$50 withdrawal fee. The amount of refund (if any) is determined by the effective date of the withdrawal.

WITHDRAWAL DATES

For classes starting Tuesday, September 5, 2023:

September 5, 2023-September 18, 2023

- 100% Refund + \$50 Withdrawal Fee

September 19, 2023-October 2, 2023

- 50% Refund

October 3, 2023 or Later

- No Refund

If the student received financial aid, refund requirements of the Higher Education Amendments may affect the student's refund or balance due to the University. Please note that you still are responsible for payment of your bill due to withdrawing from UWL.

ROOM AND MEALS REFUND

Students who withdraw from the University shall be refunded room and meals paid in advance on a weekly-prorated basis. Calculation of the refund amount begins on the Monday of the week following the withdrawal date. The \$150 housing deposit is non-refundable.

Financial Aid Office

www.uwlax.edu/finaid | 215 Graff Main Hall | 608.785.8604

FEDERAL DIRECT LOAN BORROWERS

First-time borrowers in the Federal Direct Loan program need to complete federally required Entrance Loan Counseling (ELC) and sign a Master Promissory Note (MPN) for their loan. Both requirements can be completed at studentaid.gov.

PARENT LOANS

Parents who wish to apply for a Federal Direct Parent PLUS Loan must have their student complete the FAFSA. In addition, the parent must apply for the Parent PLUS Loan online at studentaid.gov and can complete a Direct Parent PLUS Master Promissory Note on the same site. You do not need to be eligible for need-based federal student aid to qualify, however, the parent/borrower must not have an adverse credit history.

PRIVATE STUDENT LOANS

These are private, non-governmental loans for higher education offered by various lenders. You do not need to be eligible for need-based federal student aid to qualify. More information about applying for these types of loans is available at www.uwlax.edu/finaid/financial-aid-quick-links/private-student-loans.

CALCULATING HOW MUCH TO BORROW

Borrow only the amount you need. A helpful worksheet (Calculating How Much You Need to Borrow) is available at www.uwlax.edu/finaid/info/types-of-aid/loans.

Current cost of attendance and an “estimate your campus bill” tool can be found at www.uwlax.edu/cost.

FEDERAL WORK-STUDY

Students who have been awarded/accepted a Federal Work-Study Award and have submitted a Federal Work-Study Assignment Questionnaire will be notified about their work-study position/assignment in mid-August. Award amounts average out to about eight to ten hours of work per week, depending on department needs.

PART-TIME JOB OPPORTUNITIES

All students are welcome to search for on-campus and off-campus part-time jobs listed in the Handshake website at www.uwlax.joinhandshake.com/login. Additional information on Student Employment can be found at www.uwlax.edu/finaid/info/student-employment.

SCHOLARSHIPS

Students who are receiving private scholarships must report these awards to the Financial Aid Office either via WINGS or by completing the “Scholarship & Other Resources Notification” form available at www.uwlax.edu/finaid/financial-aid-quick-links/common-forms. For more information about UWL scholarships as well as an extensive database of outside, private scholarships, visit the UWL Scholarship Resource Center webpage, www.uwlax.edu/scholarships.

LATE FINANCIAL AID APPLICANTS

Students may apply for financial aid throughout the 2023-24 academic year although certain program funds may have been exhausted. Families must complete the Free Application for Federal Student Aid (FAFSA) at studentaid.gov.

REFUNDS

Students are encouraged to set up direct deposit for any refund they might receive. In the “Finances” section of your WINGS Student Center, choose the “Student Choice Refund” option to set this up.

SAVE MONEY BY GRADUATING ON TIME

Students who take an average of 15 credit hours a semester could save in tuition and fees by graduating on time. Tuition and fees are based on 12 credits per semester, making any credits between 12 and 18 almost free credits. Adding the cost of books/supplies, housing, food, transportation, and miscellaneous expenses saved by graduating on time can greatly increase the total amount of savings. Read our helpful tips for graduating on time: www.uwlax.edu/finaid/info/graduate-on-time.

MN RECIPROCITY

Residents of Minnesota must apply for reciprocity and be approved or will be charged the non-resident tuition rate. Apply for MN reciprocity at <https://www.ohe.state.mn.us/ssl/reciprocity2023/index.cfm>.

FERPA (Family Educational Rights and Privacy Act)

If you wish for the Financial Aid Office to be able to discuss your information with your parents or others, you will need to set up a FERPA secure pin in your WINGS Student Center. Information on how to set this up can be found at <https://kb.uwlax.edu/115349>.

Scholarship Resource Center

www.uwlax.edu/scholarships | 0130 Student Union | 608.785.8852

WHO WE ARE

UWL's Scholarship Resource Center (SRC) encourages students to focus on alternative funding options that match with their personal achievements and unique personalities. The SRC is committed to helping students locate scholarships that fit their unique qualifications, educate them regarding submitting high quality applications, and, ultimately, see them further their education by receiving scholarships to fund that education. We accomplish this by simplifying the scholarship search process and offering valuable resources to help our students stand out in their applications. Staying organized and setting aside time for applications is the first step and the second step is actually filling out the application. Visit our webpage or stop by our office to set up a scholarship plan. We also encourage parents to be active in the scholarship process.

OUR SERVICES

Students can make an appointment or stop by our office for assistance with scholarship searching, application review, essay brainstorming, and essay proofreading. We also host a variety of different scholarship workshops throughout the semester. At each of these workshops we give away a \$50 scholarship to a student.

OUTSIDE SCHOLARSHIP DATABASE

External organizations are a significant source of scholarships, but we know finding the right organization and scholarship can take up valuable time for our students. That's why the SRC provides students with an Outside Scholarship Database where we add listings of scholarships specific to the students at UWL.



It Make\$ Cents!

www.uwlax.edu/it-makes-cents | 0130 Student Union | 608.785.8852

IT MAKE\$ CENTS! FINANCIAL LITERACY PROGRAM

The mission of It Make\$ Cents!, a financial literacy program at UWL, is to provide students with knowledge, skills, and resources to develop an understanding of personal finance, including, but not limited to, fostering spending awareness, developing a budget, acquiring appropriate banking knowledge, and determining financial aid options.

The program plans to accomplish this mission through extensive collaboration with other University entities in order to create and present the best holistic financial literacy package to students through a variety of fashions, including: outreach activities, social media, group outreach activities, and online financial tools/assistance, to increase awareness, understanding, and knowledge of relevant financial issues that will empower them to achieve success with regard to their current educational goals and future financial freedom.

WHAT DOES THE PROGRAM OFFER?

- One-on-one consultations with Financial Peer Mentors
- Assistance in personalizing budgets, saving plans, and paying for college
- Fun-filled special events
- Engaging workshops
- Daily topics, tools and contests via Facebook, Snapchat, Instagram, and Twitter
- Online curriculum with useful lessons on various topics

 UW-La Crosse It Make\$ Cents

 @ItMakesCentsUWL

 @itmakescents_uwl

 itmakescentsuwl

 itmakescentsuwl



JOIN US AT OUR "WELCOME WEEK" EVENTS!

Alumni & Friends Foundation

uw lax.edu/go/alignment | Cleary Alumni & Friends Center | 608.785.6803

New organization will continue to promote UWL

For the past two years, leaders of both the UWL Foundation & UWL Alumni Association have been discussing “Optimizing Alignment” (teaming up, collaborating, joining forces) to form a new stronger operation to promote UWL.

We are excited! These two organizations have worked together the past 50-plus years, and we believe this new structure will help us serve our students, alumni, friends and UWL in the best way possible. Our alumni and friends deserve the absolute best, and we plan to deliver.

Here’s what you can find at the UWL Alumni & Friends Foundation for...

CURRENT STUDENTS

Scholarships

Many scholarships have been established over the years by alumni and special friends of the University in an effort to enhance students’ experiences and make their education more affordable.

Eligibility: Scholarship committees select recipients based on the qualifications designed by the donor, faculty recommendations, grade point average, and other materials deemed appropriate by departmental committees.

All scholarships are contingent upon full-time enrollment at UWL for the year of the award, except where otherwise indicated. With few exceptions, scholarships and awards are paid for the academic year following the presentation ceremony.

Application: For the 2024-25 scholarships, incoming first year and continuing students can apply for scholarships online between October 1, 2023-February 1, 2024. Learn more: www.uwlax.edu/scholarships/scholarships/foundation-scholarships/

Student Philanthropy Council

The UWL Student Philanthropy Council (SPC) gives undergraduate students an opportunity to serve as philanthropy ambassadors for UWL, sharing the importance of philanthropy with students and the campus community, and to celebrate the impact donors have at UWL.

SPC partners with the Alumni & Friends Foundation throughout the year: One Day for UWL, Philanthropy Week, Board of Directors activities, and more!



ALUMNI & FRIENDS

Engagement

Our focus is to help everyone who loves UWL have the opportunity to stay connected, get involved, and give back.

We keep you connected to your alma mater by engaging social media, regular university communications, hosting events locally and throughout the country, and being available to create special experiences for alums when they return to campus.

Continue to get involved after your time at UWL by joining one of our alumni networks, wearing your UWL gear as much as possible, attending a reunion, nominating an alum for a distinguished alumni award, or come back for a visit!

Giving Back

Private support is integral to our mission of preparing students for the world. The Alumni & Friends Foundation is the largest private funding resource for the University, and our donors’ gifts directly benefit UWL. We have over 250 areas to support at UWL and we believe everyone can find an area that matches their interests and passion.

Learn more: www.uwlax.edu/go/gift

Did You Know?

More than 1,000 students are impacted by scholarships each year. Each spring the UWL Alumni & Friends Foundation can award over \$1.3 million in scholarships. More than 450 unique opportunities have been established by generous alumni and friends to support students in their education.

Campus Safety & University Police

www.uwlax.edu/police | Non-Emergency 608.789.9000 | Emergency 608.789.9999

Campus safety should be on your list of concerns as your student sets out for UW-La Crosse. University Police works hard to make UWL a safe place to live and learn. This brief outline of what we do as well as what you and your student can do to maintain safety is presented as information and a conversation starter.

UWL employs a staff of police officers that patrol the campus 24 hours a day, 7 days a week. University Police's primary responsibility is ensuring the safety and security of the campus community and facilities. University Police are fully certified law enforcement officers with responsibilities that include criminal matters, enforcement of laws and university codes, emergency medical response, and student, staff, and visitor assistance. Police provide training to the campus community on a wide range of topics, including personal safety, ALICE/active threat response, fire safety, theft prevention, self-defense, emergency response, first aid/CPR/AED, and more. Training opportunities can be found at www.uwlax.edu/police/community-education-request-form/.

Adequate lighting, blue lights, and secure walkways help enhance safety on campus. Landscaping is also planned and carried out with safety in mind. Campus police officers and facilities personnel continuously review and evaluate areas for safety concerns which include watching for lights that need to be replaced or areas that need additional lighting.

Statistical information about crime on campus and the community is collected and reported in UWL's Annual Security Report. Information of these crimes which include sexual harassment, rape, date rape, and corresponding university policies are available at www.uwlax.edu/student-life/student-resources/annual-security-report/. If you would like a hard copy of this report, please contact the Office of Student Life, 149 Graff Main Hall, 608.785.8062, and one will be sent to you.

WHAT CAN STUDENTS DO?

1. Know what to do in an emergency by reviewing the UWL emergency response plan at: www.uwlax.edu/police/emergency-management/emergency-response-plan/
2. Verify you are signed up to receive emergency notifications through the University Police website.
3. Be aware of your surroundings.
4. Lock doors and bikes to prevent crimes.
5. When going out at night, use the buddy system. Go out with friends and go home with friends.
6. Avoid overconsumption of alcohol.
7. If you see something suspicious, report it to the police immediately.

WHAT CAN FAMILIES DO?

Most freshmen are legal adults who would not appreciate a safety lecture. However, families can reinforce and discuss best practices for students to stay safe. Let your student know you are always concerned about them.



Counseling & Testing Center

www.uwlax.edu/counseling-testing | 2106 Centennial Hall | 608.785.8073

Our Counseling Center's mission is to promote students' psychological, academic, social, and cultural growth through professional and confidential counseling services. We accomplish this by maintaining an environment of compassion, collaboration, and inclusivity. Our Testing Center mission is to meet the needs of any examinee by providing access to professional and efficient testing services that adhere to nationally recognized standards.

Office Hours:

Monday - Friday | 8:00 a.m. - 4:30 p.m.

Urgent Care (Crisis):

Monday - Friday | 12:00 p.m. - 4:00 p.m.

Relaxation Room:

Monday - Friday | 8:00 a.m. - 4:30 p.m.

COUNSELING SERVICES

If a student is having personal or mental health difficulties, they may find it helpful to meet with one of our clinicians.

Our counseling services are free and confidential*. We offer brief individual and group counseling services. Our staff consist of licensed mental health professionals including: psychologists, professional counselors, clinical social workers, and supervised professionals-in-training.

Students seek help for a variety of reasons, including:

- Adjustment/transition concerns
- Anxiety
- Grief and loss
- Relationship problems
- Depression
- Drug and alcohol difficulties
- Disordered eating
- Academic difficulties
- Sexual assault
- Family problems or concerns
- Identity-related concerns

LET'S TALK

Let's Talk provides free, no appointment needed, drop-in consultations at locations outside the Counseling & Testing Center (CTC). Students are seen on a first-come, first-served basis. No subject is off limits. Just walk in for a friendly and confidential* consultation. It's not a substitute for formal counseling, but the Let's Talk consultant will listen to your specific problems and discuss options with you. If you have questions, we encourage you to discuss them with a Let's Talk consultant. Call, click, or visit for times and locations. Visit www.uwlax.edu/counseling-testing/lets-talk/ for more information.

URGENT CARE

Urgent Care hours are for students experiencing a mental health crisis (examples of crises include suicidal thoughts, thoughts or urges to harm another person, or a recent traumatic event). These appointments are available to students on a first-come, first-served basis. Available Monday - Friday 12:00 p.m. - 4:00 p.m.

SELF-HELP RESOURCES

The CTC has an extensive list of self-help resources which students can access at any time: www.uwlax.edu/counseling-testing/self-help/.

TESTING SERVICES

Our Testing Center is a member of the National College Testing Association and participates in the NCTA Proctor Network. We follow best practices of the Association of Test Publishers (ATP) and the Council for the Advancement of Standards in Higher Education (CAS). We are an approved test center for many distance learning programs, an ETS computer testing center and administer the UW Placement exams, and offer exams for select test providers, such as: Pearson, Meazure Learning and PSI. Call, click, or visit us in person if you need any assistance with the testing process. Visit www.uwlax.edu/counseling-testing/testing/uwl-testing-center/ for more information.

** Confidentiality: Students can be assured that all personal information discussed with a counselor will remain confidential. Counseling records are not part of a student's academic record and are not shared with other university departments or family members without a student's written permission. State and federal laws strictly regulate exemptions to this policy.*

CARING | COMPASSIONATE | CONFIDENTIAL

Student Health Center

www.uwlax.edu/student-health-center | 1300 Badger Street, Suite 1030 | 608.785.8558

**THE ONLINE HEALTH INFORMATION FORM SHOULD ALREADY BE COMPLETED.
IF YOU HAVE NOT COMPLETED THIS FORM, PLEASE DO SO WITHIN TWO
WEEKS OF YOUR START DATE.**

The Student Health Center (SHC) is operated by Mayo Clinic Health System in La Crosse, and provides state-of-the-art primary care to students enrolled at the University of Wisconsin-La Crosse and Western Technical College (WTC). The SHC is dedicated to cost-effective, evidence-based, student-centered healthcare that promotes wellness and academic success in an atmosphere of kindness, inclusivity, and respect.

The Health Center is staffed with Mayo Clinic providers which include Board Certified Family Physicians, Certified Family Nurse Practitioners, Physician Assistants, and Registered nurses. Our Physical Therapists, Physical Therapy Assistants, Medical Assistants, Medical Lab Technologists, and office staff are experienced in working with the unique health care needs of college students.

WHO CAN USE THE STUDENT HEALTH CENTER?

All UWL and WTC students who are enrolled in the current semester are eligible to utilize the Student Health Center. Students are required to show their student ID card every time they visit the Health Center. During the fall and spring semesters, a fee is automatically included with tuition for UWL students. Students who are not enrolled for credits during winter session and summer session may also use the Health Center after they pay the student health fee. Please visit our website for more information on fees: www.uwlax.edu/student-health-center/fees-and-costs

CONSULTATION AND REFERRAL

With a student's permission, consultations and referrals may be made with several on or off campus offices, (e.g. Dean of Students, Counseling and Testing Center, ACCESS Center, Athletics, International Education and Engagement, Residence Life, County Health Department, local hospitals/clinics). All information in a student's health record is entirely confidential and will not be released to anyone (including relatives) without the student's written consent. Students may schedule an appointment with the Health Information Manager to review their medical records.

EMERGENCY SERVICES

Emergency services are available at two local medical centers—Mayo Clinic Health System - La Crosse and Gundersen Health System. Since emergency services are not included in the health center fee, students are advised to be familiar with their family insurance plan coverage.

WHAT ABOUT INSURANCE COVERAGE?

Students are not required to have insurance to receive care at the Health Center. As described above, payment of student fees covers most costs. However, students are strongly encouraged to obtain supplemental hospital/accident insurance to cover such expenses as hospitalization, emergency services, specialist care, pharmacy, and ambulance transport. The student health fee does not cover these costs. If coverage is available through a family plan, students are urged to have the name of the insurance carrier and policy/subscriber numbers available on campus.

Student Health Center

www.uwlax.edu/student-health-center | 1300 Badger Street, Suite 1030 | 608.785.8558

SERVICES PROVIDED BY THE HEALTH CENTER:

PRIMARY CARE

The Health Center provides a full array of primary care clinic services. These services include physical exams, asthma care, acute illness, dietary counseling, and mental health. The Health Center is open Monday through Friday 8 a.m.-4 p.m. For Winter and Summer sessions, the Health Center is open from 8 a.m.-12 p.m. (noon). Hours vary during summer and winter sessions. See our website for a current schedule. Students may call 608.785.8558 to schedule an appointment. Please note: a \$15 charge is assessed for missing an appointment without sufficient notification.

ACUTE CARE

Students can call 608.785.8558 to make same-day appointments for acute illnesses. The Health Center has same-day appointments available each day the clinic is open. We do have a limited number of appointments and may refer you to care in the community if we are over capacity. Extremely ill students may be referred to the local Emergency Room. After hours urgent care is available at one of the local hospitals or clinics (Mayo Clinic Health System – Franciscan Healthcare and Gundersen Health System). Costs for care at other hospitals or clinics are not covered by the student health fee and are the responsibility of the student.

PHYSICAL THERAPY SERVICES

The Physical Therapy (PT) Department provides a wide range of evaluation and non-operative treatment services for different musculoskeletal conditions including sport-related injuries and back and neck pain. The PT Department also provides comprehensive rehabilitation for students who have undergone orthopedic surgeries. The state-of-the-art PT facility features selectorized and inertial equipment. PT evaluations and re-evaluations are covered by the student health fee—there is no additional charge for these. A rehabilitation fee is charged for each course of in-house treatment each semester (www.uwlax.edu/student-health-center/fees-and-costs).

MINOR INJURY CARE

Students needing injury care after Health Center hours or on weekends should utilize one of the local emergency rooms or walk-in clinics for sprains, strains, and lacerations requiring stitches and burns.

MINOR SURGICAL PROCEDURES

Procedures requiring only local anesthesia can be performed at the Student Health Center. These include treatment of ingrown toe nails, wart removal, incision and draining of abscesses, and mole removal.

GYNECOLOGICAL & REPRODUCTIVE SERVICES

The Student Health Center provides reproductive services including annual gynecological exams, PAP testing, contraceptive services, genitourinary care and STI (Sexually Transmitted Infections) testing.

Student Health Center

www.uwlax.edu/student-health-center | 1300 Badger Street, Suite 1030 | 608.785.8558

LABORATORY SERVICES

The Student Health Center Laboratory provides a wide variety of services, both in-house and through contracted laboratories. A laboratory utilization fee of \$5 is charged for each visit to the laboratory regardless of how many tests are done. Laboratory tests have a nominal fee and students will be informed of this charge prior to the testing. Laboratory testing from outside physicians can also be done here at the Student Health Center along with a \$15 administrative charge for supplies, faxing, or mailings.

ALLERGY INJECTIONS

Allergy injections can be arranged at the Student Health Center for a fee of \$10 per visit, regardless of the number of allergy injections received during the visit. The student's personal physician or allergist must supply the allergen medication and written orders for injections. Students are required to make an appointment with a Student Health Center physician/medical provider before starting allergy injections. All orders must be updated yearly. Please note that a \$15 charge is assessed for not keeping an appointment.

STI SCREENING

Confidential HIV & STI testing is available at the Student Health Center by appointment or via our walk-in STI clinic.

IMMUNIZATIONS

The clinic offers a variety of immunizations to help students meet departmental and college requirements and to prepare themselves for international travel. The Student Health Center recommends the meningococcal vaccine and a yearly flu shot. If your student received the meningococcal vaccine at age 12, a booster is recommended prior to starting college.

PATIENT EDUCATION

Patient education occurs during every patient contact and is viewed by the Student Health Center staff as one of our prime responsibilities. Each visit is an opportunity for educating college students about their health, their medical care, their health choices, and the appropriate use of medical facilities and resources.

NUTRITION SERVICES

Nutritional services are offered by a Registered Dietitian, including nutrition for weight management, disordered eating, sports nutrition, cholesterol control, and diabetic diet. Once a referral is made by one of our Student Health Center providers, appointments can be made through the Student Health Center reception.

PSYCHIATRIC SERVICES

Psychiatric services are available to students. Primary care providers often treat mental health conditions. In addition, referrals to a psychiatric provider are available if needed for more complex and/or chronic conditions.

NO SHOW FEE

Please note that students who do not keep their appointment will be charged a \$15 No Show fee. This fee will be added to the student's bill. Students who arrive late, don't show for appointments, or cancel their appointments at the last minute prevent other students from being seen. Students must cancel their appointment prior to the scheduled time to avoid being charged the No Show fee. Students can call 608.785.8558 and select Option 1 (day or night) to cancel an appointment. Services offered by the Student Health Center are a valuable resource to all students.

Student Life

www.uwlax.edu/student-life | 149 Graff Main Hall | 608.785.8062

What matters most in the Student Life Office is student success.

The University of Wisconsin-La Crosse is committed to its belief in *mens corpusque* (“mind and body”) and seeks to provide a student-centered education in environments that are safe, diverse, equitable, inclusive and engaging. Our purpose in the Student Life Office is to support and encourage students’ growth and well-being in ways that enable them to thrive. We strive to empower students to share responsibility in the learning process and to create a positive learning community. Our vision is that students will participate actively in this process, uninhibited by ability, culture, gender, race, sexuality, religion or socio-economic barriers. We imagine students becoming self-determined individuals and well-informed citizens who are caring and compassionate for others and themselves.

The Student Life Office challenges students through individual and group interventions, and we support them by offering innovative programs and opportunities. Our outreach includes wellness programming, alcohol and drug education, policy and safety awareness, violence prevention, and other activities that support student transitions to and through the university. We recognize that collaboration is important to students’ success and we aim to work closely with faculty, staff, and families to ensure our work is mindful, supportive and current.

OUR SERVICES:

Advising and student referral, Campus Assessment Response And Evaluation (CARE) Team, communication, support, and assistance to faculty concerning student absences and other student issues, conflict resolution services, investigation of student complaints and grievances, legal services, response to incidents against students concerning harassment, support services for returning adult students, violence prevention services, Wellness Resource Center, and withdrawals from the university.

VIOLENCE PREVENTION

www.uwlax.edu/violence-prevention
bmccoonaughey@uwlax.edu

*Help for Sexual Assault, Relationship
Violence, and Stalking*

UWL recognizes that violence in any form interferes with the work and learning taking place in our community. Often, someone who experiences a sexual assault, violence or abuse in a relationship, or stalking may find that they have difficulty focusing on work or on their studies. Violence Prevention is here to assist you with advocacy, information, and support, so that you can make informed choices about the options available to you in these situations. Services are free, confidential, and available to all UWL students, faculty, and staff members.

UWL Violence Prevention provides:

- Referrals to resources, such as: counseling, medical care, legal help, and academic or financial assistance
- Safety planning
- Information on reporting options (University conduct and/or police), campus policies and procedures, and victim rights (Please note: You are not required to report an assault in order to get help)
- Assistance with applying for a restraining order
- Advocacy and support during interviews and hearings

STUDENT ADVOCACY AND EMPOWERMENT

www.uwlax.edu/student-life

While at UWL, students may experience distressing situations, including: physical and mental health concerns, academic concerns, relationship issues, or homesickness. The Student Life Office offers services to advocate and empower students through difficult situations. Services include: advising and referral support, absence notifications to faculty for emergency situations, bridging students to the many campus/community resources, student complaint and grievances, and consultation regarding withdrawing from the university. We are a great first stop when you have questions. When you don’t know where to go, go to the Student Life Office and we’ll help you thrive at UWL!

Student Life

www.uwlax.edu/student-life | 149 Graff Main Hall | 608.785.8062

STUDENT CONDUCT

www.uwlax.edu/student-life

The student conduct process is designed to address the student's relationship to the institution and its behavioral standards and policies. Our process is grounded in education and development and practices fundamental fairness to all involved. The student conduct process focuses on assessing the impacts of an individual's behavior on the learning environment of others and facilitating student growth, learning, and development. Our philosophy is guided by the notion that mistakes made can be invaluable learning opportunities for students. It is our goal with the student conduct process that we cultivate a safe community for all students, staff, faculty, and guests at UW-La Crosse.

WELLNESS AND HEALTH ADVOCACY

www.uwlax.edu/wellness

wellness@uwlax.edu | Instagram: @UWLpeerhealth

The goal of Wellness and Health Advocacy is to support and engage with our students and campus community by providing relevant health education and programming. We promote health across several areas of wellness, including: physical health, mental health, sexual health, alcohol and other drug use, and social health.

Our office, including our student Peer Health Advocates, work to provide honest and straight-forward information to our students so you all can make healthy and informed choices. You can find us in residence halls, tabling at the Union, on social media, in Graff Main Hall, and all over campus! If you have questions, please do not hesitate to contact our office!

Intercollegiate Athletics

www.uwlathletics.com | 126 Mitchell Hall | 608.785.8616

Athletics are an important and exciting part of campus and community life at the University of Wisconsin-La Crosse. Whether you are a participant or a spectator, UW-La Crosse teams provide plenty of action for everyone. Few institutions can match the success of the Eagles' nationally recognized NCAA Division III non-scholarship athletic program.

UW-La Crosse sponsors 21 intercollegiate sports, 12 for women and nine for men. Women's golf and women's lacrosse were added as varsity sports with golf starting play in Fall 2018 and lacrosse in Spring 2020. UW-La Crosse competes in the Wisconsin Intercollegiate Athletic Conference (WIAC), recognized as one of the most competitive Division III conferences in the nation. UW-La Crosse holds national membership affiliations in the National Collegiate Athletic Association (NCAA) and the National Collegiate Gymnastics Association (NCGA).

The Eagles have won 423 conference titles and 73 national titles in ten different sports. Historically, the Eagles rank second in the number of national titles, as compared to all other Division III schools. Athletic teams practice and compete in outstanding facilities, including Cartwright Center (gymnastics and wrestling), Mitchell Hall (gymnastics, swimming & diving, men's and women's basketball, volleyball, wrestling, men's and women's indoor track and field) and Roger Harring Stadium at Veterans Memorial Field Sports

Complex (football, soccer, lacrosse, and men's & women's outdoor track and field). The softball team practices and competes at the newly renovated North Campus Softball Complex, while the baseball team competes at beautiful Copeland Park in La Crosse. The men's and women's cross country teams host an annual invitational at Maple Grove Venues, LLC in West Salem. The men's and women's tennis teams practice and compete at Green Island Tennis Park in La Crosse. The golf team practices and competes at Forest Hills Golf Course in La Crosse and The Golf Club at Cedar Creek in Onalaska. The Student Fieldhouse officially opened in the 2023 spring semester. The 144,000 square-foot facility, located east of Roger Harring Stadium, includes a 200-meter NCAA competition indoor track, all-sport surface infield, walking and jogging track on the second level and space for 1,500 spectators. It also features women's and men's team locker rooms, space for team meetings, an office suite, and equipment storage.

All UW-La Crosse students can attend all regular-season home athletic events at no extra cost.

Keep updated with the Intercollegiate Athletics Department at www.uwlathletics.com. Be sure to follow the Eagles on Facebook (@UWLaCrosseAthletics), Twitter (@UWLathletics) and Instagram (uwlathletics).

21

**NCAA DIVISION III
ATHLETIC TEAMS**

432

**CONFERENCE
TITLES**

73

**NATIONAL
CHAMPIONSHIPS**

New Student & Family Programs

www.uwlax.edu/new-student-and-family | 2320 Student Union | 608.785.8055

The New Student and Family Programs Office assists all new students and their families as they transition into successful college students. We build partnerships with students, parents, and families through communication, programming, and resources. Together, let's get ready to reach new heights! We host New Student Orientation, Welcome Week, Family Weekends, the Second Year Experience, and the Parent Advisory Board. You will also be receiving electronic issues of Eagle Mail, our New Student and Family newsletter, to keep you in the loop with UWL happenings! Don't forget to look out for us on Facebook at www.facebook.com/uwlinsfp or Instagram @uwl_nsf!

NEW STUDENT ORIENTATION (AUGUST 31 & SEPTEMBER 1-4)

New Student Orientation is for all new students to UWL and offers a variety of programs, services, activities, and fun events designed to welcome and introduce students to all of the engagement opportunities at UWL. All new first-year students are included into an Eagle Group, which is led by an Eagle Guide who is an experienced UWL student leader. New students will be "guided" through their first few days on campus by our student "experts." Through New Student Orientation, there are plenty of opportunities to meet other new and returning students, find out ways to get involved, and prepare for the academic year!

WELCOME WEEK (SEPTEMBER 5-17)

Welcome Week is our celebration of new students! This week's events help students feel comfortable in their new campus environment, learn information you need for your time at UWL, and participate in activities with other students, staff, and community members.

FAMILY WEEKEND (OCTOBER 20-22)

We are excited to see you on-campus and have the opportunity to explore the La Crosse area! Hotel blocks are listed on our website.

SECOND YEAR EXPERIENCE

The Second Year Experience Program assists second-year students in exploring the critical issues and tasks that are unique to the second year of college. The program provides support for second-year students by connecting them to peers, faculty, staff, and campus resources, enhancing their academic and professional success. The program also helps to build a community of support outside of the classroom, aiding in their self-exploration, exposing them to diverse perspectives, and helping define academic and co-curricular goals.

PARENTS & FAMILIES

As a parent/guardian you have the opportunity to apply to be a part of the Parent Advisory Board or serve as a Parent Ambassador. The University of Wisconsin-La Crosse Parent Advisory Board is a group of current parents who are committed to investing in UWL and its future by serving in an advisory capacity as we prepare our students for lifelong success. Members of the Parent Advisory Board serve in a leadership role through participation and service. The University of Wisconsin-La Crosse Parent Ambassadors have the opportunity to volunteer at events for their fellow parents as well as for newly admitted students/families. Through your active engagement, you are making a direct impact on your student's experience at UWL.

Off-Campus Faith Communities

ASSEMBLY OF GOD

New Beginnings Christian Fellowship - 608.782.8030
122 5th Avenue N, La Crosse

BAPTIST

Faith Baptist Church (Independent) - 608.788.1165
3615 S 28th Street, La Crosse

First Baptist Church (ABC/USA) - 608.782.6553
1209 Main Street, La Crosse

Temple Baptist Church (Independent) - 608.781.2878
1326 N Salem Road, La Crosse

BUDDHIST

Diamond Way Buddhist Center - 608.620.4836
507 Main Street, La Crosse

CATHOLIC

Blessed Sacrament Catholic Church - 608.782.2953
130 Losey Boulevard S, La Crosse

Holy Trinity Catholic Church - 608.782.2028
1333 13th Street S, La Crosse

Mary, Mother of the Church Parish - 608.788.5483
2006 Weston Street, La Crosse

Roncalli Newman Catholic Parish - 608.784.4994
1732 State Street, La Crosse

EASTERN ORTHODOX

St. Elias Orthodox Church - 608.782.8641
716 Copeland Avenue, La Crosse

EPISCOPAL

Christ Episcopal Church - 608.784.0697
111 9th Street N, La Crosse

EVANGELICAL FREE

First Free Church - 608.782.6022
123 Mason Street, Onalaska

Bethany Free Church - 608.781.2466
3936 County Road B, La Crosse

HMONG

Hmong Faith Alliance Church - 608.784.8711
2127 Pine Street, La Crosse

ISLAM

Othman bin Affan Masjid - 608.784.7167
206 Rose Street, La Crosse

JEWISH

Congregation Sons of Abraham - 608.784.2708
1820 Main Street, La Crosse

LUTHERAN

English Lutheran Church (ELCA) - 608.784.9335
1509 King Street, La Crosse

First Lutheran Church (WELS) - 608.784.3867
400 West Avenue S, La Crosse

Our Savior's Lutheran Church - 608.784.3468
612 Division Street, La Crosse

METHODIST

Bridges United Methodist Church - 608.782.3018
310 4th Street S, La Crosse

Faith United Methodist Church - 608.782.2526
1818 Redfield Street, La Crosse

NONDENOMINATIONAL

Living Word Christian Church - 608.787.5922
2015 Ward Avenue, La Crosse

PRESBYTERIAN

First Presbyterian Church - 608.784.4248
233 West Avenue S, La Crosse

SEVENTH DAY ADVENTIST

Seventh Day Adventist Church - 608.782.4038
2117 La Crosse Street, La Crosse

UNITED CHURCH OF CHRIST

First Congregational Church (UCC) - 608.784.8137
2503 Main Street, La Crosse

St John's United Church of Christ - 608.784.3314
630 West Avenue S, La Crosse

UNITARIAN

Unitarian Universalist Fellowship of La Crosse - 608.796.9993
401 West Avenue, La Crosse

Recreational Sports

www.uwlax.edu/recsports | 608.785.5225

UWL students study hard, work hard, and play hard. Once you put down your books, check out the Rec Sports Department! We have programs and facilities designed to help you stay active, meet new friends, and reduce your stress levels. So let's play!

RECREATIONAL EAGLE CENTER (REC)

Looking for a court to play your three-on-three game or how about an indoor track for those cold winter months? With over 133,000 square feet of activity space, the Recreational Eagle Center (REC) offers numerous spaces to meet all of your indoor sport and fitness needs. Spaces include the Fitness Center, courts of all varieties (racquetball, multi-activity & basketball), and houses most of the programs & services you read about below.

OUTDOOR CONNECTION TRIPS & GEAR RENTAL

With rugged bluffs, scenic valleys, and the majestic Mississippi flowing through, the La Crosse area has many opportunities for you to begin your first or next outdoor adventure. Outdoor Connection offers outdoor trips to locations near and far to match any skill level. No experience is necessary! Planning your own adventure? Outdoor Connection offers low-cost outdoor gear rental. Whether its inline skates, ice skates, bikes or an hammock to use around town, or tents, sleeping bags, backpacks, or paddling equipment, Outdoor Connection has you covered!

GROUP FITNESS CLASSES

Rec Sports offers a variety of exercise classes for all types of interests, fitness levels and schedules. Offering everything from kickboxing and Zumba™, to cycling and yoga, the group fitness offers it all for a low supplemental fee of \$40 per semester.

INTRAMURAL SPORTS

The Intramural Sports Program is one of the most popular extracurricular activities on campus. The program provides a great way to meet new people and continue playing the sports you have grown to love. Intramurals offers team, dual, and individual sport leagues where participants compete for the coveted intramural champion t-shirt. You can create your own team or utilize the free agent list. The Rec Sports staff form the leagues, supervise play, monitor and track league standings, and organize tournaments; all you have to do is be a good sport and have a great time.

SPECIAL EVENTS

Rec Sports offers a variety of unique recreation/sport events throughout the year. There is something for everyone and activities include: tournaments, skill competitions, road races, and mini festivals held in the REC. Try new activities, win prizes, meet new friends, and have a blast with us!

CLIMBING WALL

The sport of rock climbing is a great alternative to traditional exercise. It develops strength, improves endurance and increases self-confidence! Whether you are a beginner or experienced climber, the REC's climbing wall has something for you! This state-of-the-art facility simulates a variety of rock formations and utilizes hundreds of moveable hand and foot holds to provide participants a fun mental and physical challenge. All essential climbing gear is available to UWL students at no charge (includes: harnesses, belay devices, climbing ropes, and shoes).

Recreational Sports

www.uwlax.edu/recsports | 608.785.5225

FITNESS CENTER

Come on into the Fitness Center for a great workout. This state of the art facility is over 13,000 square feet complete with cardio and strength equipment for all of your workout needs. Also, inside you will find 25 yards of turf for agility workouts or just a place to stretch. You will also find cardio and weight equipment on the track. Trained staff will be here for you to ensure your safety, introduce you to new equipment, and to discuss your training methods.

Take advantage of our certified personal trainers and variety of training programs we offer to get in the best shape of your life. Our excellent personal training staff will guide you to improve your training effectiveness by educating you on proper technique and training methods.

MITCHELL HALL POOL

Mitchell Hall's pool is a 6 lane, 25-yard competitive pool that is used for a variety of activities including open lap swim, classes and competitive collegiate swim meets. Current faculty, staff and students just need to bring their current UWL ID with them to gain access to the open lap swim hours.

EZONE ESPORTS & GAMING

Newly opened in 2022, the EZONE offers gaming for both casual and competitive gamers on 24 high-end gaming PCs and on Xbox, PlayStation and Nintendo Switch gaming consoles. Come meet new friends, or play against your friends on campus or around the world. The space also includes a viewing area and a shout casting room for streaming on Twitch. Whether you are new to gaming or a top ranked competitive online gamer, the EZONE has a game for you!

EMPLOYMENT

The Recreational Sports Department employs over 200 students per year. It truly is a program for the students by the students. Positions available include lifeguards, fitness instructors, officials, building managers, competitive sports supervisors, customer service representatives, event supervisors, outdoor connection staff, climbing wall staff, fitness center supervisors, graphic designers, and EZONE representatives.

MEMBERSHIPS

Current UWL students are members of the Recreational Eagle Center and may purchase a membership for their spouse/partner at a discounted rate.

SPORT CLUBS

Travel, camaraderie, and good times are a few hallmarks of the UWL Sport Club Program. Sport Clubs provide support and leadership to sport and recreation oriented student organizations. Each club is organized and led by students, for students.

Our sport clubs include:

- Archery
- Baseball
- Basketball (W)
- Bowling
- Boxing
- Equestrian
- Fishing
- Hockey
- Lacrosse
- Rugby
- Soccer
- Table Tennis
- Triathlon
- Volleyball
- Ultimate Frisbee
- Waterski & Wakeboard
- Weightlifting

The Arts

The “**EXPERIENCE for a lifetime**” is available for all students through participation in the arts. Students enjoy a wide range of arts activities through the classroom/studio setting and through opportunities to perform, design, or exhibit in a wide range of venues.

ART

608.785.8230

105 Lowe Center for the Arts

The Department of Art provides an educational environment that encourages intellectual development, visual literacy, and artistic production. Students are encouraged to develop their own artistic vision as artists and to engage in meaningful creative endeavors, studio practice, research, and outreach in the visual arts.

Large studio areas are furnished with a mix of new and traditional equipment for ceramics, drawing, metals, blacksmith, painting, photography, printmaking, and sculpture. A drawing studio, art education studio, design studio, and two Macintosh computer labs complete the laboratory areas.

The University Gallery schedules art exhibits by students, faculty, and regional and nationally known artists. Go to www.uwlax.edu/art for more information about the Art Department and www.uwlax.edu/art/university-gallery to view the University Gallery website.

MUSIC

608.785.8409

234 Lowe Center for the Arts

The Department of Music is the musical core for the University of Wisconsin-La Crosse. Our mission is to provide diverse musical experiences for our music majors and minors, all UWL students, and the greater La Crosse community. The music department provides a strong foundation for its degree programs through quality courses in music history, theory, applied music lessons, and ensemble experiences. Whether you want to teach, perform, or prepare yourself for further music study, take the first and most important step toward a fulfilling life in music with us.

If music is an extracurricular passion or creative outlet, students will find many opportunities in a friendly, professional atmosphere. Any student, regardless of major, is invited to join any of our musical groups, including: choirs, jazz ensembles, Screaming Eagles Marching Band, wind ensemble and non-auditioned concert bands, and orchestra. Other opportunities include chamber music groups, jazz combo, and contemporary/jazz vocal ensemble. Students should register for these ensembles (one credit each) at the same time as other academic classes. Ensemble audition material, if required, is posted in August and auditions occur the weekend prior to the first week of classes

To learn more, visit www.uwlax.edu/music and find us on Facebook and YouTube by searching **UW-La Crosse Music**.

THEATRE AND DANCE

608.785.6701

154 Lowe Center for the Arts

The Department of Theatre & Dance at UWL is an innovative and challenging theatre arts program. The Theatre & Dance program strives to provide students with the tools necessary to function as complete artists and self-realized individuals, combining theatrical training with a strong liberal arts curriculum. Theatre & Dance students experience all aspects of theatrical production while giving them the opportunity to receive advanced undergraduate training in performance, musical theatre, arts administration, theatre management, design/technical (sound, lights, costume, scenic, etc.), or general theatre studies and dance (minor only).

All UWL students are invited to participate in any productions. Whether or not you are experienced in theatre and dance, we welcome your involvement. Students work with both faculty and guest directors, designers, and choreographers on a wide variety of theatrical offerings. Opportunities to become involved are announced across campus, or you can contact the theatre department for information.

2023-2024 IMPORTANT DATES

Major/Minor/All Interested Meeting

- Tuesday, September 5 at 5:20 p.m. in Toland Theatre, Lowe Center for the Arts.

Auditions for Fall 2023 Theatre & Dance Productions

- Tuesday, September 5 at 6 p.m.
Callbacks on September 6 & 7. Lobby of Lowe Center for the Arts.

Dates for additional auditions, productions, meetings, and more, will be posted on the Theatre & Dance website. For more information, please contact us at 608.785.6701 or visit our website.

University Centers

www.uwlax.edu/uc | 3200 Student Union | 608.785.8888

ACTIVITIES

THE COVE

608.785.8866

2200 Student Union

The COVE - Center for Organizations, Vision, & Engagement is the Student Organization suite located in 2200 Student Union. The COVE is a space for all Student Organizations to come together to share ideas, collaborate, and find resources, specifically for Student Organizations. It physically houses: Campus Activities Board, COVE Graphics Garage, Leadership & Involvement Center, Green Fund, Fraternity and Sorority Life, designated Multicultural Student Organizations, the Pride Center, Student Association, and the Racquet Press. The "front porches" in each of the spaces are an extension of the organization's office space, giving students the opportunity to interact with others in a relaxed setting. Although some porches are open for any student to sit in, students are asked to respect these spaces and be mindful that organizations use this space for meetings and gatherings. Public computers and workspaces, two conference rooms, as well as a variety of graphics supplies are also available for use within The COVE.

The COVE is also home to the Campus Food Pantry, a free service provided to all faculty, staff, and students. Interested users should visit MyOrgs to register for access to the pantry or complete the registration form online. MyOrgs also provides resources regarding Publicity Guidelines, Cash Boxes, Flyers & Posters, Fundraising Registration Forms, Event Funding Assistance, Trademark & Licensing Artwork Approval Form (t-shirt/apparel printing), and information on starting a

Recognized Student Organization. The two student-staffed groups that operate out of the COVE are the COVE Graphics Garage and the Leadership & Involvement Center.

1. The **COVE Graphics Garage** provides resources and opportunities not only for Recognized Student Organizations, but for all UWL students and staff. The COVE Graphics Garage offers free graphic design services and low-cost printing and laminating for a variety of projects.
2. The **Leadership & Involvement Center** offers a variety of leadership, involvement, and service opportunities for students, including support of the Ugetconnected volunteer portal and MyOrgs Student Organization database.

CAMPUS ACTIVITIES BOARD (CAB)

608.785.8873

2246, The COVE, Student Union

www.uwlax.edu/cab

CAB is a student-run programming board that provides cultural, educational, and entertaining activities for the entire campus community. Events, such as small and large concerts, comedians, craft nights, bingo, game nights, and special events are offered! CAB also provides free weekly movies in the Student Union Theater.

STUDENT ORGANIZATIONS/MYORGS

608.785.8866

2200, The COVE, Student Union

orgs.uwlax.edu

Student activities and involvement contribute greatly to the student's overall educational experience. Co-curricular involvement provides opportunities outside the classroom for students to gain meaningful life skills. The sooner

new students become established on campus, the better they will feel about classes and about themselves. Joining a recognized Student Organization is one of the easiest ways to make friends and ease the transition into college. Staff in the COVE provide daily assistance to over 200 Recognized Student Organizations in areas such as: program planning and implementation, fund raising, publicity, leadership development, and financial assistance with student organization grants.

MyOrgs provides students with online convenience for managing and tracking recognized Student Organizations, leadership, and co-curricular participation. Students can log on to the MyOrgs site, review current recognized Student Organizations, and express interest in joining an organization! Existing club members can recruit new members, track service/volunteer work hours, create news articles, post event information, create elections, and more.

SUSTAINABILITY

2255D Student Union

www.uwlax.edu/sustainability

Through education, engagement and action, UWL works to advance environmental sustainability on campus and build a campus culture of environmental responsibility. There are various ways for students to engage and further these efforts, including utilizing the Green Fund, which is a student funded entity that provides grant money to fund sustainability programs and projects across campus. Stop by our offices in the COVE to learn more about the progress being made on campus and ways you can help out.

University Centers

www.uwlax.edu/uc | 3200 Student Union | 608.785.8888

PRIDE CENTER

2216, The COVE, Student Union
www.uwlax.edu/pridecenter

The Pride Center provides support, education, outreach, advocacy, and resources for UW-La Crosse LGBTQIA+ students, faculty, staff, and their allies. We work collaboratively to improve the campus climate and to foster a sense of belonging for all LGBTQ+ students, faculty, and staff. The Pride Center includes three Peer Educators, a Graduate Student, and a full-time Director. Their roles are to assist students, faculty, and staff. Through the Pride Center's ally workshops, trainings, student-led panels, Rainbow Unity and Transfrom student organizations, we work to create an inclusive environment where all individuals can be their most authentic selves. Within the Pride Center is the Relaxation Room that students are welcome to use this room whenever the Pride Center is open.

THE SAFE SPACE

The COVE, Student Union

The Safe Space is designed to provide LGBTQIAAAP+2S students, faculty, and staff a location on campus where they feel welcome and supported.

FRATERNITY & SORORITY LIFE

608.785.8870

The COVE, Student Union
fraternities@uwlax.edu
sororities@uwlax.edu

www.uwlax.edu/university-centers/orgs/fraternities-sororities/welcome

Membership in a fraternal organization can be an enriching experience. The Fraternity & Sorority Life community is rooted in the four pillars of: brotherhood/sisterhood, leadership, service, and academic development. Members of the community engage in a variety of different

areas of campus and the wider La Crosse community that provide unique and enriching experiences for the members. Through their participation, members learn how to better the world around themselves by living value-driven lives. Currently, there are three national social sororities on campus: Alpha Phi (ΑΦ), Alpha Xi Delta (ΑΞΔ), and Sigma Sigma Sigma (ΣΣΣ). Additionally, there are two national social fraternities on campus: Delta Sigma Phi (ΔΣΦ) and Sigma Tau Gamma (ΣΤΓ).

FACILITY OPERATIONS

Student Union Facility Operations provides a broad range of services to support the academic mission and leisure needs of UW-La Crosse students.

INFORMATION CENTER & TICKET OFFICE

608.785.8877

First Floor, Student Union
www.uwlax.edu/university-centers/event/ticket-information

The Information Center is a service center for all students and guests. Student staff assist with questions regarding the Student Union and the campus. Tickets for many events hosted by Campus Activities Board and recognized Student Organizations along with MTU bus passes are available for purchase at the Information Center. Other services provided are PLAY area equipment and lawn games check out, lost and found, and pay for print station.

COMPUTERS

2200, The COVE, Student Union

Four computers for general student use are available in the COVE on the second floor in the Eagles Nest Lounge. The computers are available whenever the COVE is open. A pay for print station is also located near the computers in the COVE.

UNIVERSITY RESERVATIONS & AUDIO VISUAL LIGHTING SUPPORT (AVLS)

608.785.8895 (Reservations)
3200 Student Union
608.785.8871 (Event Support)
www.uwlax.edu/reservations

University Reservations and Audio, Visual & Lighting Support (AVLS) assists the university community by coordinating reservations, offering information for event planning, and serving as a liaison with the university. The Reservations Office offers assistance for events and meetings occurring in the Student Union. In addition, they can assist with scheduling classrooms (when classes are not scheduled), and outdoor events. AVLS consists of experienced technicians who help Student Organizations develop and produce events of all sizes. Staff are trained to assist with anything from playing background music for an event to providing full concert production support.

UNIVERSITY DINING SERVICES

DINING SERVICES

608.785.8891
1131 Student Union
<https://www.uwlax.edu/university-centers/services/dining-services/dining-plans/>

University Dining Services are administered through the University Centers Office and are provided by a contracted dining service company, Chartwells. University personnel work cooperatively to ensure compliance with the contract and to assist in providing quality dining services to the students.

University Centers

www.uwlax.edu/uc | 3200 Student Union | 608.785.8888

DINING PLANS

On Campus Plans

All students living in a residence hall are required to participate in the Dining Plan Program. Students may choose from either The Stryker Classic Plan or The Stryker Deluxe Plan. The Stryker Classic Plan has 19 meals per week and \$115.00 Dining Dollars. The Stryker Deluxe Plan has 21 meals per week, \$150.00 Dining Dollars, and 30 Block Meals. Students select their dining plan when they complete their housing application.

Meals for the week start/reset on Friday at breakfast and go until Thursday at 11:59pm. Unused meals do not roll over from week to week and will be lost if they are not used.

The dining plans allow students to use their meals in Whitney Center (Main Dining Room and Badger Street Station) and two meals per day at designated dining venues in the Student Union, all of which are deducted from the 19 or 21 meals per week.

Students living in Reuter Hall have the additional option of The Reuter Plan, which has \$115.00 Dining Dollars and 45 Block Meals.

All On Campus Dining Plans expire at the end of the day, on the last day of finals each semester. Any unused Dining Dollars, Meal Swipes or Block Meals will be lost. Meal plans reset for spring semester and will start with dinner the Saturday before classes start.

Off Campus Plans

Students living off campus are not required to purchase a dining plan. We offer the Talon Block Plan which comes with 60, 40, or 20 Block Meals. If you purchase 60 Block Meals, you receive an additional four Blocks for free. If you purchase 40 Block Meals, you receive an additional two Blocks for free.

Talon Dining Plans roll over from semester to semester and expire on the last day of summer term 2024.

Talon Block Plans can be purchased in the Card Office or online through GET Mobile.

Students living off campus can purchase an On-Campus Dining Plan if they would like. These plans expire at the end of the semester and can be purchased at the Card Office.

Information for all Dining Plans

Dining Dollars are a part of all On-Campus Dining Plans, they are accepted at all dining locations to purchase food items.

Blocks are pre-set meals that are available at every dining location on campus. They are part of the Stryker Deluxe, The Reuter, and The Talon Dining Plans. At Whitney Main Dining a block meal will be an entry into the dining room, and it is all you care to eat. All other dining locations on campus will have a Block Menu posted.

Students are required to have their Eagle ID card or digital ID with them to access their dining plan.

WHITNEY CENTER DINING AREAS

608.785.8610

www.uwlaxdining.com

Whitney Center is the primary dining facility on campus, serving residential students. When eating in Whitney Center, students may use either The Stryker Plans, The Reuter Plan, Block Meals, Dining Dollars, Campus Cash, cash, or debit/credit cards. The dining areas located in Whitney Center are:

Main Dining Room

This venue offers a variety of dining options. Breakfast features a variety of egg choices, breakfast meat, hot cereal, pancakes and waffles, bagels and muffins, and fresh fruit.

At lunch and dinner, students can choose from a variety of comfort foods, vegetables, hot entrees, pasta, pizza, soups, made-to-order deli sandwiches and an extensive salad bar. Vegetarian and vegan, entrees and sides are also available at every meal. Items such as pastries, cookies and desserts are offered daily at the bakery station. You will also find a variety of cereals, yogurt & mix-ins, ice cream, condiments, and beverages available throughout the day.

Badger Street Station

Badger Street Station hosts several popular venues: The Convenience Store, the Sub Shop, and the On-The-Go program. Meal swipes and Block Meals can be used to purchase subs or an On-The-Go meal. Additionally, any items found in this area can be purchased with Dining Dollars, Campus Cash, debit/credit cards, or cash. When eating at the Sub Shop, students receive a sub of choice, chips or a piece of fruit, and a beverage. For convenience, we have a variety of grab-and-go options, such as premade sandwiches, hot and cold breakfast, and snack packs.

University Centers

www.uwlax.edu/uc | 3200 Student Union | 608.785.8888

STUDENT UNION DINING AREAS

When eating in the Student Union, students may use Block Meals, Dining Dollars, Campus Cash, cash or debit/credit cards. Students on any of the Stryker Dining Plans may use up to two meal swipes a day in the designated venue(s) in the Student Union. The dining areas located in the Student Union are:

Erbert & Gerbert's Sandwich Shop (subs, wraps, soup, chips, and beverages); **Grilled It!** (chicken tenders, chicken & vegan burgers, French fries, etc.); **Sono** (tacos, quesadillas, and burritos), **Hisso Sushi, Kitchen Classics** (Sandwich of the Day), and the **Stryker's Café** (breakfast and sandwich of the day). Vegan and vegetarian options are available in each concept.

Einstein Bros. Bagels offers a variety of bagels and shmears and egg sandwiches for breakfast. Throughout the remainder of the day, the menu includes a variety of bagels, bagel sandwiches, fruit cups, and bakery selections. Coffee and bottled beverages are also available. Adjacent to Einstein's is the On-The Go area which features Hisso Sushi, Jack & Olive pre-made sandwiches and salads, snacks, and beverages.

MURPHY'S MUG

First Floor, Murphy Library
Serving Caribou Coffee, Murphy's Mug offers a variety of coffees, lattes, cappuccinos, and teas. Additionally, this area offers the On-The-Go concept, which features a variety of Jack & Olive pre-made sandwiches and salads, sides, bakery items, and bottled beverages.

CENTENNIAL HALL

First Floor, Centennial Hall
Featuring Starbucks Coffee, this area features a variety of coffees, lattes, Frappuccino's, and espressos. Additionally, it hosts an On-The-Go concept which offers a variety of bakery items, Jack & Olive sandwiches and salads, soup, and bottled beverages.

FOOD ALLERGIES AND SPECIAL DIETS

FOOD ALLERGIES AND SPECIAL DIETS

We can work with students who have food allergies or need to follow special diets. Please contact Jessica Harke (dietitian) at jharke@uwlax.edu or 608.785.6480 to discuss your dietary needs.

UNIVERSITY IDENTIFICATION CARDS: EAGLE ID OFFICE

EAGLE ID CARD OFFICE

608.785.8891
1131 Student Union
uwlcardoffice@uwlax.edu

The Eagle ID Card serves as the official University of Wisconsin-La Crosse form of identification. For students, this card is valid during all terms they are enrolled. Upon request, ID cards must be presented to university officials. Students will receive their card when they arrive on campus.

NOTE: ID cards may not be shared with any other person. Students must always carry their ID card with them, as they are required for university services.

University Centers

www.uwlax.edu/uc | 3200 Student Union | 608.785.8888

WAYS TO USE THE EAGLE ID CARD

- **The Official ID** – The Eagle ID card provides access to residence halls, computer labs, Dining Services, Health Center services, Strength Centers, the Recreational Eagle Center, (REC takes both virtual and physical student IDs, download the UWL REC app to get their virtual ID), Textbook Services, Library Services and Vending Machines. It also serves as a bus pass for transportation on the city bus system. Students must have their ID card with them to access these services.
- **Campus Cash** – Campus Cash is an internal university prepaid debit account that offers the advantage of convenience, security and accountability while minimizing the need to carry cash on campus. Campus Cash may be used at all campus dining locations, the UWL Bookstore, Textbook Services, the Badger Street Station Convenience Store, the Recreational Eagle Center, residence hall laundry machines (only accept Campus Cash), pay-for-print, beverage and snack vending machines and Pepsi machines on campus. Campus Cash carries over from semester to semester.
- **Get Mobile** – GET Mobile is an application available to everyone at UWL and it allows you to do the following:
 - Upload an ID Photo
 - Purchase Campus Cash
 - Purchase Block Meal Plans
 - Check your account balances for Campus Cash, Dining Dollars, meal swipes, and blocks
 - Use digital ID for Dining Locations

The GET Mobile app is available for download in both the App Store & Google Play Store.

- **Wisconsin Voter ID** – Your Eagle ID may be used as an official ID document when voting in Wisconsin. Please be sure to sign the back of your card if you intend to use it for this purpose (Note: the expiration date on your card is for voting purposes only). For more information, visit the Wisconsin Election Commission website.

REPORT AND REPLACE A LOST EAGLE ID

There are two options to report a lost card:

- Visit the GET Mobile website: www.uwlax.edu/University-Centers/eagle-id/get.cbord.com/uwlax.
- Visit the ID Card/Dining Office at 1131 Student Union to report a lost card and purchase a new Eagle ID Card.

Should you need to replace your original Eagle ID Card, the following charges apply:

- Replacement due to loss/theft - \$20.
- Replacement due to damage - \$10 (you will be asked to turn in the damaged card).

STUDENT UNION SERVICES

All Gender Restrooms
Audio Visual Lighting Support
Campus Cash
Catering Services
Commuter Student Lounge
Computers - the COVE
COVE Graphics Garage
Dining Opportunities
Dining Plans
Eagle ID Cards
Event Funding Assistance
Family Room
Food Pantry (the COVE)
Fraternity & Sorority Life (FSL)
Fundraiser Registration
Information Center
Laundry Refunds
Leadership & Involvement Center
MTU Bus Passes
Nametags
OZZI Tokens (for reusable food containers)
Pride Center/Safe Space
Print Stations
Publicity Registration
Recreation Equipment & Lawn Games Checkout
Student Association
Student Newspaper (Racquet Press)
Student Organization Resources
Theater
Ticket Sales
University Reservations/Event Support
UW Credit Union
Vending Machines
Vending Refunds
Veteran's Lounge



NORTH

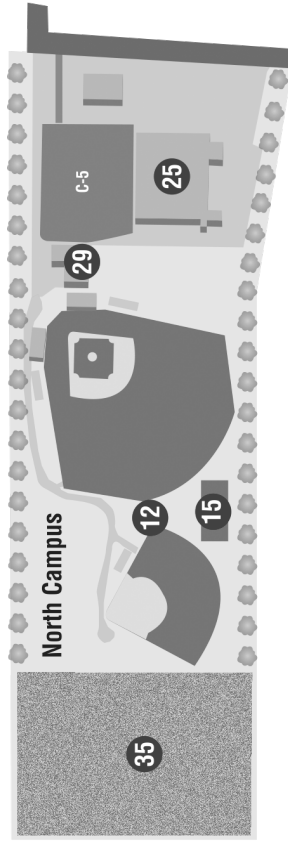

North Campus

UWL

UW-LA CROSSE

uw/lax.edu

1725 State St. | La Crosse, WI 54601

- Commuter Parking (C Lots)
- Resident Parking (R Lots)
- Motorcycle/Moped Parking
- Parking Pay Station

1/4 mile

EAST AVE.

To 90



- RESIDENCE HALLS**
- **1 Angell Hall - C2
 - **2 Coate Hall - D2
 - **3 Drake Hall - C3
 - *4 Eagle Hall - E3
 - **5 Hutchison Hall - C2
 - 6 Laux Hall - E6
 - *7 Reuter Hall - E6
 - **8 Sanford Hall - E6
 - *9 Wentz Hall - C3
 - **10 White Hall - D6
- OTHER FACILITIES**
- **11 Archeology Center - B5
 - 12 Baseball/Softball Fields - G3
 - *13 Cartwright Center - A5
 - *14 Centennial Hall - B4
 - 15 Challenge & Ropes Course - F3
 - *16 Child Care Center - D4
 - *17 Cleary Alumni & Friends Center - E5
 - *18 Cowley Hall - C5
 - *19 Fieldhouse - C7
 - *20 Graff Main Hall - A5
 - *21 Health Science Center - C1
 - 22 Heating Plant - B5
 - 23 Hoeschler Tower - B4
 - *24 Lowe Center for the Arts - B3
 - *25 Maintenance Building - G5
 - **26 Mitchell Hall - B6
 - *27 Morris Hall - A4
 - *28 Murphy Library - C4
 - *29 North Field Equipment Building - G4
 - *30 Parking Services - D5
 - Police Services - D5
 - *31 Prairie Springs Science Center - C5
 - *32 Recreational Eagle Center - D3
 - *33 Roger Harring Stadium at Veterans Memorial Field Sports Complex - C6
 - *34 Soccer/Lacrosse Building - E7
 - 35 Student Recreation Fields - G1
 - 36 Student Union - D5
 - 37 Veterans Memorial Field Sports Complex - D7
 - 38 Veterans Memorial Monument - C6
 - 39 West Campus Chiller Plant - C1
 - **40 Whitney Center - D2
 - *41 Wimberly Hall - D4
 - *42 Wing Technology Center - A4
 - *43 Wittich Hall - B5
- *Handicapped accessible
**Limited accessibility