



PROGRAMMING SESSION NO. 2 - BIOLOGY

January 25, 2021

Agenda

- **Report Out**
 - **Program Updates**
 - **Adjacencies**
- **Planning Opportunities**
 - **The Link**
 - **Departmental Space Organization**
- **Technology**

A group of four students (three women and one man) are smiling and posing for a selfie outdoors. They are wearing maroon and white striped jackets. The background features a large brick building with many windows and a grassy area. The image has a semi-transparent dark overlay.

WHAT WE HEARD

- PROGRAM UPDATES
- SUSTAINABILITY CHARETTE OUTCOMES

PROJECT VISION



STUDENT CENTERED

- Encourage faculty-student interaction
- Meet students on neutral ground
- Connect students to research



COLLABORATIVE

- Unite departments
- Facilitate variety of interactions
- Complement the research in Phase 1



FACE FORWARD

- De-mystify the sciences
- Celebrate the work
- Recruit and retain talent

PRAIRIE SPRING SCIENCE CENTER IN PHASES - UNITS

2017

- RIVER STUDIES CENTER
- RADIATION CENTER
- PHYSICS
- MISC. INSTR. / SUPPORT
- MICROBIOLOGY
- MATHEMATICS
- GEOGRAPHY & EARTH SCIENCE
- DEAN'S OFFICE
- CORE LABS
- CLASSROOMS
- CHEMISTRY
- BUILDING SUPPORT
- BIOLOGY

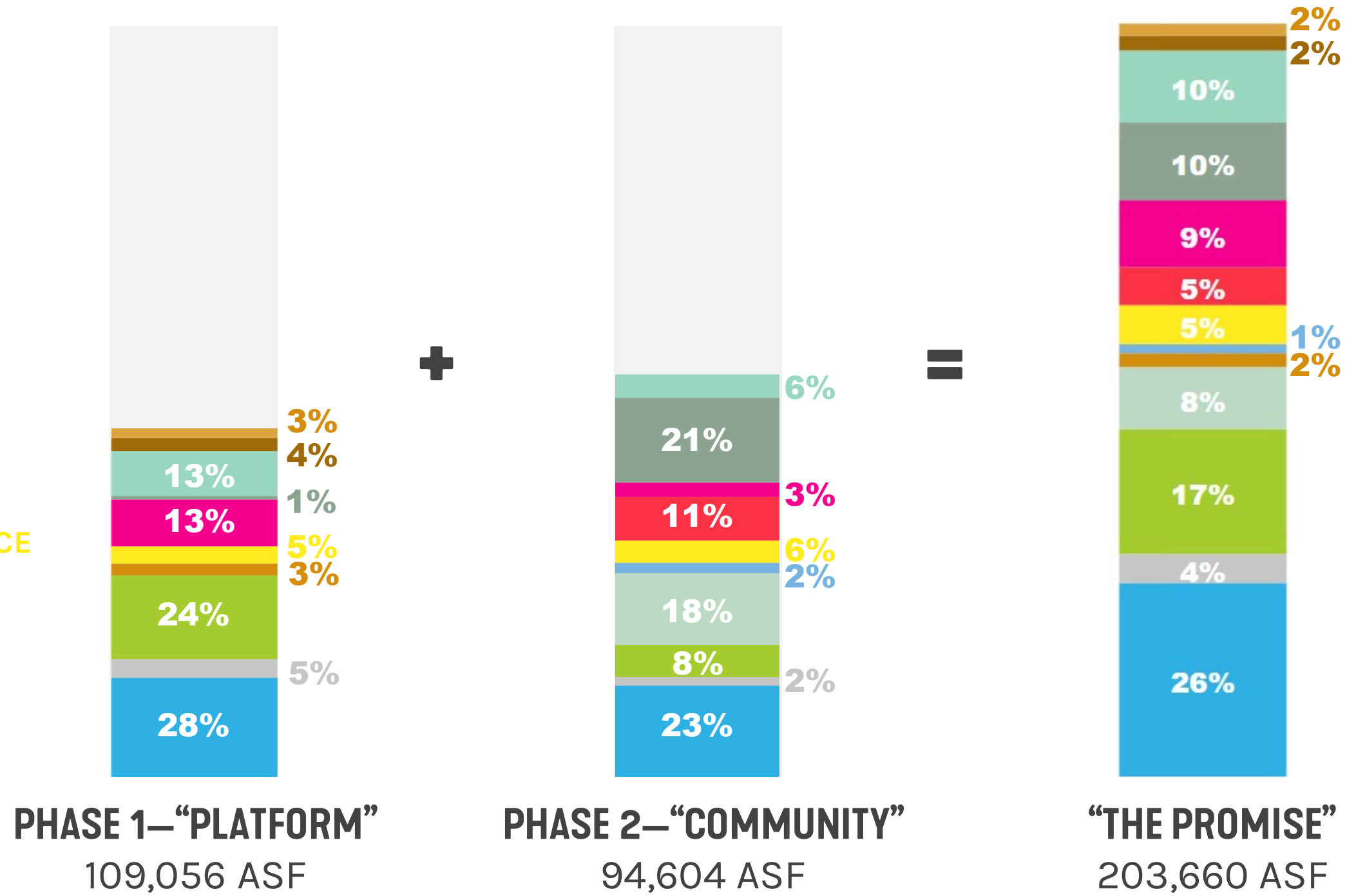

PRAIRIE SPRING SCIENCE CENTER IN PHASES - UNITS

2021 UPDATE

- RIVER STUDIES CENTER
- RADIATION CENTER
- PHYSICS
- MISC. INSTR. / SUPPORT
- MICROBIOLOGY
- MATHEMATICS
- GEOGRAPHY & EARTH SCIENCE
- DEAN'S OFFICE
- CORE LABS
- CLASSROOMS
- CHEMISTRY
- BUILDING SUPPORT
- BIOLOGY

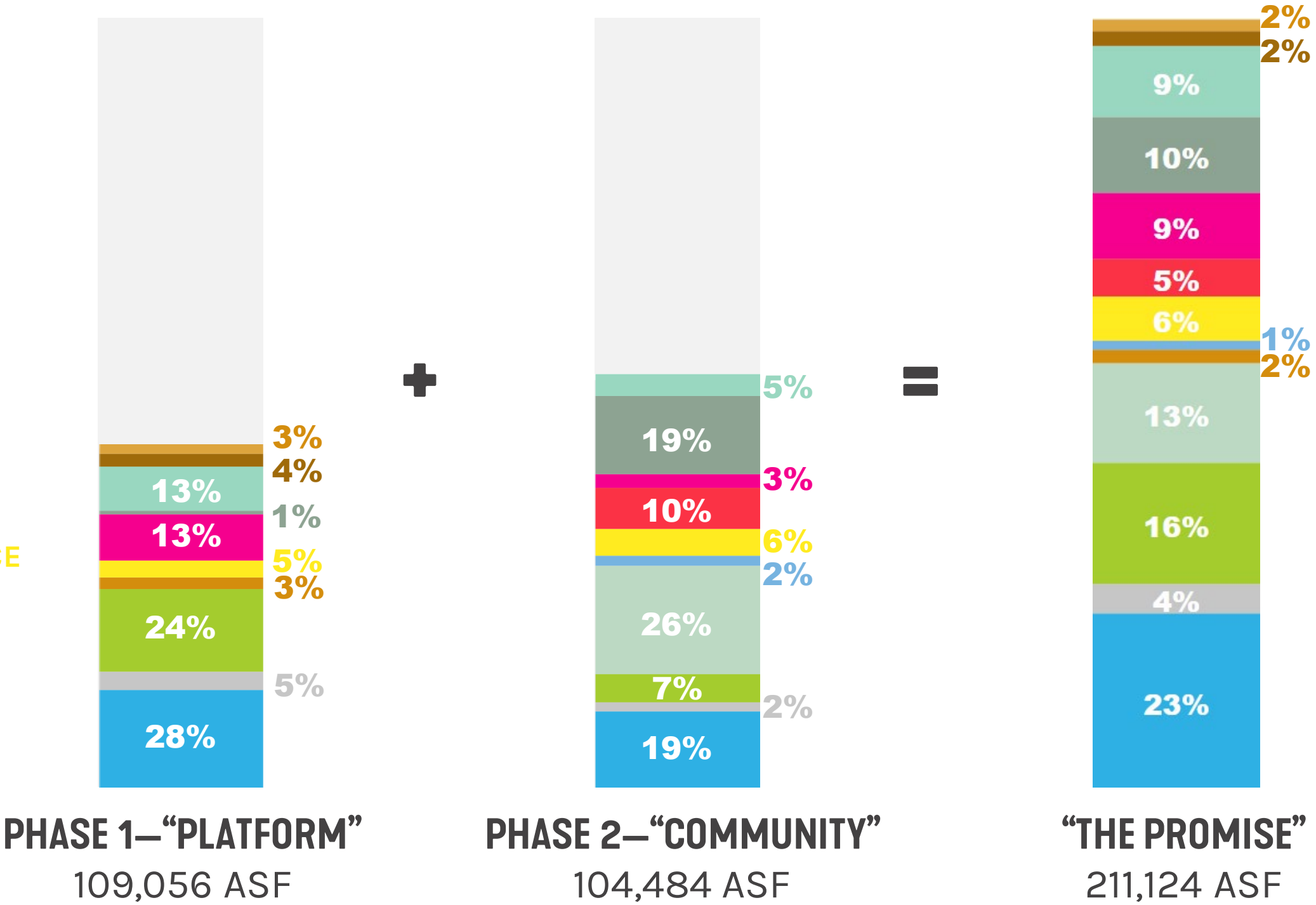

PRAIRIE SPRING SCIENCE CENTER IN PHASES – SPACE TYPES

2017

- BUILDING SUPPORT
- SHARED – COLLABORATION
- STUDENT – COLLABORATION
- OFFICE – FACULTY
- OFFICE – DEPARTMENTAL
- OFFICE – COLLABORATION
- CORE LAB
- RESEARCH LABS
- CLASS LABS
- CLASSROOMS

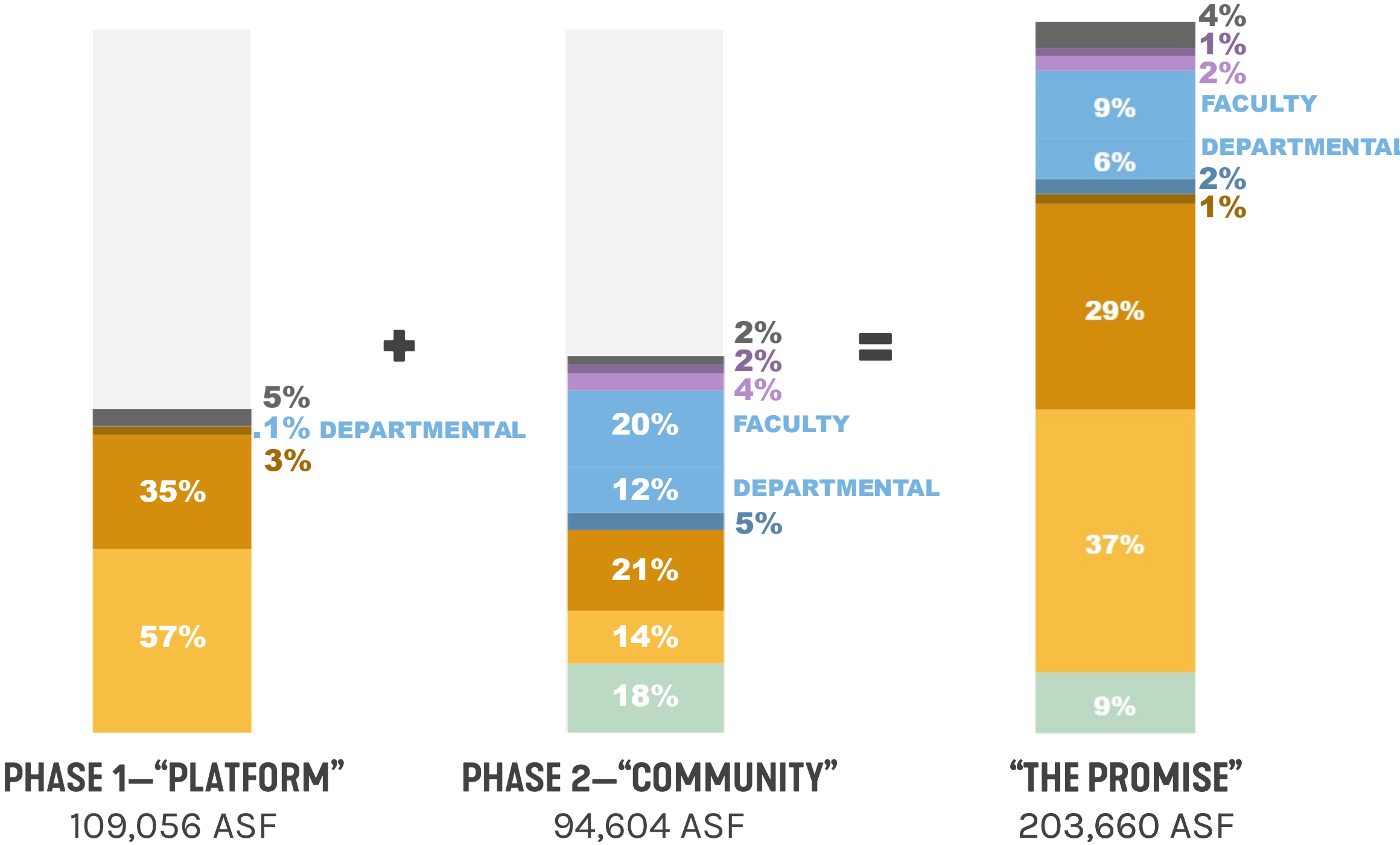

PRAIRIE SPRING SCIENCE CENTER IN PHASES – SPACE TYPES

2021 UPDATE

- BUILDING SUPPORT
- SHARED – COLLABORATION
- STUDENT – COLLABORATION
- OFFICE – FACULTY
- OFFICE – DEPARTMENTAL
- OFFICE – COLLABORATION
- CORE LAB
- RESEARCH LABS
- CLASS LABS
- CLASSROOMS

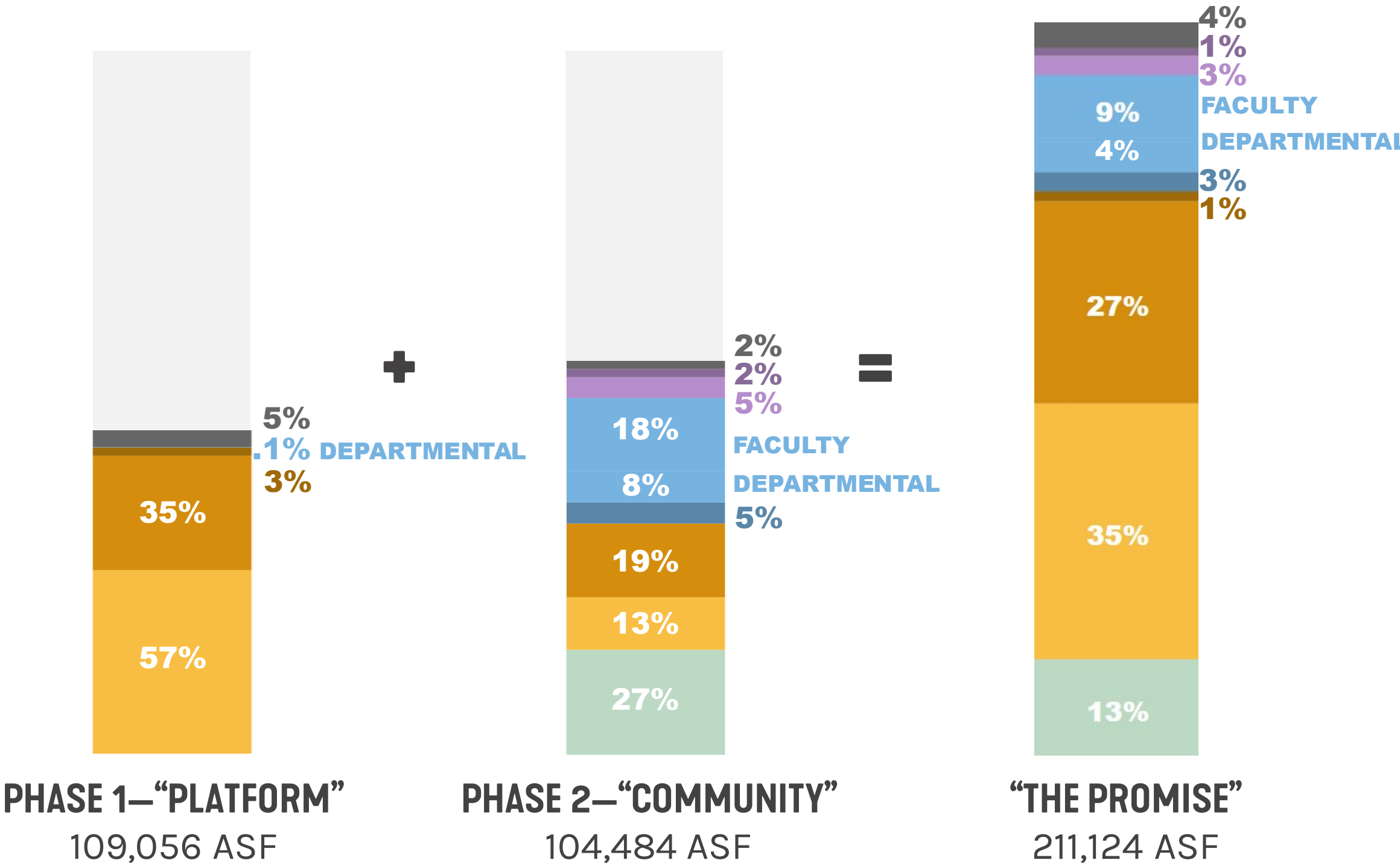

PROGRAM OVERVIEW

BIOLOGY

- **Reduced Vivarium (-1,868 ASF)**
- **Reduced Lab Support Staff Offices from 4 to 2 (-240 ASF)**
- **Removed extra ADA office (-80 ASF)**
- **Added Departmental Meeting Room (+120 ASF)**
- **Resized Greenhouse to match module (+50 ASF)**
- **Student Workstations Enlarged (+50 ASF)**
- **Delta = -1,968 ASF**

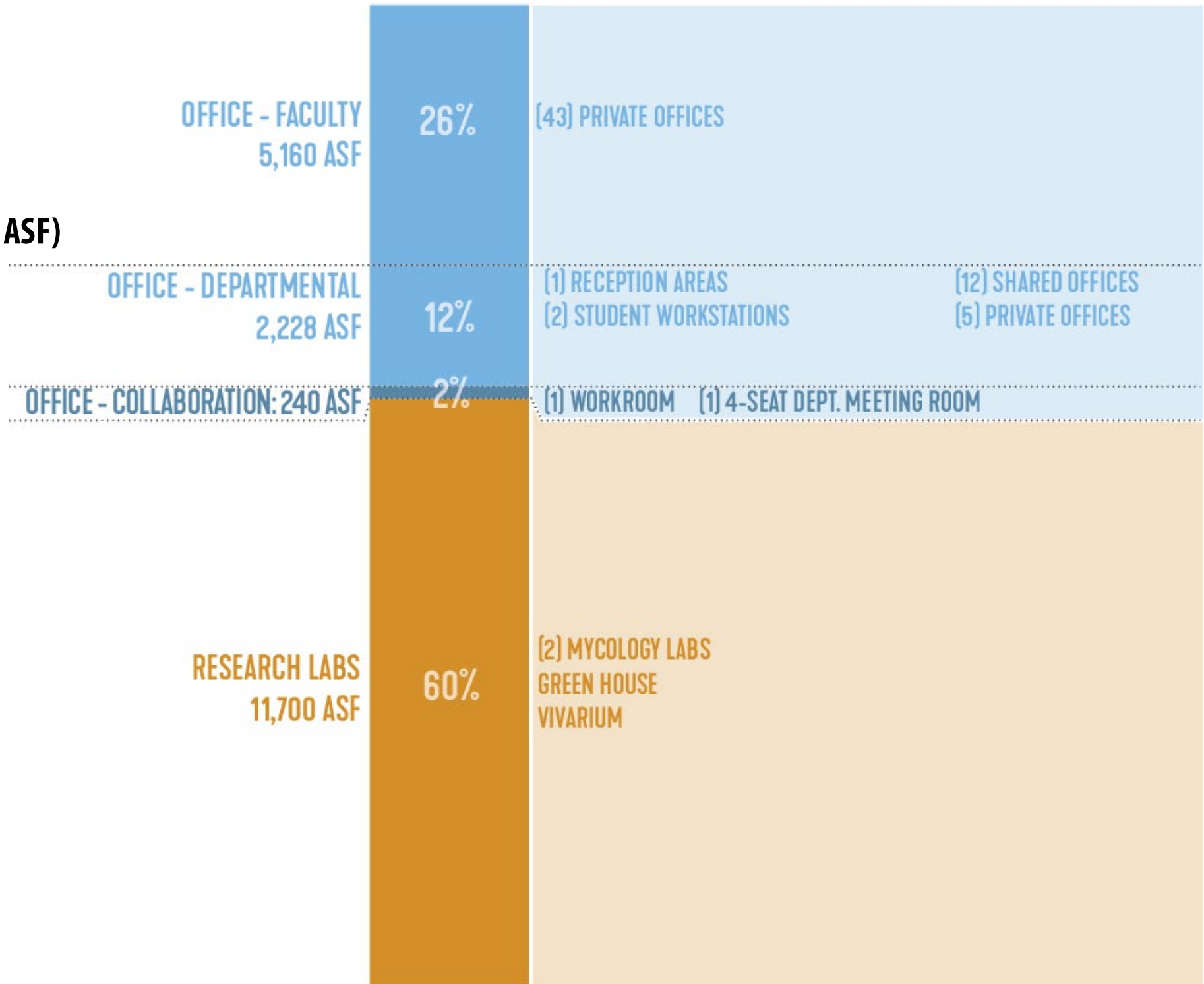

ADJACENCIES

BIOLOGY

BIOLOGY

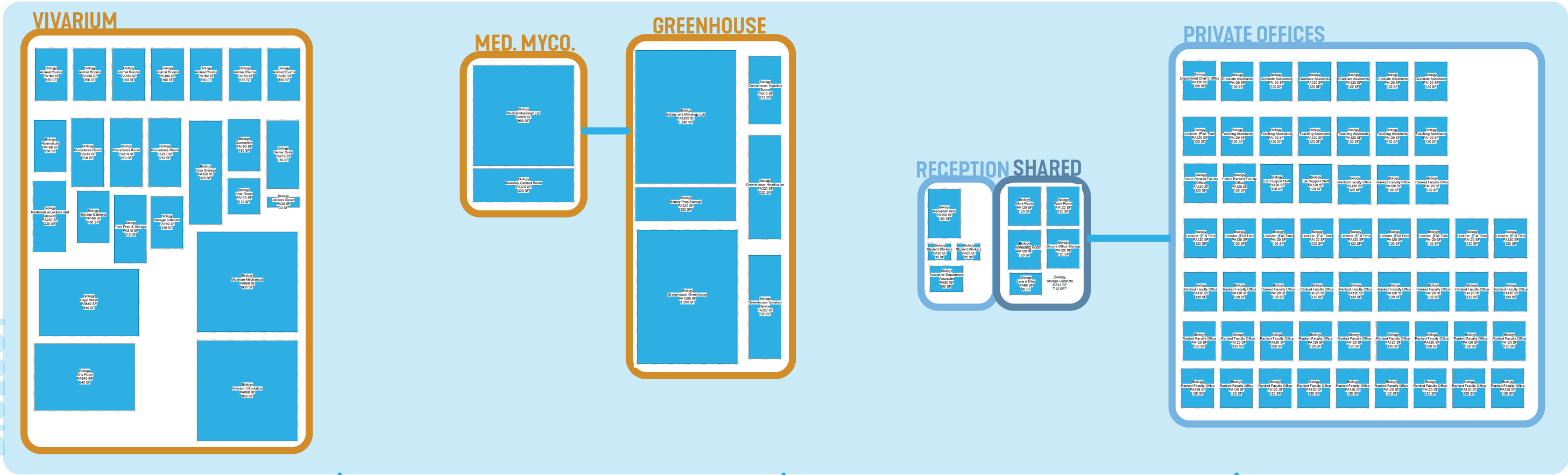

SCIENCE
METHODS
EDUCATION

MATH
METHODS
EDUCATION

BIOCHEMISTRY

ACTIVE
LEARNING

PROGRAM OVERVIEW

CLASSROOMS

- Increased 72-seat Active Learning to 84-seat (+456 ASF)
- Added (2) 84-seat Active Learning (+6,384 ASF)
- Increased 80-seat classrooms to 100-seat (+960 ASF)
- Changed 150 seat fixed theater style classroom to fixed tables and moveable chairs (+2,700 ASF)
- Delta = +10,500 ASF

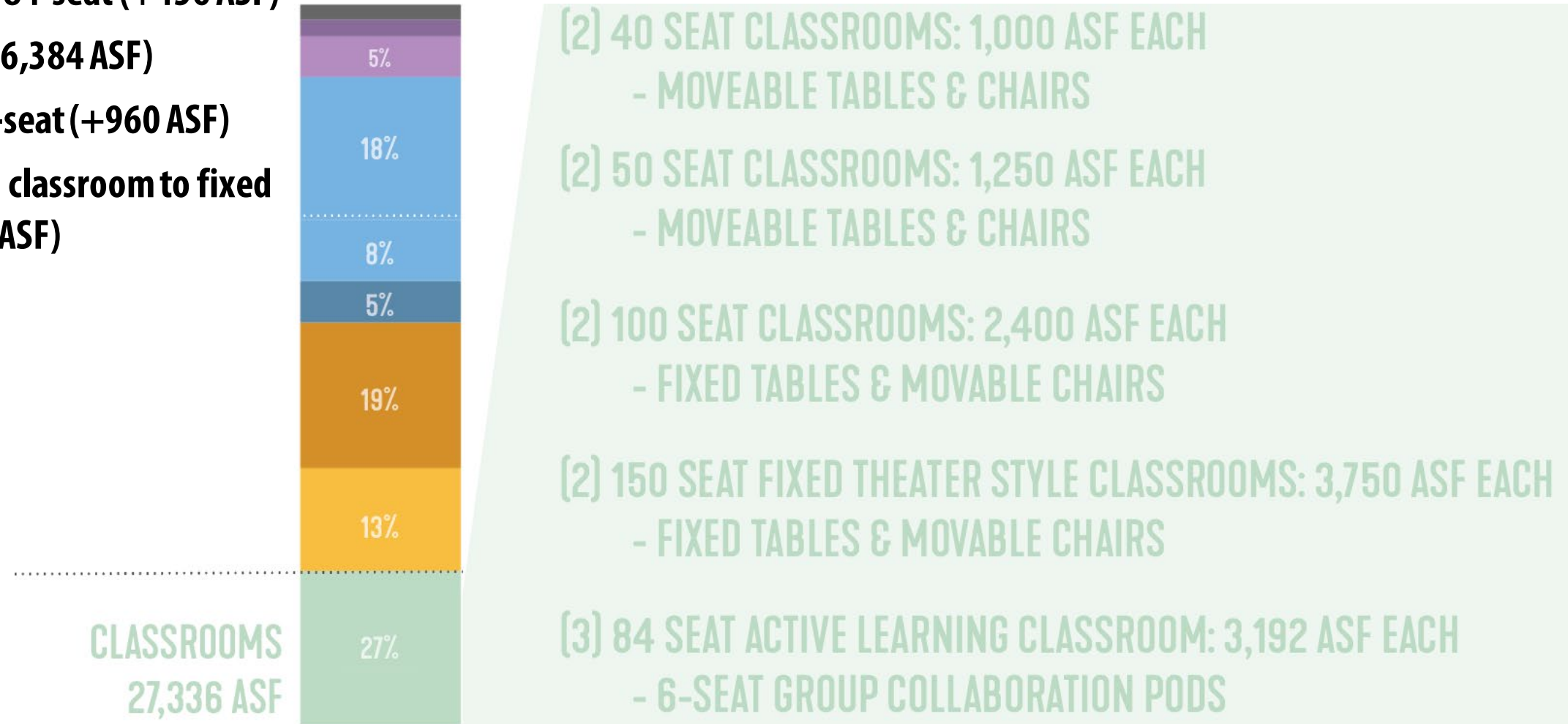

ADJACENCIES

CLASSROOMS

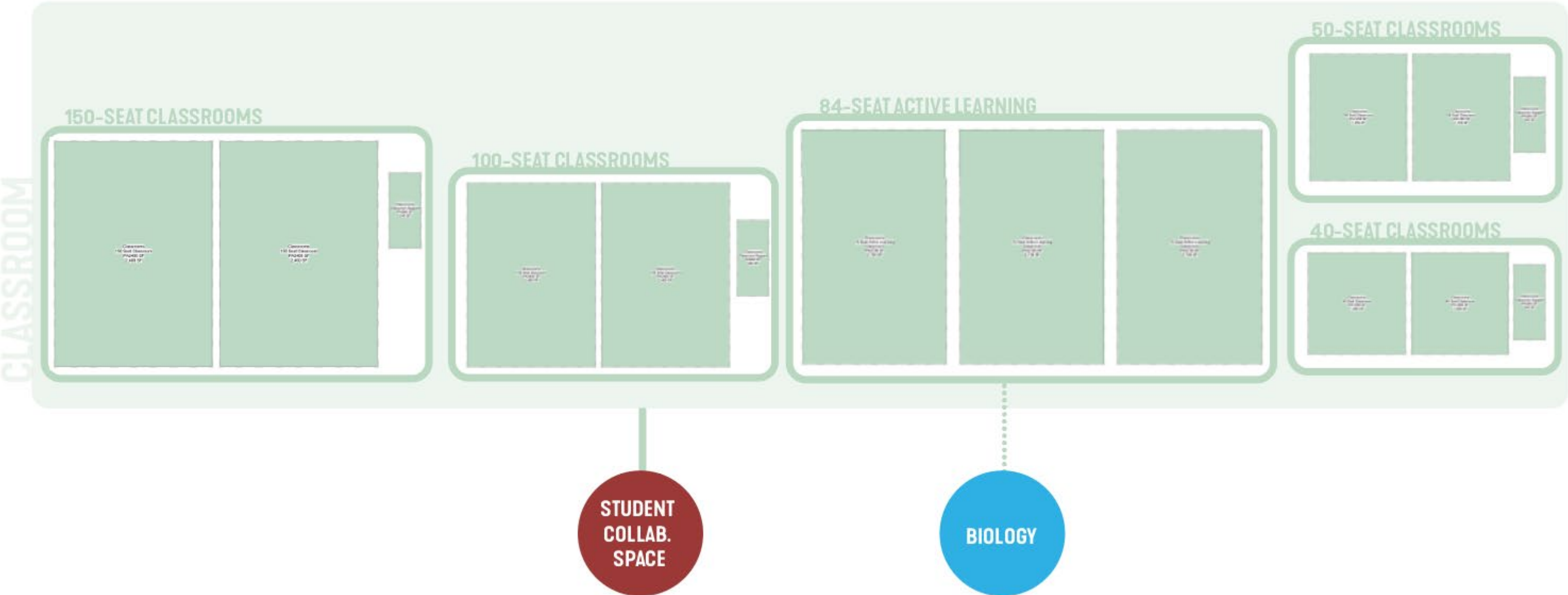

PROGRAM OVERVIEW

MISC. INSTRUCTIONAL SUPPORT

- Recategorized Student Organization Space (+0 ASF)
- Recategorized Faculty Resource Centers (+0 ASF)
- Renamed Maker Space to CS Engineering Lab (+0 ASF)
- Resizing to match module (+196 ASF)
- Removed (1) extra Science Ed Support Space (-640 ASF)
- Enlarged Science Ed Lab (+250)
- Delta = -194 ASF

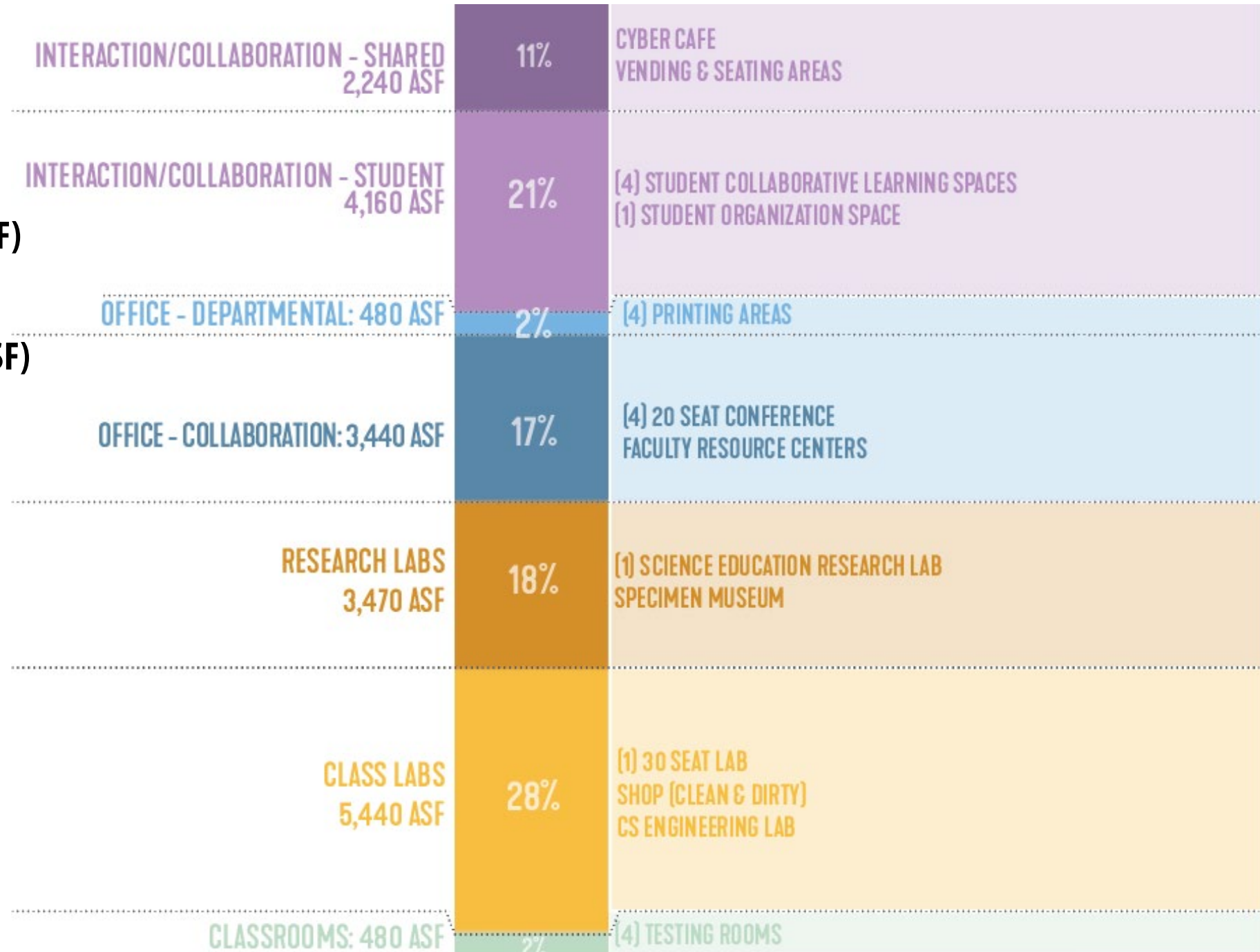

ADJACENCIES

MISC. INSTRUCTIONAL & SUPPORT

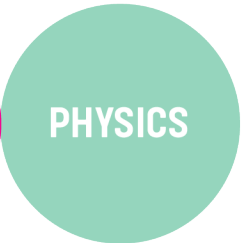
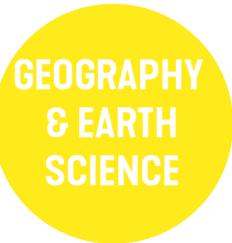

MISC. INSTRUCT. & SUPP.

FACULTY COLLAB.



VENDING/SEATING



STUDENT COLLAB.



SPECIMEN MUSEUM

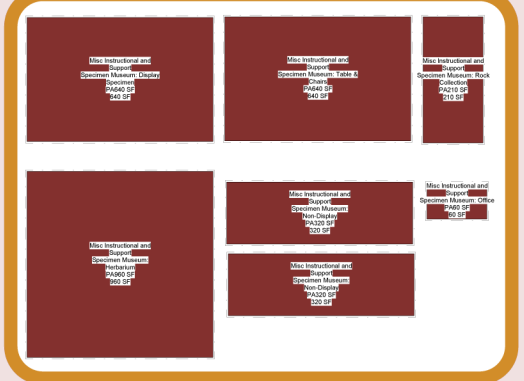

TESTING



SCIENCE ED

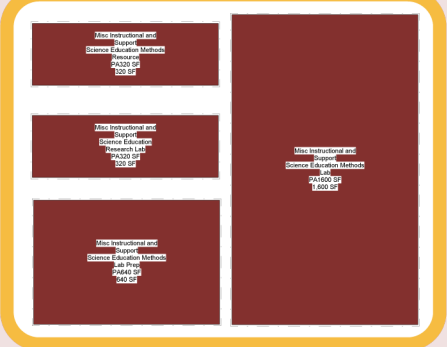

CS ENGINEERING LAB

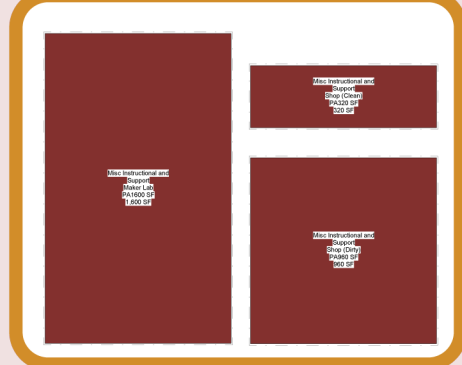

STU. ORG.



CYBER CAFE



PLANNING OPPORTUNITIES

- THE LINK
- DEPARTMENTAL SPACE ORGANIZATION

THE LINK

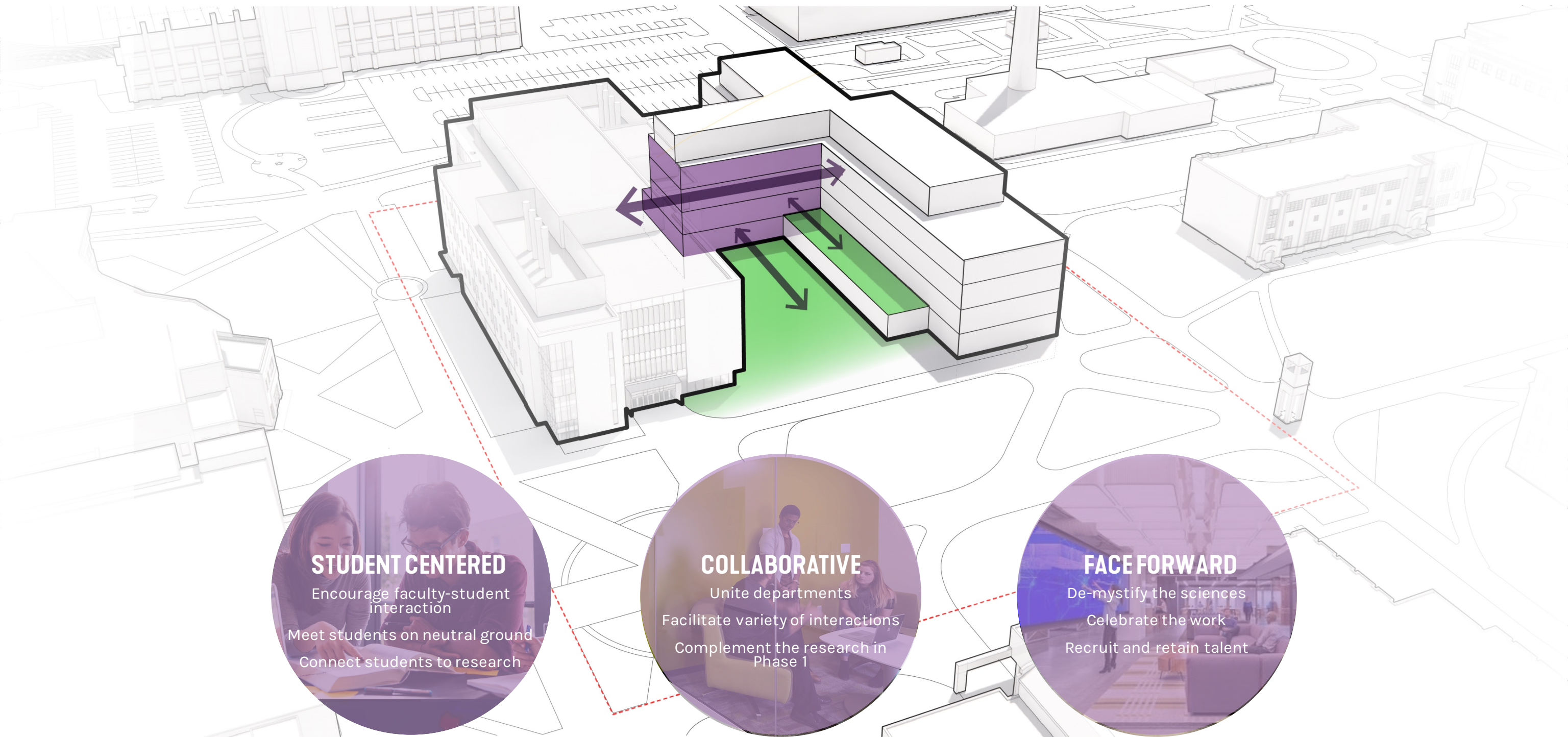

STUDENT CENTERED
Encourage faculty-student interaction
Meet students on neutral ground
Connect students to research

COLLABORATIVE
Unite departments
Facilitate variety of interactions
Complement the research in Phase 1

FACE FORWARD
De-mystify the sciences
Celebrate the work
Recruit and retain talent

THE LINK

WHAT VALUE DOES THE LINK BETWEEN PHASE 1 AND 2 PROVIDE?

LINKS RESEARCH LABS WITH STUDENTS

DAYLIGHT AND REPRIEVE FROM ENCLOSED LAB

SCIENCE ON DISPLAY

INCLUSIVE DESIGN

INFORMAL, NEUTRAL, & VARIED GATHERING SPACE

THE HEART OF THE BUILDING = STUDENT-CENTRIC

ACTIVATED WITH CLASSROOMS AND COLLABORATIVE SPACE

DIRECT CONNECTION TO COURTYARD AND ROOF TERRACE

THE LINK



19G1J Prairie Springs Science Center Phase II

THE LINK

MEANINGFUL CONNECTION TO ROOF TERRACE



THE LINK



THE LINK

TREEHOUSE PORCH



DEPARTMENTAL OFFICES

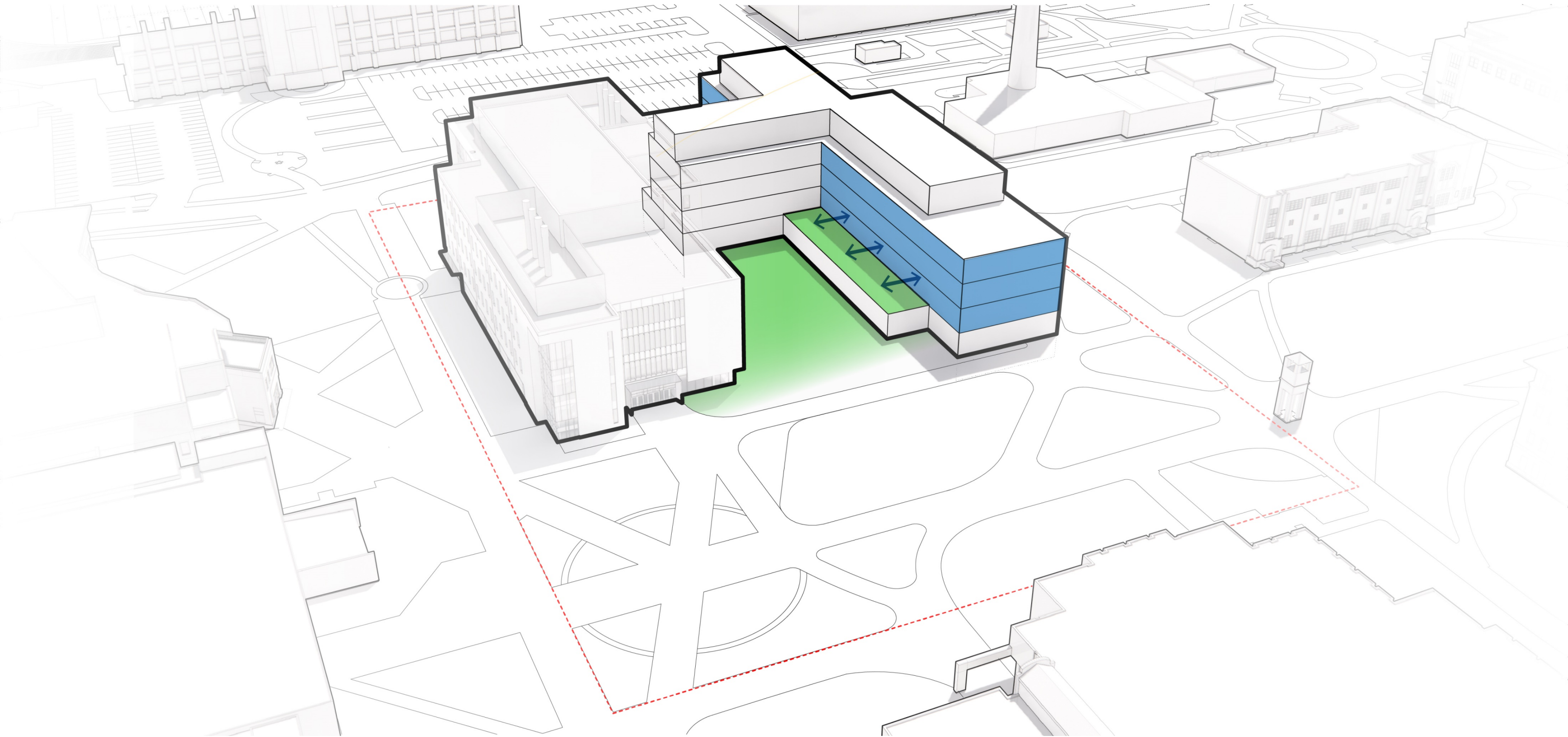

DEPARTMENTAL OFFICES

HOW DO YOU ENVISION DEPARTMENTAL SPACE TO BE ORGANIZED?

NOT A FORMAL SUITE,
OPEN AND WELCOMING

EASY TO FIND FACULTY

STUDENTS NEED TO KNOW
WHERE TO GO

DEPARTMENT FACULTY UNITED

OPPORTUNITY FOR
IMPROMPTU COLLABORATION
INTEGRATED WITH OFFICES

EQUITY IN OFFICING

EMBED NEUTRAL MEETING
ZONES WITHIN
DEPARTMENTAL OFFICE
SUITES

FLEXIBILITY, EASY
ADAPTABILITY

OFFICE STRATEGY

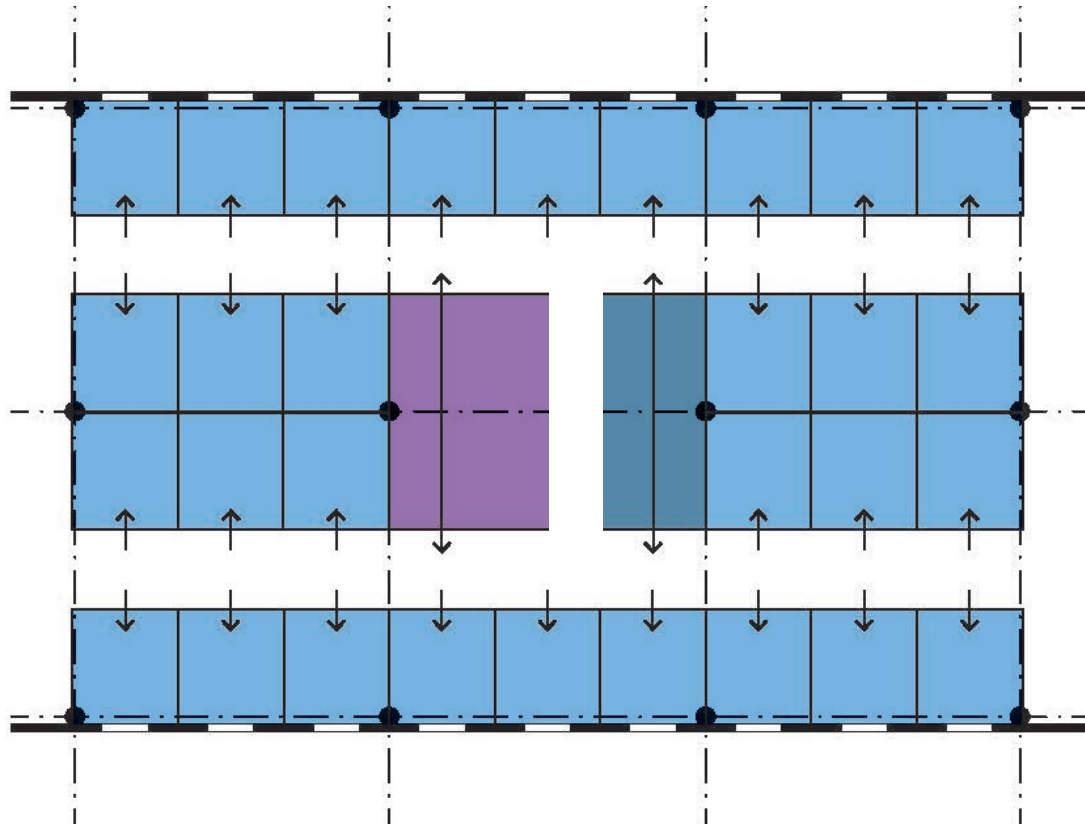

ORGANIZATIONAL MODELS

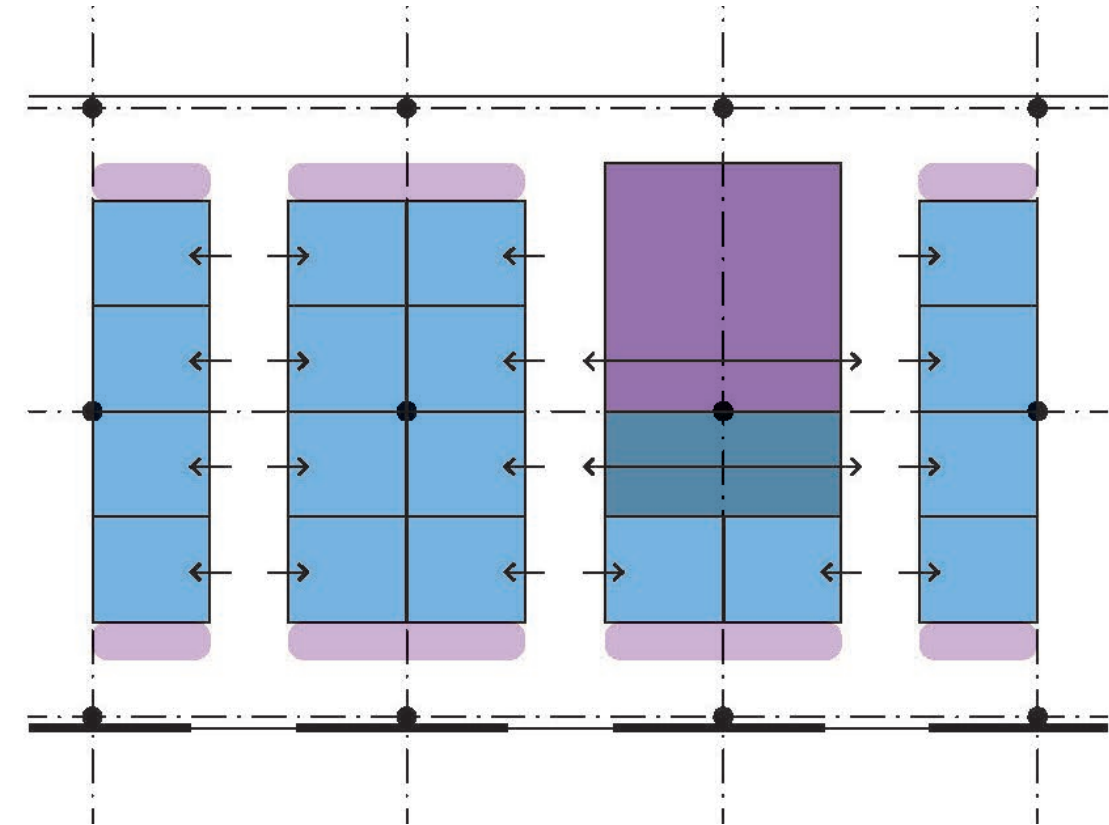

OPTION 1
(AS DEPICTED IN 10% CONCEPT REPORT)



OPTION 2

-  PRIVATE OFFICE
-  OFFICE SUPPORT - WORKROOMS / STORAGE / ETC.
-  ENCLOSED COLLABORATIVE - CONFERENCE / FACULTY RESOURCE / ETC.
-  OPEN COLLABORATIVE - WRITABLE WALL HUDDLE / NEUTRAL MEETING





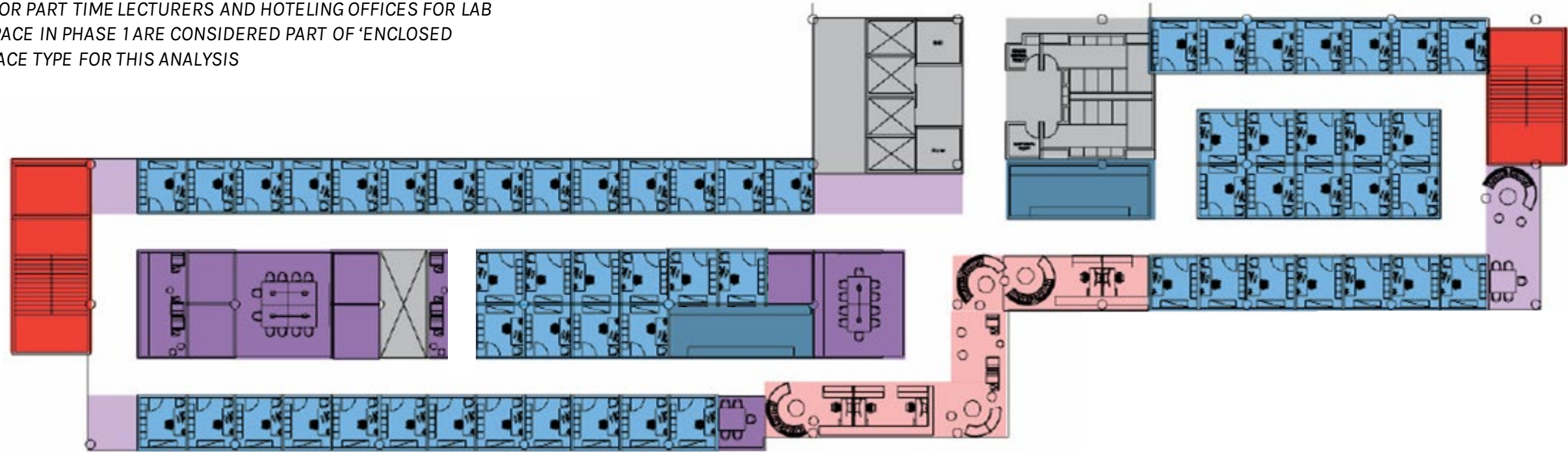

OFFICE STRATEGY

OPTION 1

60 PRIVATE OFFICES PER FLOOR

*SHARED OFFICES FOR PART TIME LECTURERS AND HOTELING OFFICES FOR LAB MANAGERS WITH SPACE IN PHASE 1 ARE CONSIDERED PART OF 'ENCLOSED COLLABORATIVE' SPACE TYPE FOR THIS ANALYSIS

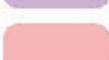

-  PRIVATE OFFICE
-  OFFICE SUPPORT
WORKROOMS / STORAGE / ETC.
-  ENCLOSED COLLABORATIVE
CONFERENCE / FACULTY RESOURCE / ETC.
-  OPEN COLLABORATIVE
WRITABLE WALL HUDDLE / NEUTRAL MEETING
-  RECEPTION
-  STAIRS
-  BUILDING SUPPORT
TOILETS, MECH SHAFTS, ELEC/IT/AV ROOMS, ETC.

INTERIOR EXPERIENCE

OPTION 1

**THIS RENDERING DOES NOT REPRESENT FINAL DESIGN. ALTERNATE OPTIONS FOR MEETING OFFICE GLAZING GUIDELINES WILL BE EXPLORED, INCLUDING BUT NOT LIMITED TO: SOLID DOOR PANEL WITH GLAZED SIDELIGHTS ONLY, TRANSOM WINDOWS, ALTERNATE TRANSLUCENT GLAZING PATTERNS, AND GLAZING THAT DOES NOT EXTEND TO THE FLOOR.*



OFFICE STRATEGY

OPTION 2

60 PRIVATE OFFICES PER FLOOR

*SHARED OFFICES FOR PART TIME LECTURERS AND HOTELING OFFICES FOR LAB MANAGERS WITH SPACE IN PHASE 1 ARE CONSIDERED PART OF 'ENCLOSED COLLABORATIVE' SPACE TYPE FOR THIS ANALYSIS

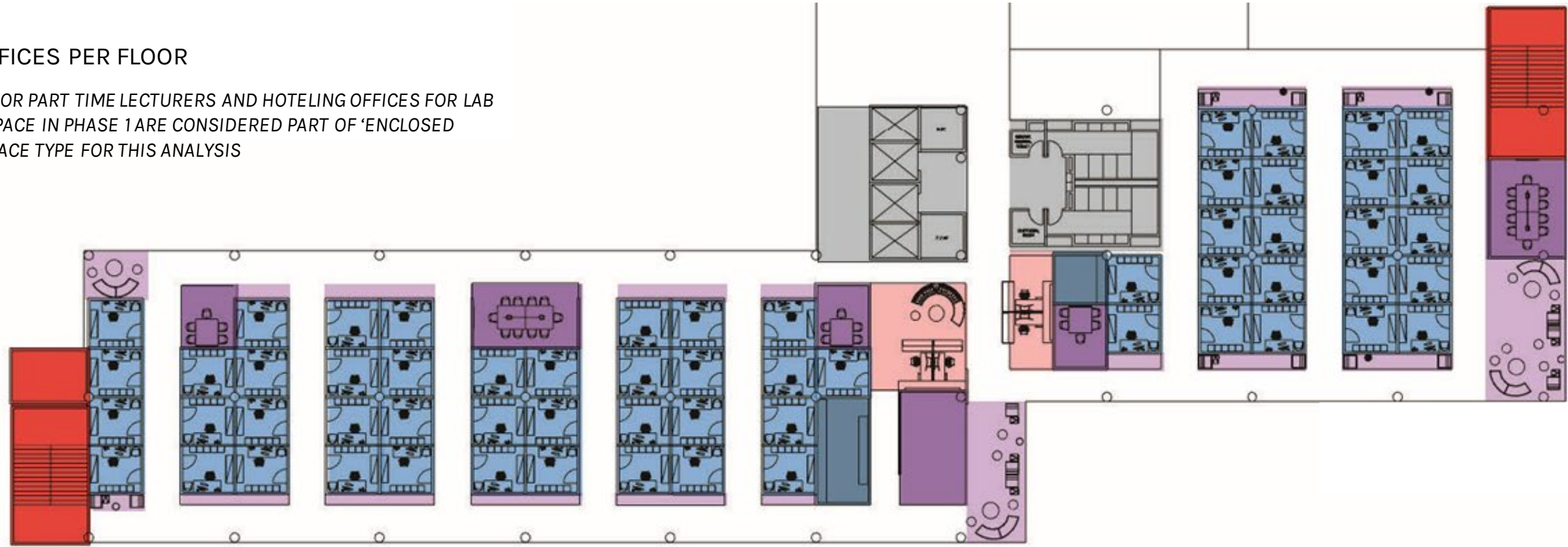

- PRIVATE OFFICE
- OFFICE SUPPORT
WORKROOMS / STORAGE / ETC.
- ENCLOSED COLLABORATIVE
CONFERENCE / FACULTY RESOURCE / ETC.
- OPEN COLLABORATIVE
WRITABLE WALL HUDDLE / NEUTRAL MEETING
- RECEPTION
- STAIRS
- BUILDING SUPPORT
TOILETS, MECH SHAFTS, ELEC/IT/AV ROOMS, ETC.

INTERIOR EXPERIENCE

OPTION 2

*THIS RENDERING DOES NOT REPRESENT FINAL DESIGN. ALTERNATE OPTIONS FOR MEETING OFFICE GLAZING GUIDELINES WILL BE EXPLORED, INCLUDING BUT NOT LIMITED TO: SOLID DOOR PANEL WITH GLAZED SIDELIGHT ONLY, TRANSOM WINDOWS, ALTERNATE TRANSLUCENT GLAZING PATTERNS, AND GLAZING THAT DOES NOT EXTEND TO THE FLOOR. ALTERNATES TO THE WRITABLE SURFACE SHOWN WILL ALSO BE EXPLORED INCLUDING WRITABLE GLASS AND WHITEBOARDS.



Headline Writing and Title Tag (SEO) in a Checklist format

Viking Brattler

Brattler Involving the Vikings - Wikipedia
www.wikipedia.org/Brattler

The 2 Most Beautiful and Oldest in the History of Brattler
www.wikipedia.com/Brattler

Viking Jewelry

Viking Jewelry - Shopping Silver and Bronze
Viking Jewellery for Sale
www.goldandgem.com/viking-jewelry.html

↓ pg. 3
1,000 Year-Old Viking Jewelry Found on Danish Farm
ic4.com/1-000-year-old-viking-jewelry

Checklist on - Search/Keyword

1. The about section should not include product info

Checklist
- product
- about
- contact

This information is in your hand - target to fill!

A Product/Menu
- should I create
- All functions (individual pages)
- How can I best present targeted content with

Product to target
- job search
- get search
- help/faq



INTERIOR EXPERIENCE

OPTION 2

*THIS RENDERING DOES NOT REPRESENT FINAL DESIGN. ALTERNATE OPTIONS FOR MEETING OFFICE GLAZING GUIDELINES WILL BE EXPLORED, INCLUDING BUT NOT LIMITED TO: SOLID DOOR PANEL WITH GLAZED SIDELIGHT ONLY, TRANSOM WINDOWS, ALTERNATE TRANSLUCENT GLAZING PATTERNS, AND GLAZING THAT DOES NOT EXTEND TO THE FLOOR. ALTERNATES TO THE WRITABLE SURFACE SHOWN WILL ALSO BE EXPLORED INCLUDING WRITABLE GLASS AND WHITEBOARDS.



OFFICE STRATEGY

PROS AND CONS

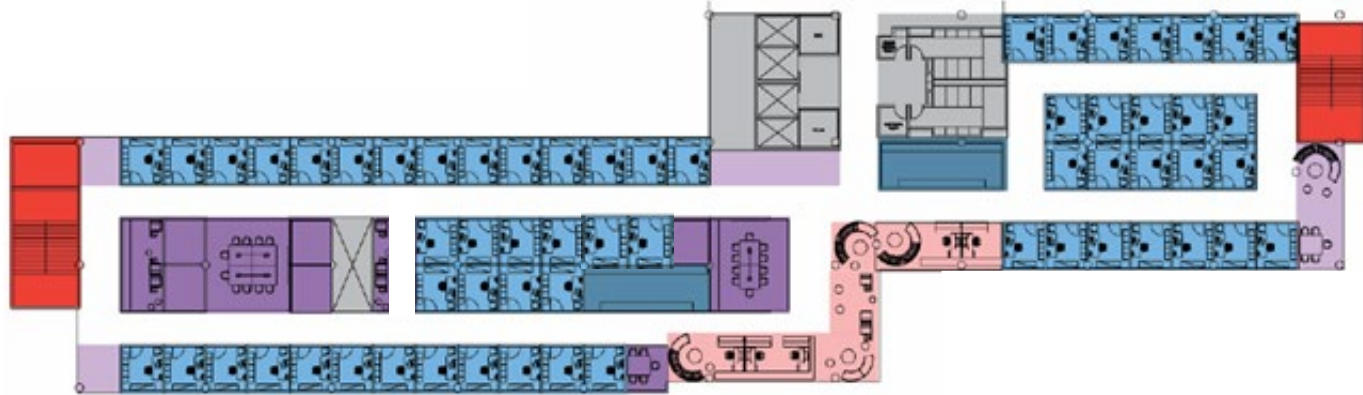

OPTION 1

MOST EFFICIENT
STATUS QUO

1/3 OF OFFICES HAVE LIMITED ACCESS TO DAYLIGHT & NO VIEW TO OUTSIDE
LIMITED FLEXIBILITY OVER THE LONG TERM
LIMITED ACCESS TO COLLABORATION ZONES
LESS PRIVACY (ALL OFFICES ARE ON A PRIMARY CORRIDOR)
INTIMIDATING

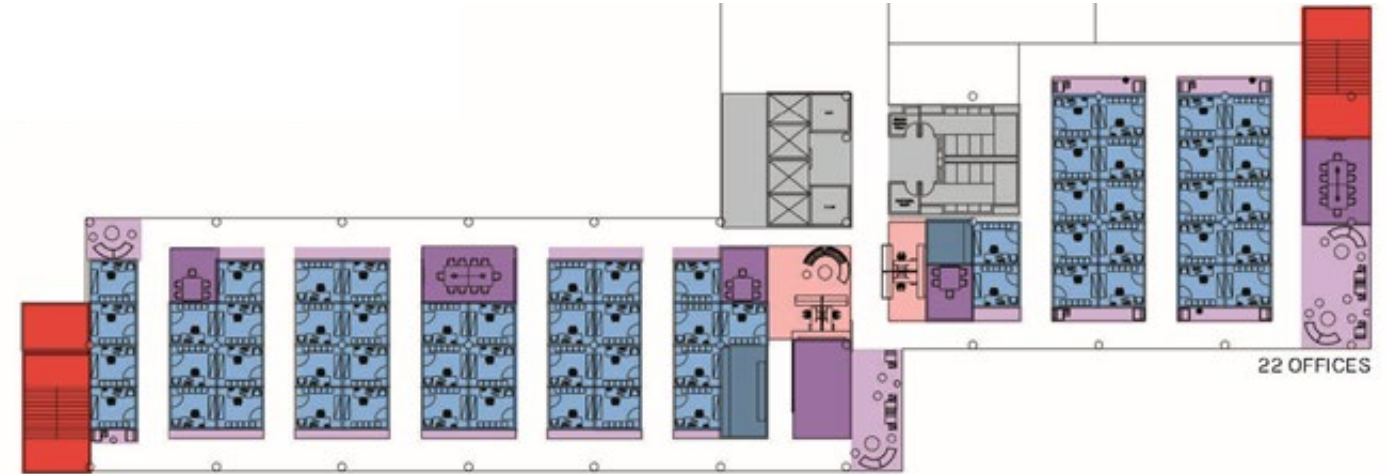

OPTION 2

ALL OFFICES ARE EQUALLY DESIREABLE
DAYLIGHT PENETRATES TO THE CENTER OF THE FLOOR
VIEWS OUTSIDE ARE AVAILABLE TO ALL VIA CORRIDORS & COLLABORATION AREAS
MORE OPEN AND WELCOMING FOR STUDENTS
NEUTRAL MEETING AND COLLABORATIVE ZONES DISTRIBUTED THROUGHOUT
FLEXIBLE MODULE CAN BE ADAPTED OVER TIME
INCREASED PRIVACY (OFFICES ARE CLUSTERED ON CROSS CORRIDORS)

LESS EFFICIENT
CULTURAL SHIFT

DAYLIGHTING ANALYSIS

*DAYLIGHT STUDIES BASED UPON GLAZING EXTENTS SHOWN IN RENDERINGS IN THIS DOCUMENT TO PROVIDE A BASELINE POINT OF COMPARISON BETWEEN DAYLIGHT PENETRATION IN OPTION 1 AND OPTION 2.

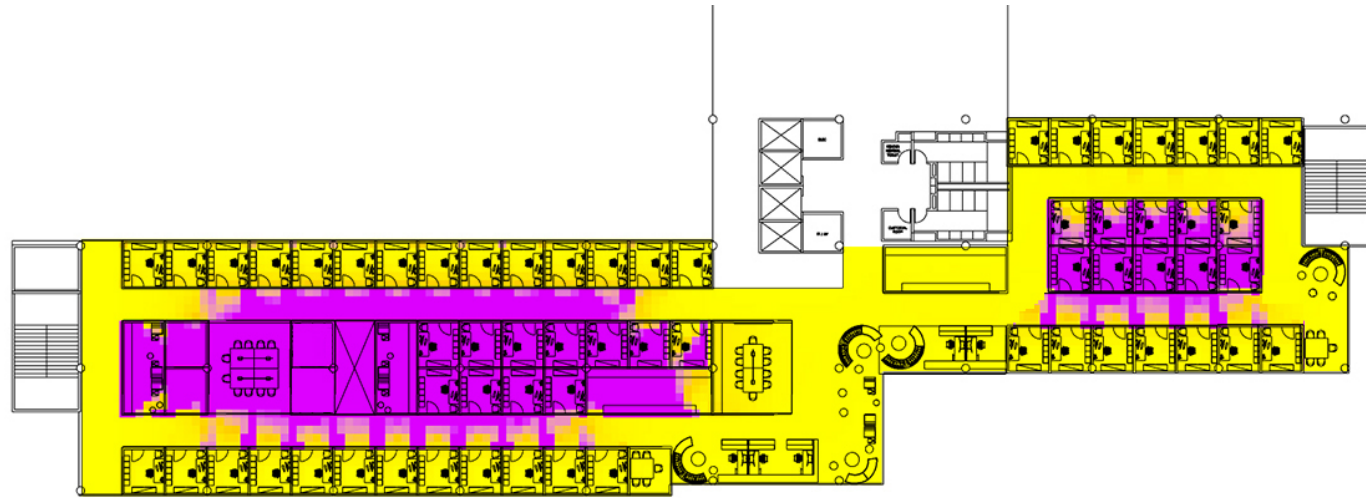

OPTION 1

INTERNAL OFFICES AND CORRIDORS HAVE LIMITED ACCESS TO DAYLIGHT



OPTION 2

CORRIDORS AND COLLABORATIVE ZONES HAVE FULL EXPOSURE TO DAYLIGHT

CDA (%)

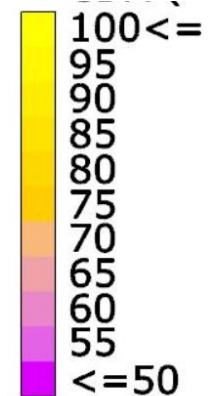

*CONTINUOUS DAYLIGHT AUTONOMY (CDA) IS THE ANNUAL PERCENTAGE OF TIME THE SPACE'S REQUIRED LIGHTING LEVELS CAN BE ACHIEVED BY DAYLIGHTING ALONE

OFFICE STRATEGY

INTERIOR EXPERIENCE

*THESE RENDERINGS DO NOT REPRESENT FINAL DESIGN. ALTERNATE OPTIONS FOR MEETING OFFICE GLAZING GUIDELINES WILL BE EXPLORED, INCLUDING BUT NOT LIMITED TO: SOLID DOOR PANEL WITH GLAZED SIDELIGHT ONLY, TRANSOM WINDOWS, ALTERNATE TRANSLUCENT GLAZING PATTERNS, AND GLAZING THAT DOES NOT EXTEND TO THE FLOOR. ALTERNATES TO THE WRITABLE SURFACE SHOWN WILL ALSO BE EXPLORED INCLUDING WRITABLE GLASS AND WHITEBOARDS.



OPTION 1



OPTION 2

TYPICAL PRIVATE OFFICE

REQUIREMENTS

TO PROMOTE PASSIVE ILLUMINATION VIA DAYLIGHTING, THE NEW SUSTAINABILITY GUIDELINES REQUIRE ALL OFFICES **WITH A DEDICATED EXTERIOR WINDOW** TO BE 50% GLASS ON THE WALL FACING THE CORRIDOR.

THE GLASS CAN BE OBSCURED WITH FROST OR CERAMIC FRIT TO PROVIDE VISUAL PRIVACY WHILE STILL EMITTING DAYLIGHT. (EXAMPLES PROVIDED BELOW)

**OFFICE FURNITURE LAYOUT FOR REFERENCE ONLY
DOOR AND SIDE LIGHT DETAILS FOR REFERENCE ONLY

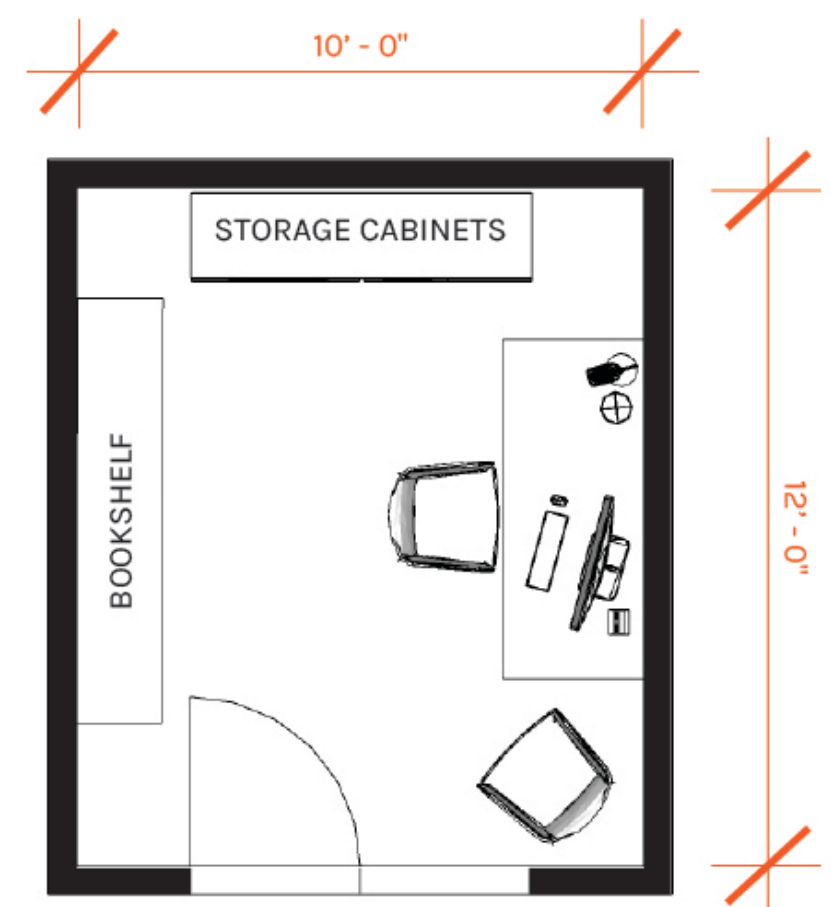
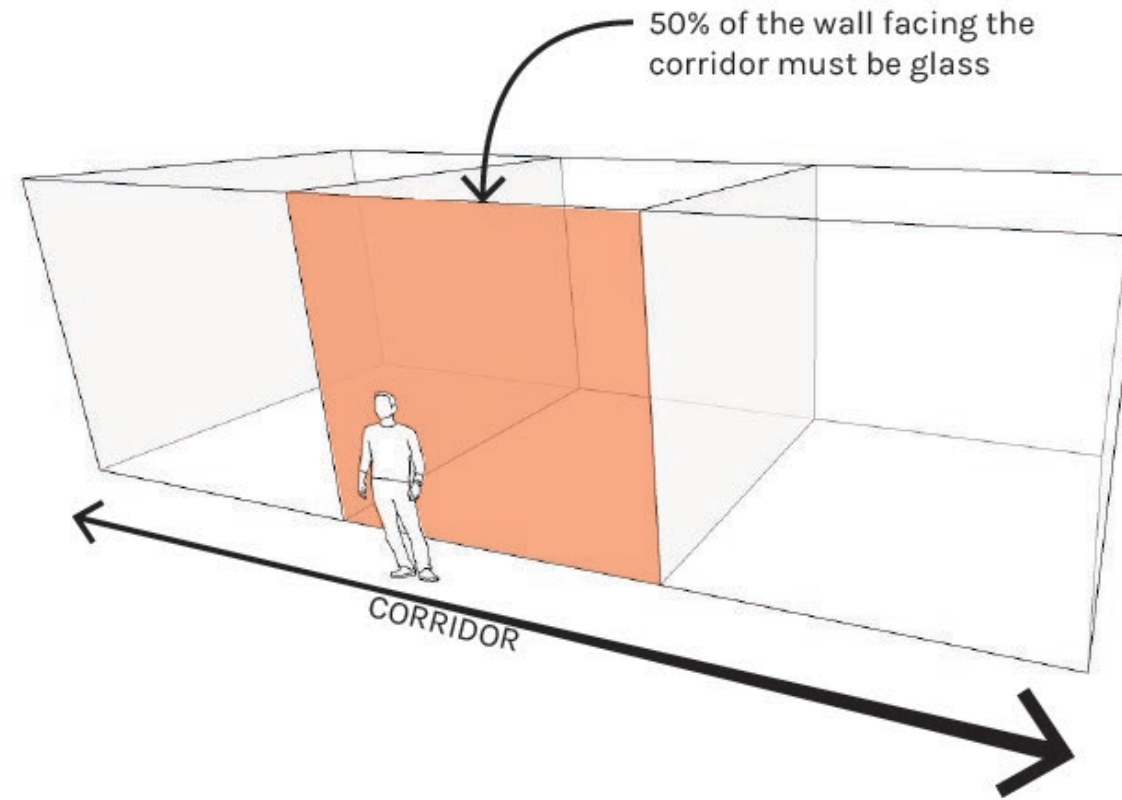

TYPICAL PRIVATE OFFICE PLAN

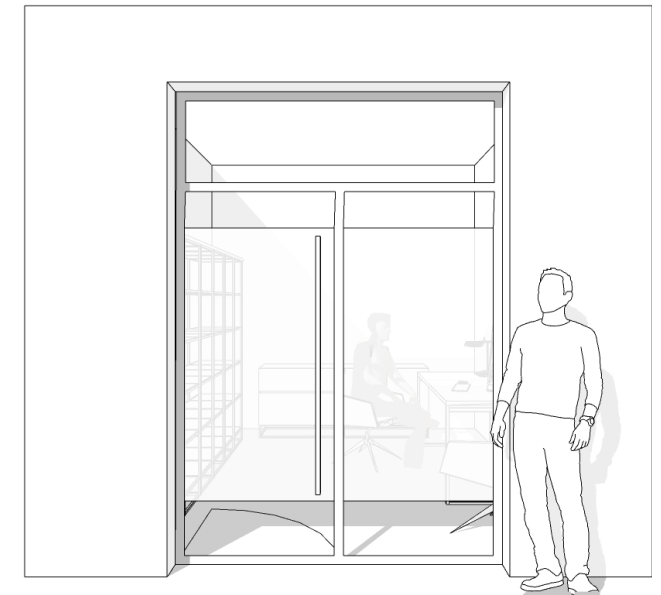

TYPICAL PRIVATE OFFICE ELEVATION

EXAMPLES OF OBSCURE GLASS FOR REFERENCE:

LIGHT FROST

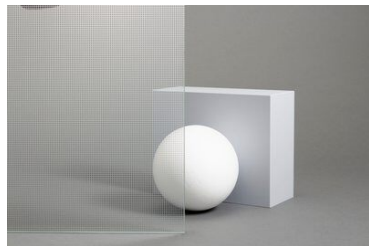

HEAVY FROST



HEAVY FROST + PATTERN



OPAQUE



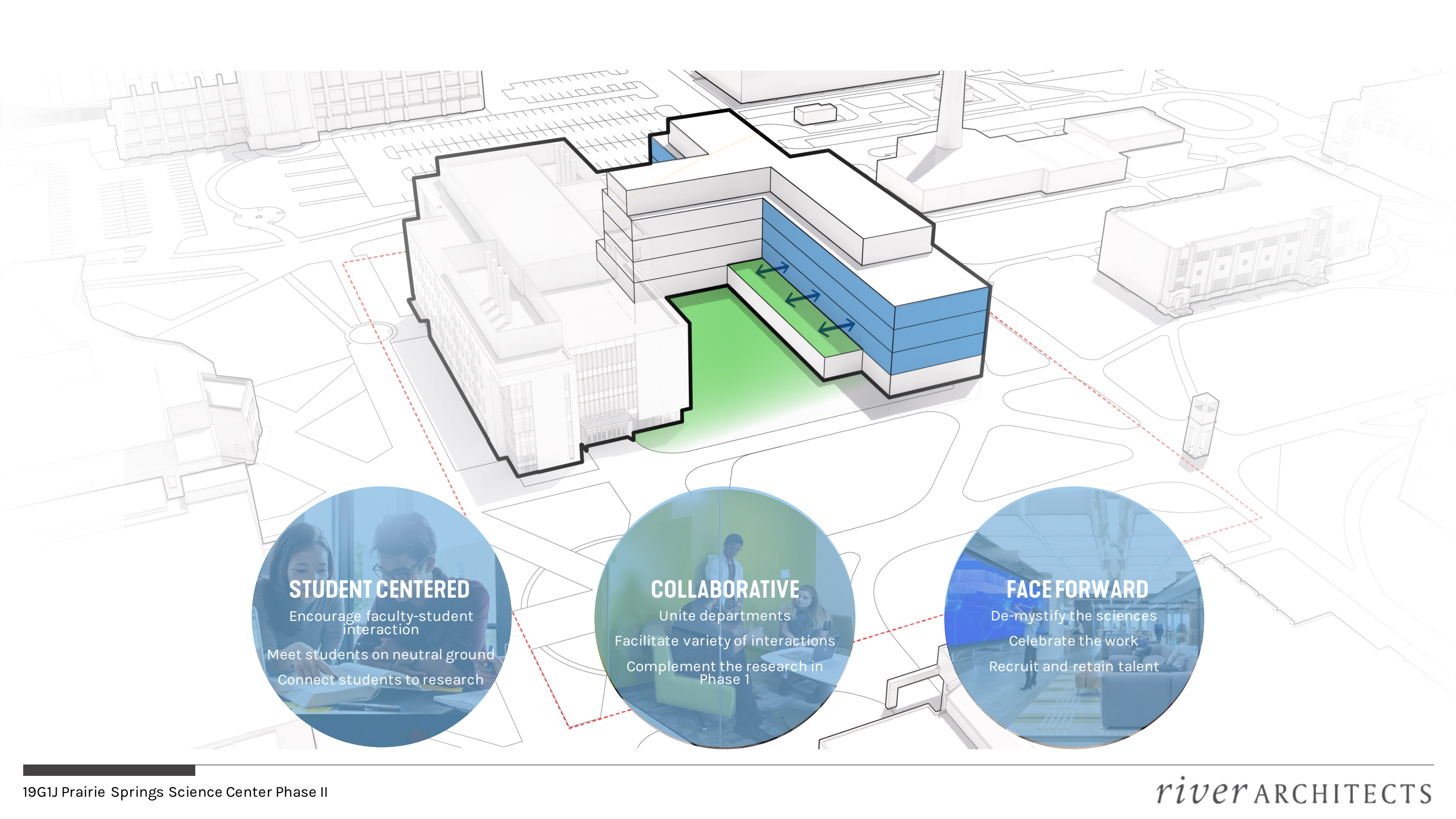

STUDENT CENTERED

Encourage faculty-student interaction
Meet students on neutral ground
Connect students to research

COLLABORATIVE

Unite departments
Facilitate variety of interactions
Complement the research in Phase 1

FACE FORWARD

De-mystify the sciences
Celebrate the work
Recruit and retain talent

TECHNOLOGY

UW-LA CROSSE
EAGLES

