



# PROGRAMMING SESSION NO. 2 - CHEMISTRY

January 27, 2021

# Agenda

---

- **Report Out**
  - **Program Updates**
  - **Adjacencies**
- **Planning Opportunities**
  - **The Link**
  - **Departmental Space Organization**
- **Technology**



A group of four students (three women and one man) are smiling and taking a selfie together outdoors. They are wearing maroon and white striped jackets. The background shows a large brick building with many windows and a grassy area.

# WHAT WE HEARD

- PROGRAM UPDATES
- SUSTAINABILITY CHARETTE OUTCOMES

# PROJECT VISION



## STUDENT CENTERED

Encourage faculty-student interaction  
Meet students on neutral ground  
Connect students to research



## COLLABORATIVE

Unite departments  
Facilitate variety of interactions  
Complement the research in Phase 1



## FACE FORWARD

De-mystify the sciences  
Celebrate the work  
Recruit and retain talent

# PRAIRIE SPRING SCIENCE CENTER IN PHASES - UNITS

2017

- RIVER STUDIES CENTER
- RADIATION CENTER
- PHYSICS
- MISC. INSTR. / SUPPORT
- MICROBIOLOGY
- MATHEMATICS
- GEOGRAPHY & EARTH SCIENCE
- DEAN'S OFFICE
- CORE LABS
- CLASSROOMS
- CHEMISTRY
- BUILDING SUPPORT
- BIOLOGY

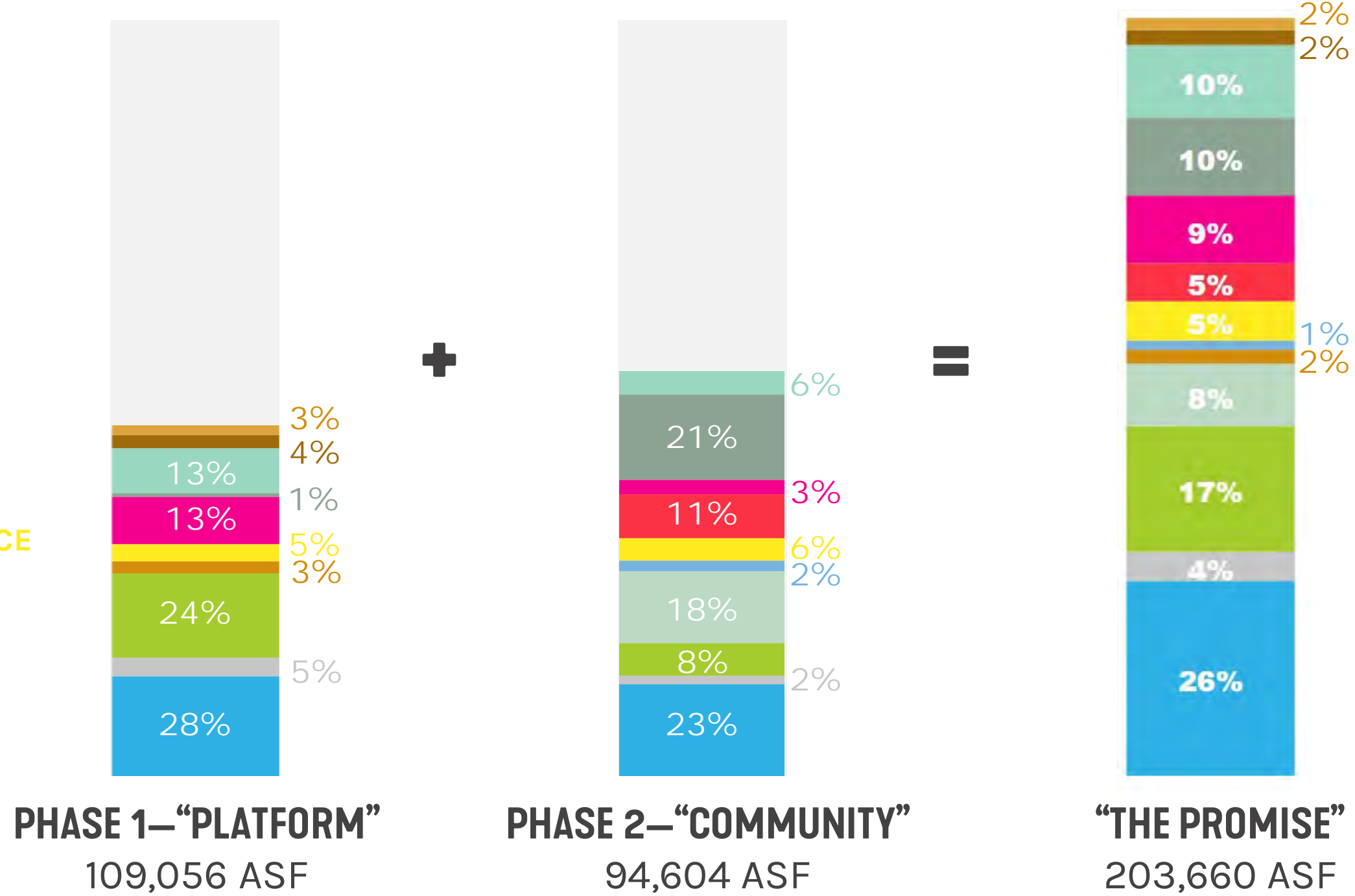

# PRAIRIE SPRING SCIENCE CENTER IN PHASES - UNITS

2021 UPDATE

- RIVER STUDIES CENTER
- RADIATION CENTER
- PHYSICS
- MISC. INSTR. / SUPPORT
- MICROBIOLOGY
- MATHEMATICS
- GEOGRAPHY & EARTH SCIENCE
- DEAN'S OFFICE
- CORE LABS
- CLASSROOMS
- CHEMISTRY
- BUILDING SUPPORT
- BIOLOGY

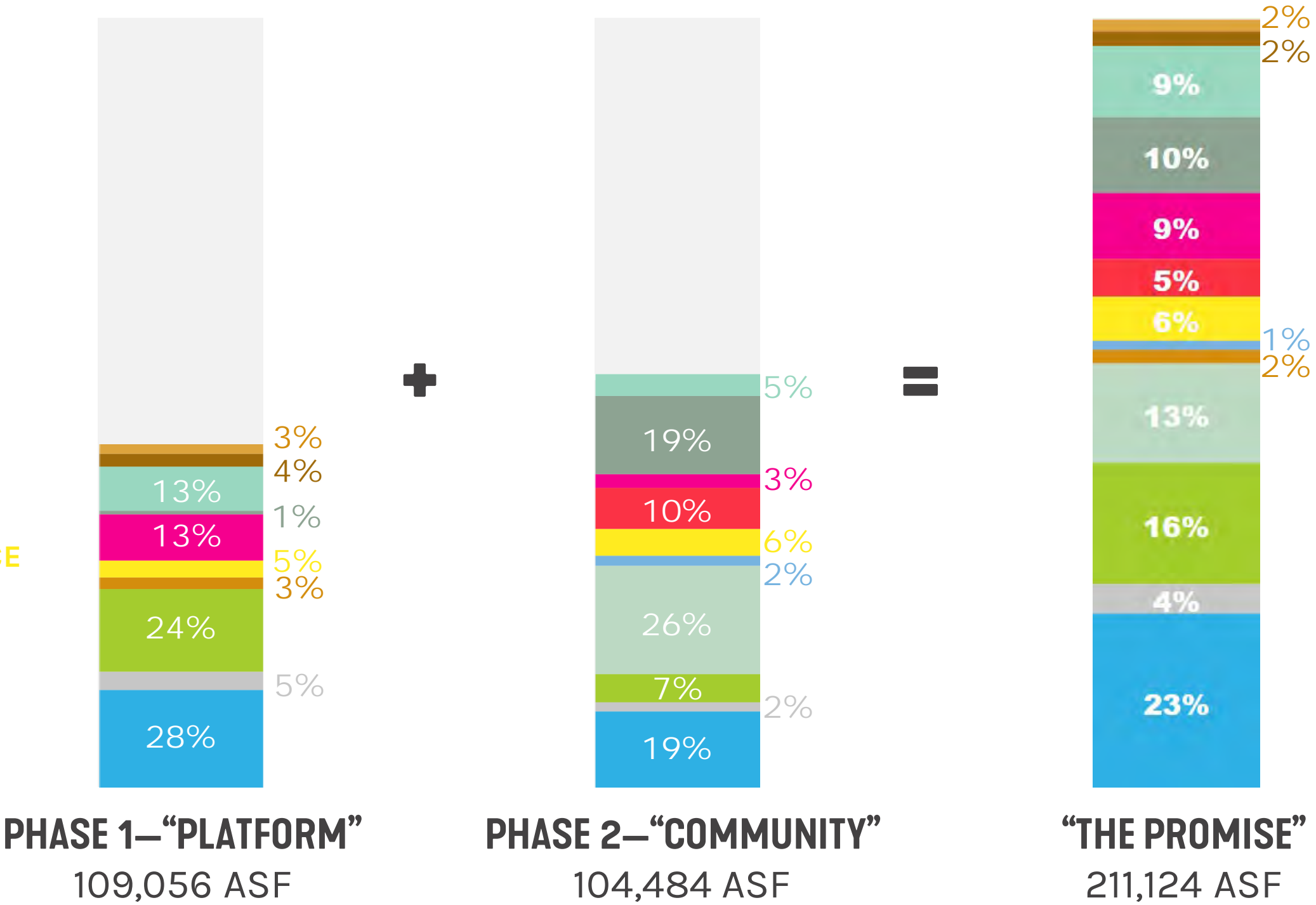

# PRAIRIE SPRING SCIENCE CENTER IN PHASES – SPACE TYPES

2017

- BUILDING SUPPORT
- SHARED – COLLABORATION
- STUDENT – COLLABORATION
- OFFICE – FACULTY
- OFFICE – DEPARTMENTAL
- OFFICE – COLLABORATION
- CORE LAB
- RESEARCH LABS
- CLASS LABS
- CLASSROOMS

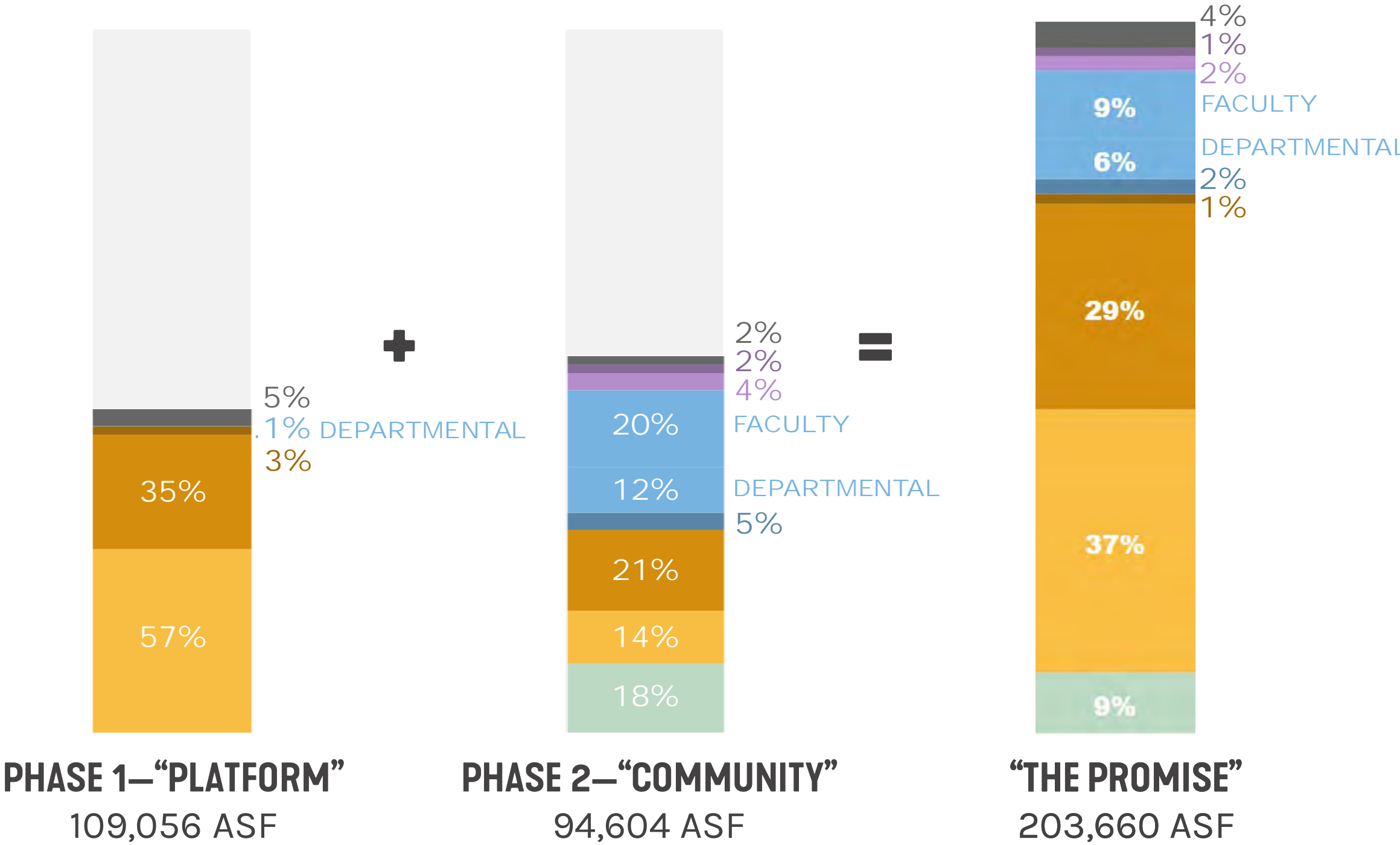

# PRAIRIE SPRING SCIENCE CENTER IN PHASES – SPACE TYPES

2021 UPDATE

- BUILDING SUPPORT
- SHARED – COLLABORATION
- STUDENT – COLLABORATION
- OFFICE – FACULTY
- OFFICE – DEPARTMENTAL
- OFFICE – COLLABORATION
- CORE LAB
- RESEARCH LABS
- CLASS LABS
- CLASSROOMS

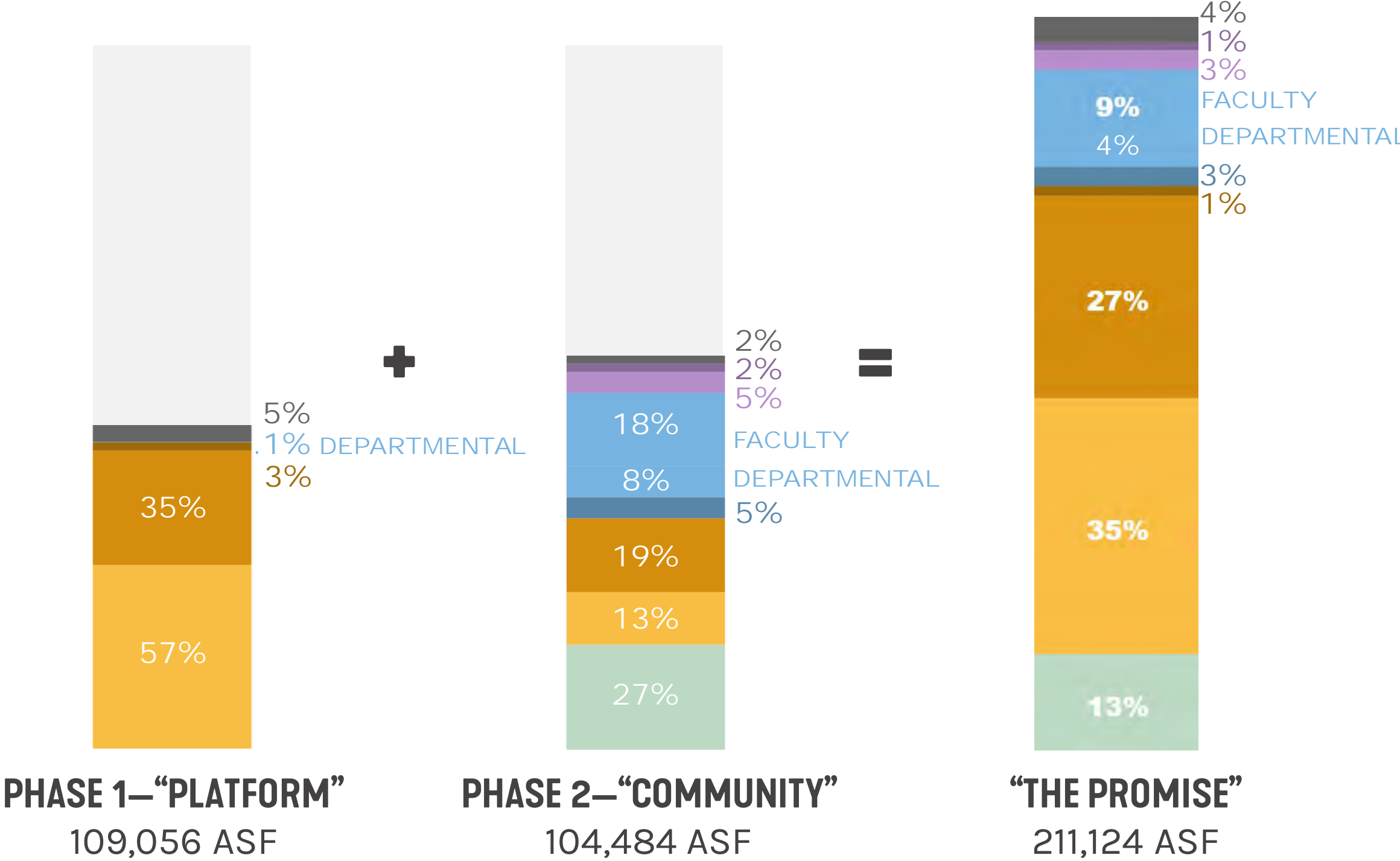



# PROGRAM OVERVIEW

## CHEMISTRY

- Removed 2 student worker shared offices (-420 ASF)
- Removed 2 Lab Support Offices (-240 ASF)
- Added Departmental Meeting Room (+120 ASF)
- Resizing Computer Labs and Faculty Student Research to match module (+40 ASF)
- Student Workstations Enlarged (+50 ASF)
- Delta = -450 ASF



CHEMISTRY

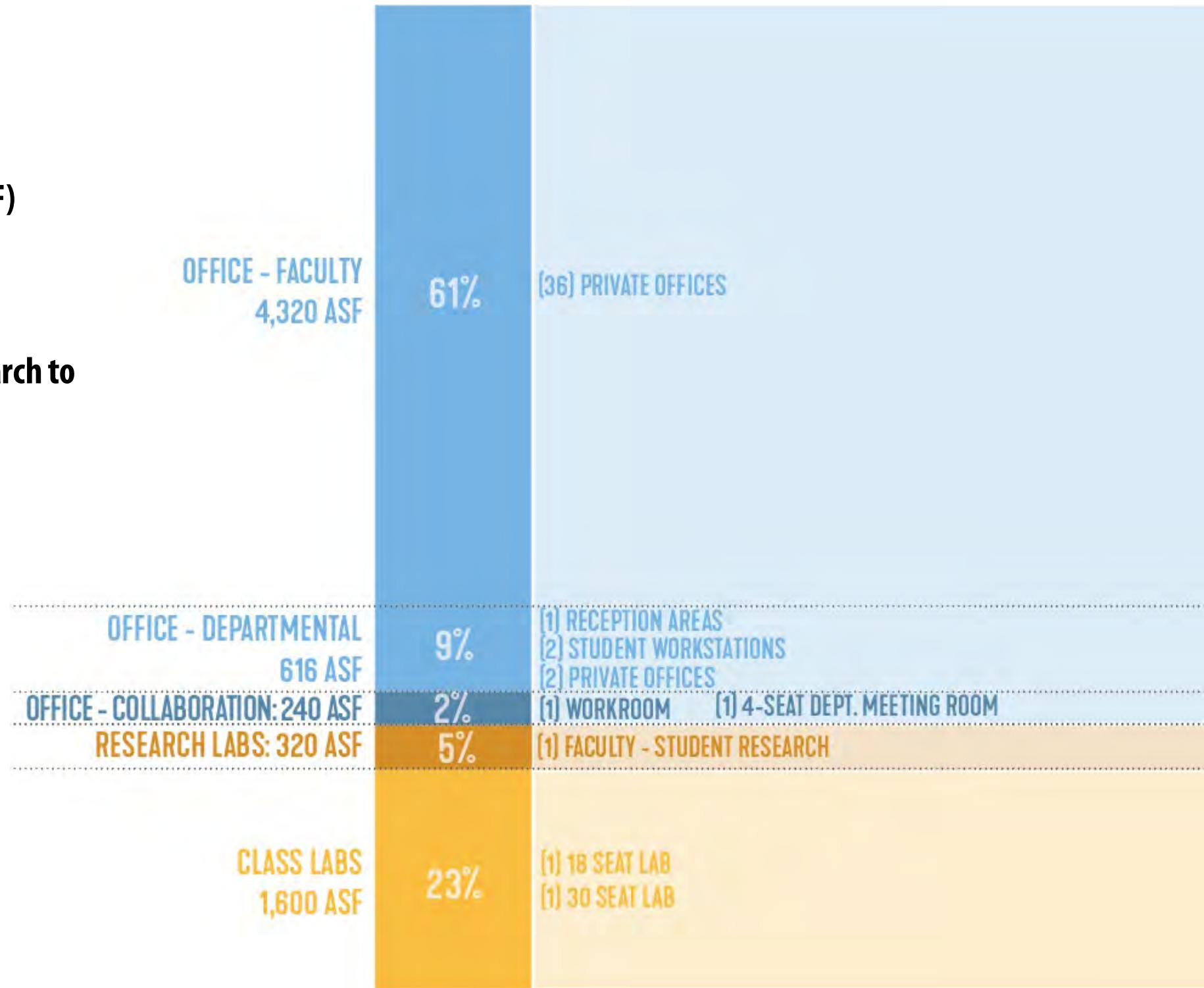

# ADJACENCIES

## CHEMISTRY

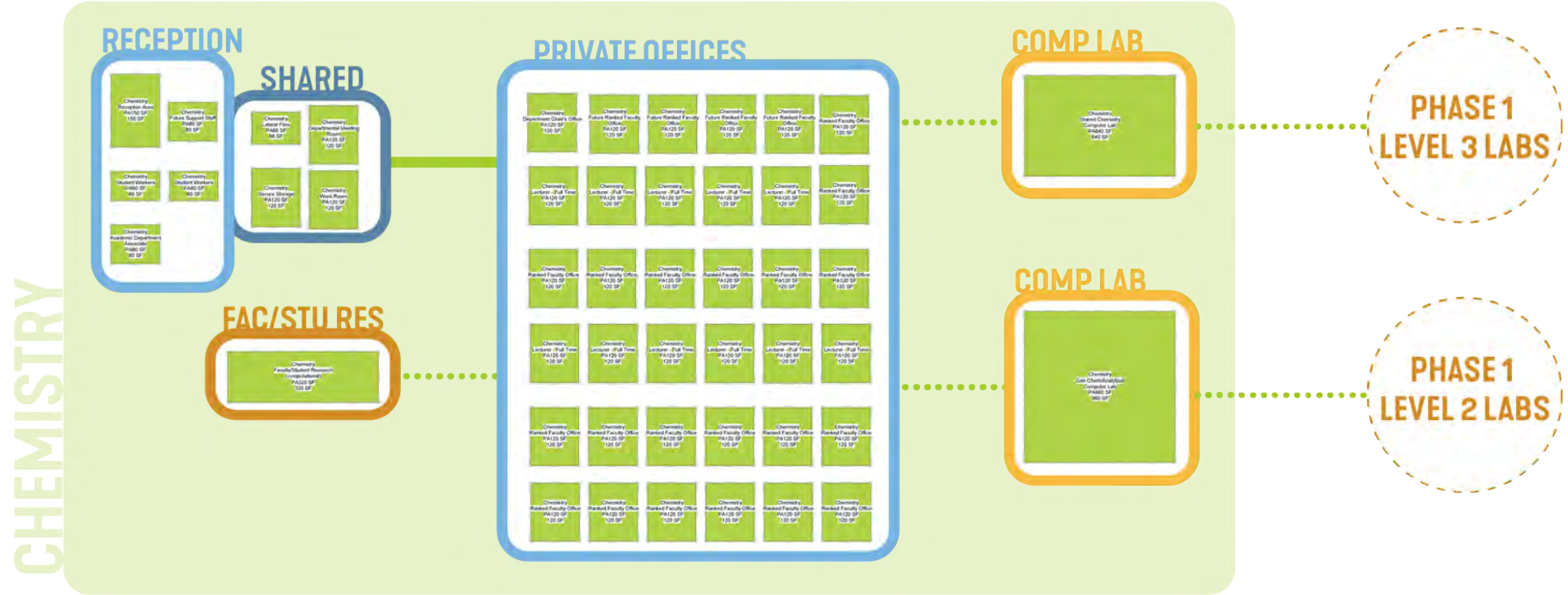

# PROGRAM OVERVIEW

## CLASSROOMS

- Increased 72-seat Active Learning to 84-seat (+456 ASF)
- Added (2) 84-seat Active Learning (+6,384 ASF)
- Increased 80-seat classrooms to 100-seat (+960 ASF)
- Changed 150 seat fixed theater style classroom to fixed tables and moveable chairs (+2,700 ASF)
- Delta = +10,500 ASF

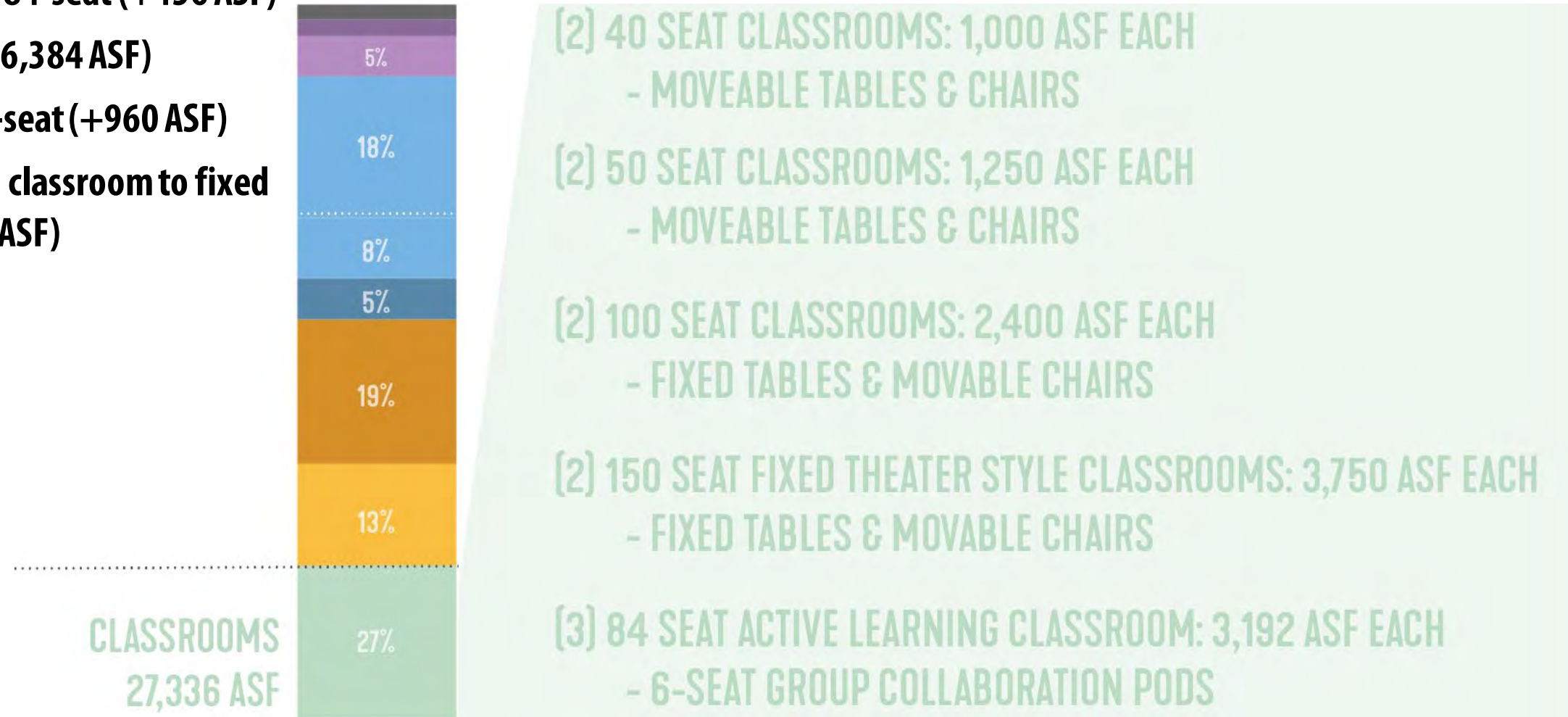

# ADJACENCIES

## CLASSROOMS

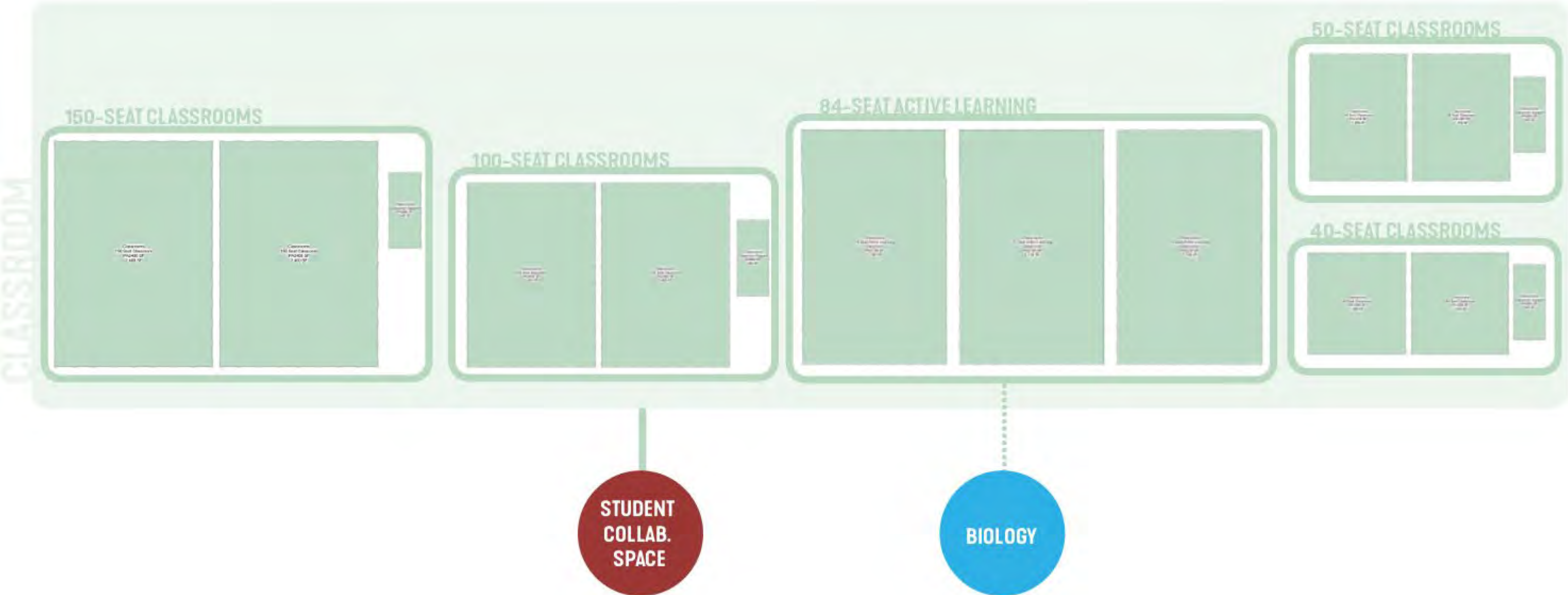



# PROGRAM OVERVIEW

## MISC. INSTRUCTIONAL SUPPORT

- Recategorized Student Organization Space (+0 ASF)
- Recategorized Faculty Resource Centers (+0 ASF)
- Renamed Maker Space to CS Engineering Lab (+0 ASF)
- Resizing to match module (+196 ASF)
- Removed (1) extra Science Ed Support Space (-640 ASF)
- Enlarged Science Ed Lab (+250)
- Delta = -194 ASF

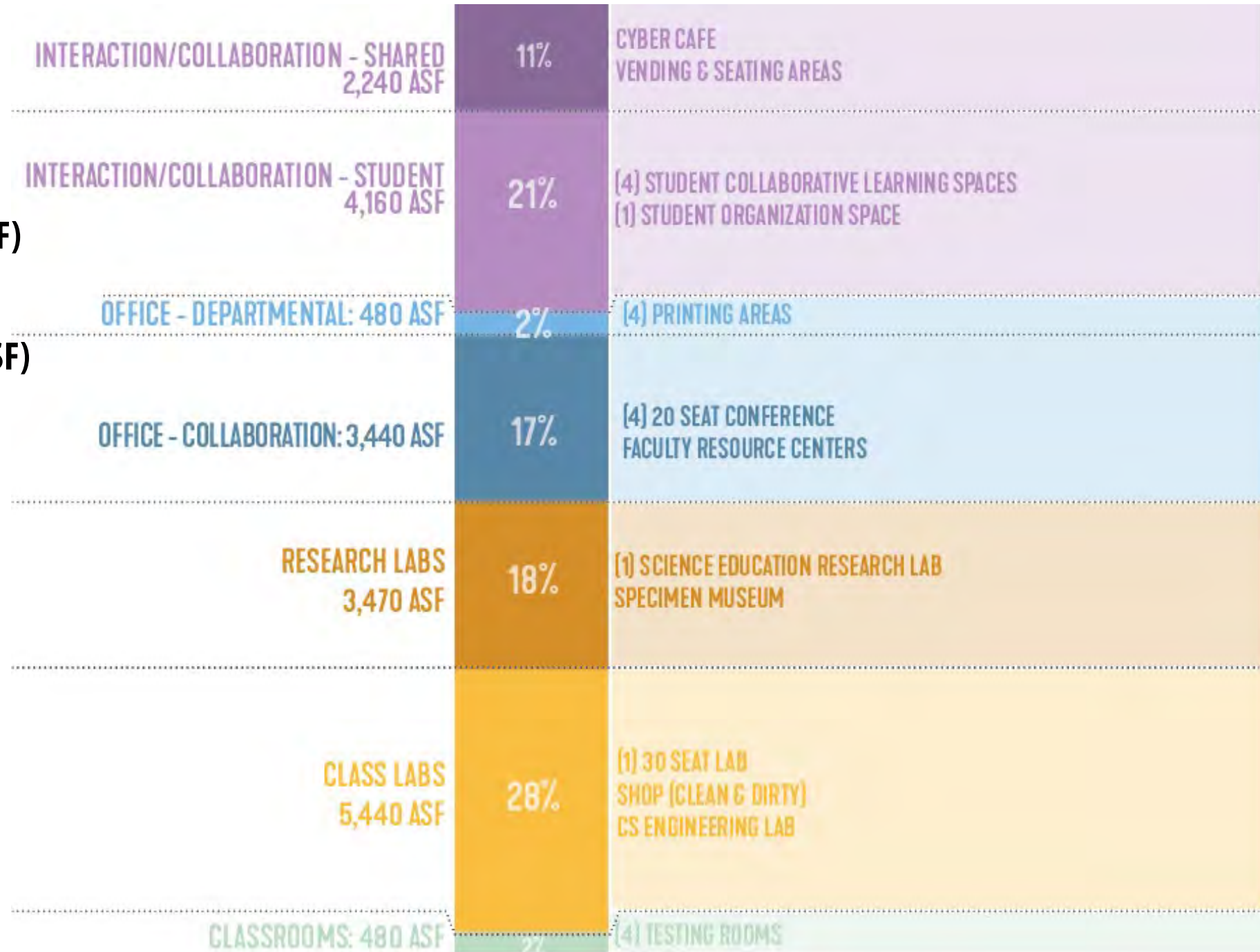

# ADJACENCIES

MISC. INSTRUCTIONAL & SUPPORT

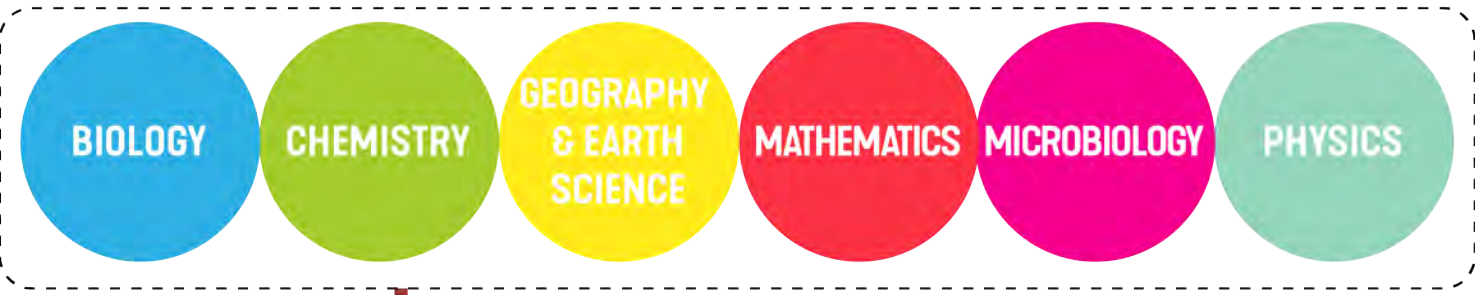

MISC. INSTRUCT. & SUPP.

## FACULTY COLLAB.



## VENDING/SEATING



## STUDENT COLLAB.



## SPECIMEN MUSEUM

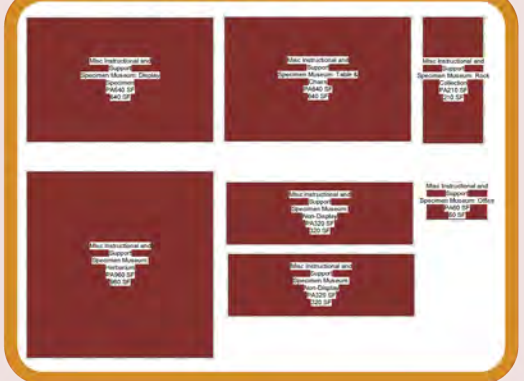

## TESTING



## SCIENCE ED



## CS ENGINEERING LAB



## STU. ORG.



## CYBER CAFE



# PLANNING OPPORTUNITIES

- THE LINK
- DEPARTMENTAL SPACE ORGANIZATION



# THE LINK

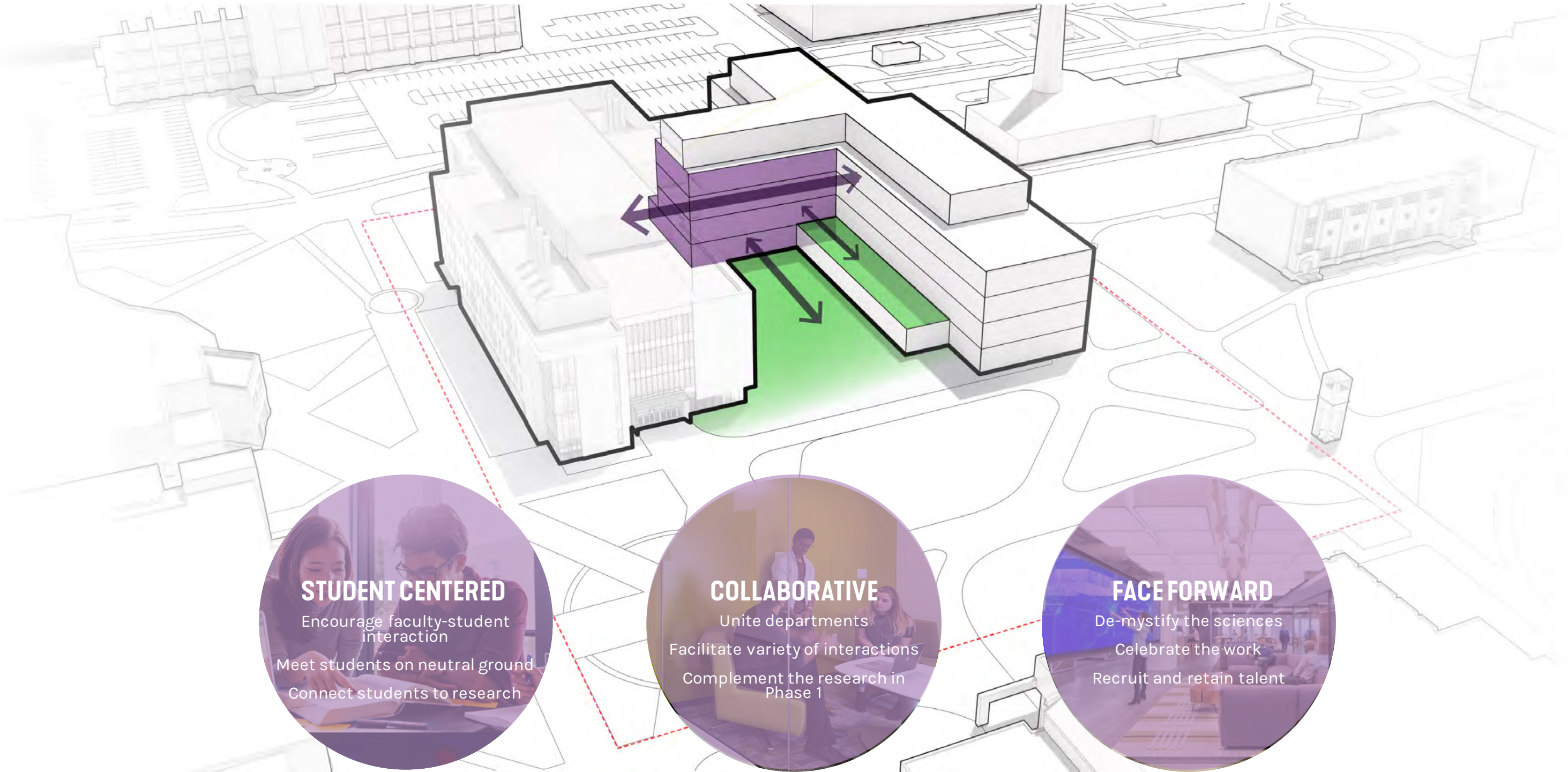

**STUDENT CENTERED**  
Encourage faculty-student interaction  
Meet students on neutral ground  
Connect students to research

**COLLABORATIVE**  
Unite departments  
Facilitate variety of interactions  
Complement the research in Phase 1

**FACE FORWARD**  
De-mystify the sciences  
Celebrate the work  
Recruit and retain talent



# THE LINK

WHAT VALUE DOES THE LINK BETWEEN PHASE 1 AND 2 PROVIDE?

LINKS RESEARCH LABS WITH STUDENTS

DAYLIGHT AND REPRIEVE FROM ENCLOSED LAB

SCIENCE ON DISPLAY

INCLUSIVE DESIGN

INFORMAL, NEUTRAL, & VARIED GATHERING SPACE

THE HEART OF THE BUILDING = STUDENT-CENTRIC

ACTIVATED WITH CLASSROOMS AND COLLABORATIVE SPACE

DIRECT CONNECTION TO COURTYARD AND ROOF TERRACE

# THE LINK



19G1J Prairie Springs Science Center Phase II



# THE LINK

## MEANINGFUL CONNECTION TO ROOF TERRACE





# THE LINK





# THE LINK

## TREEHOUSE PORCH





# DEPARTMENTAL OFFICES

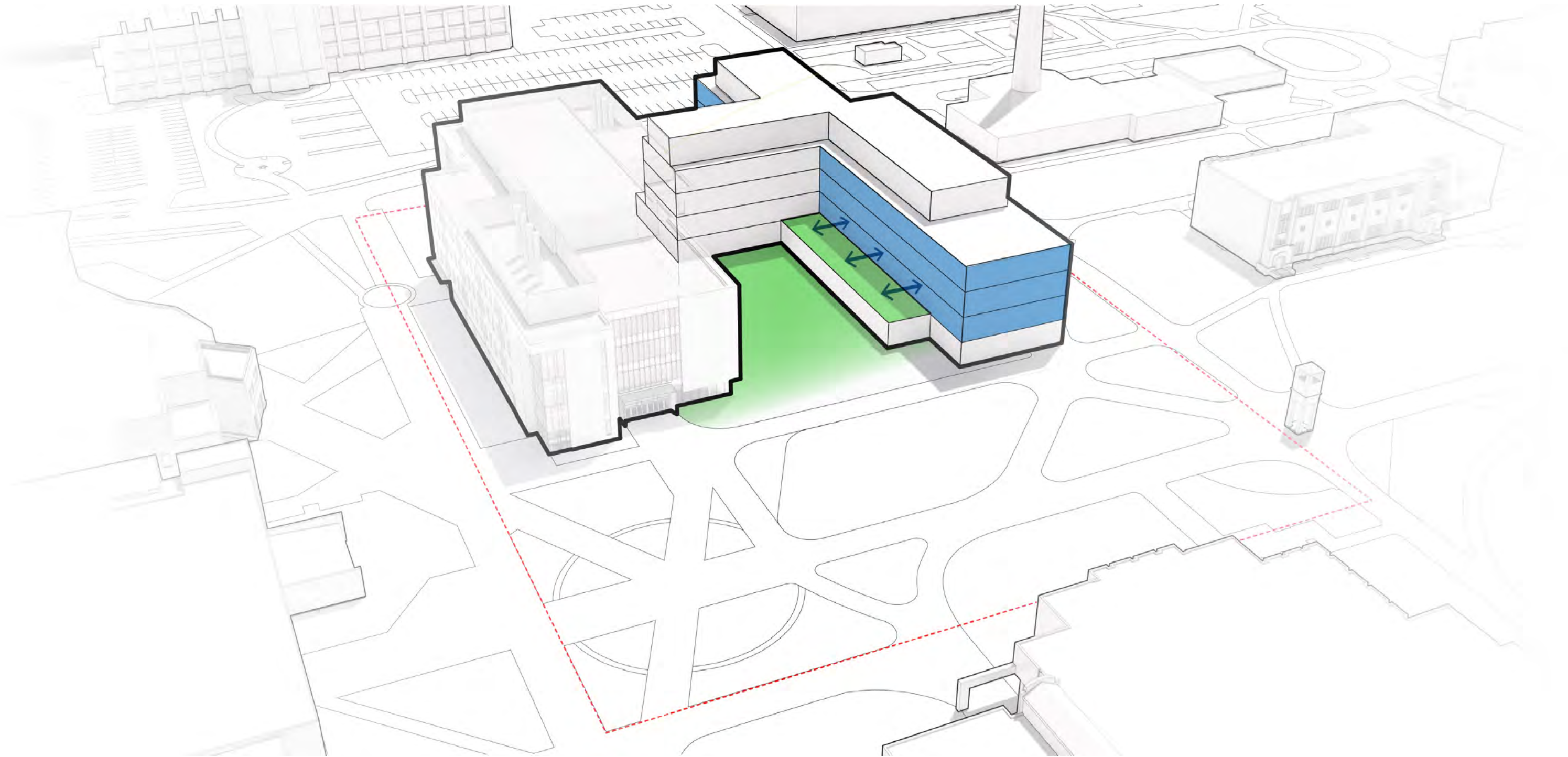

# DEPARTMENTAL OFFICES

HOW DO YOU ENVISION DEPARTMENTAL SPACE TO BE ORGANIZED?

NOT A FORMAL SUITE,  
OPEN AND WELCOMING

EASY TO FIND FACULTY

STUDENTS NEED TO KNOW  
WHERE TO GO

DEPARTMENT FACULTY UNITED

OPPORTUNITY FOR  
IMPROMPTU COLLABORATION  
INTEGRATED WITH OFFICES

EQUITY IN OFFICING

EMBED NEUTRAL MEETING  
ZONES WITHIN  
DEPARTMENTAL OFFICE  
SUITES

FLEXIBILITY, EASY  
ADAPTABILITY

# OFFICE STRATEGY



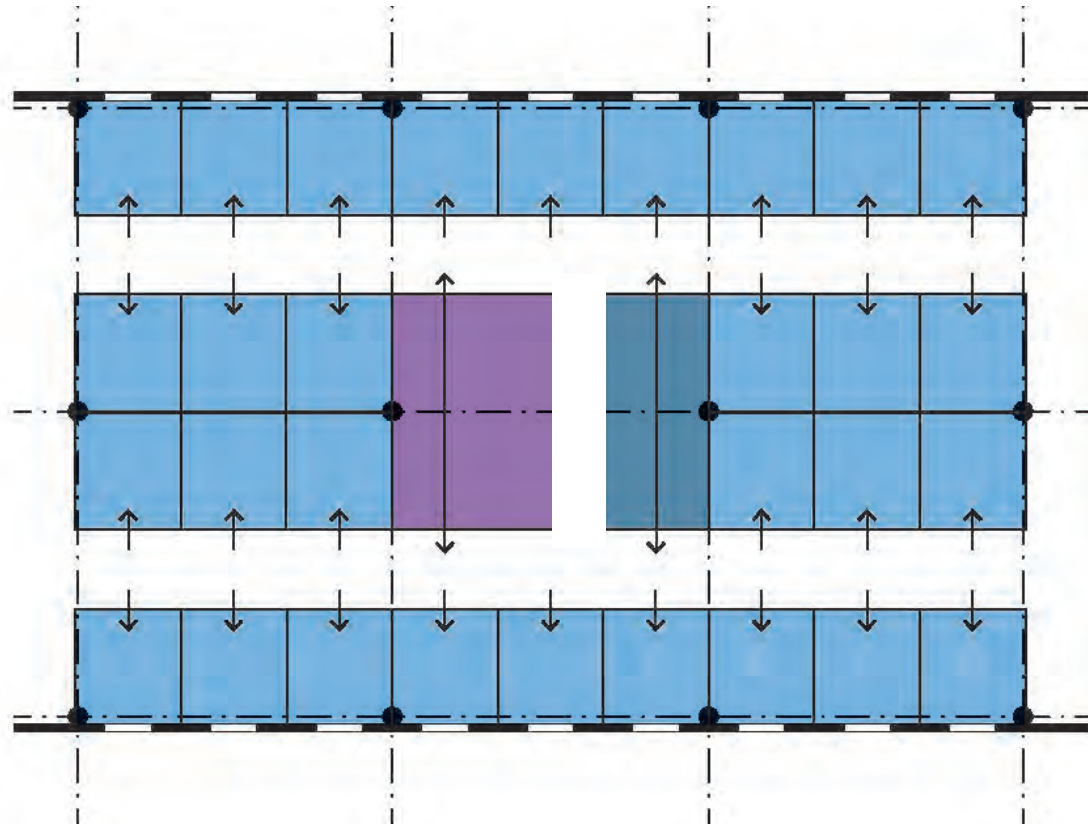

## ORGANIZATIONAL MODELS

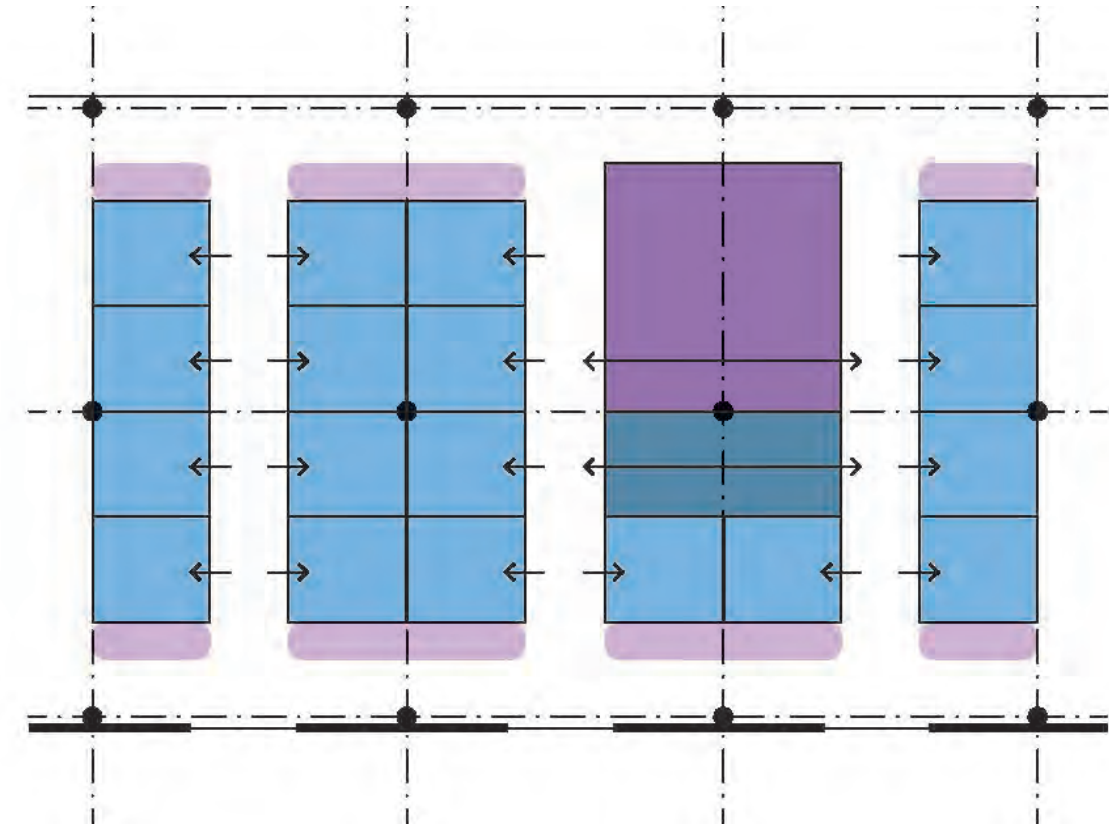

**OPTION 1**  
(AS DEPICTED IN 10% CONCEPT REPORT)

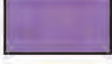

**OPTION 2**

-  PRIVATE OFFICE
-  OFFICE SUPPORT - WORKROOMS / STORAGE / ETC.
-  ENCLOSED COLLABORATIVE - CONFERENCE / FACULTY RESOURCE / ETC.
-  OPEN COLLABORATIVE - WRITABLE WALL HUDDLE / NEUTRAL MEETING



# OFFICE STRATEGY

## OPTION 1

60 PRIVATE OFFICES PER FLOOR

\*SHARED OFFICES FOR PART TIME LECTURERS AND HOTELING OFFICES FOR LAB MANAGERS WITH SPACE IN PHASE 1 ARE CONSIDERED PART OF 'ENCLOSED COLLABORATIVE' SPACE TYPE FOR THIS ANALYSIS

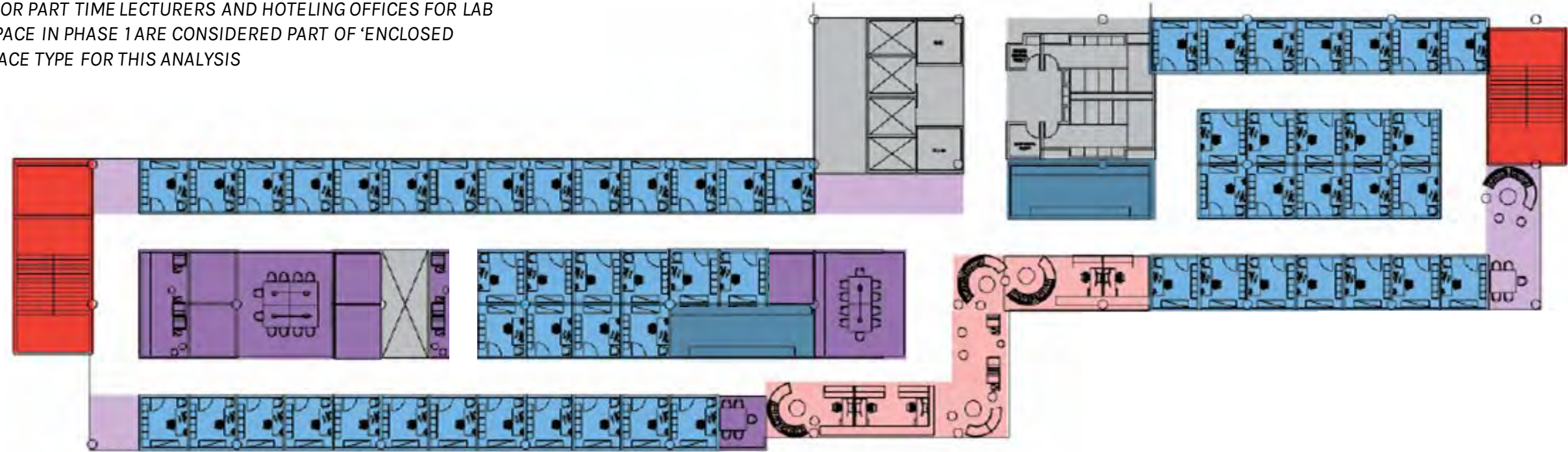

-  PRIVATE OFFICE
-  OFFICE SUPPORT  
WORKROOMS / STORAGE / ETC.
-  ENCLOSED COLLABORATIVE  
CONFERENCE / FACULTY RESOURCE / ETC.
-  OPEN COLLABORATIVE  
WRITABLE WALL HUDDLE / NEUTRAL MEETING
-  RECEPTION
-  STAIRS
-  BUILDING SUPPORT  
TOILETS, MECH SHAFTS, ELEC/IT/AV ROOMS, ETC.

# INTERIOR EXPERIENCE

## OPTION 1

\*THIS RENDERING DOES NOT REPRESENT FINAL DESIGN. ALTERNATE OPTIONS FOR MEETING OFFICE GLAZING GUIDELINES WILL BE EXPLORED, INCLUDING BUT NOT LIMITED TO: SOLID DOOR PANEL WITH GLAZED SIDELIGHTS ONLY, TRANSOM WINDOWS, ALTERNATE TRANSLUCENT GLAZING PATTERNS, AND GLAZING THAT DOES NOT EXTEND TO THE FLOOR.





# OFFICE STRATEGY

## OPTION 2

60 PRIVATE OFFICES PER FLOOR

\*SHARED OFFICES FOR PART TIME LECTURERS AND HOTELING OFFICES FOR LAB MANAGERS WITH SPACE IN PHASE 1 ARE CONSIDERED PART OF 'ENCLOSED COLLABORATIVE' SPACE TYPE FOR THIS ANALYSIS

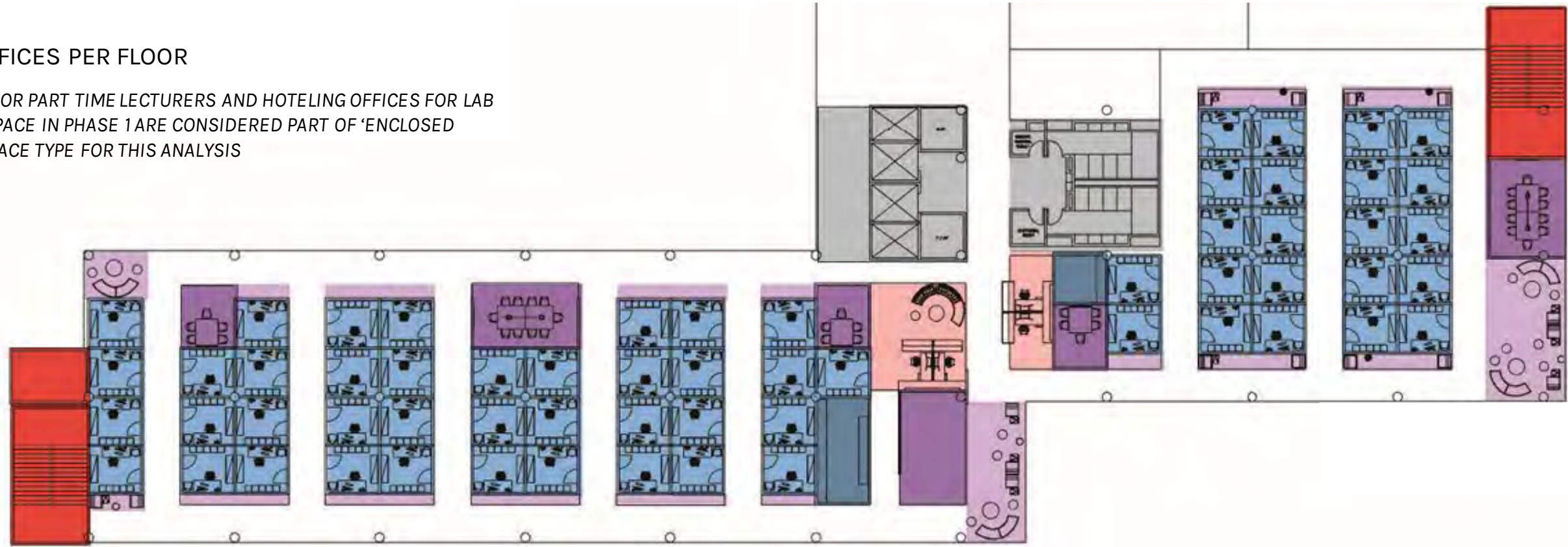

-  PRIVATE OFFICE
-  OFFICE SUPPORT  
WORKROOMS / STORAGE / ETC.
-  ENCLOSED COLLABORATIVE  
CONFERENCE / FACULTY RESOURCE / ETC.
-  OPEN COLLABORATIVE  
WRITABLE WALL HUDDLE / NEUTRAL MEETING
-  RECEPTION
-  STAIRS
-  BUILDING SUPPORT  
TOILETS, MECH SHAFTS, ELEC/IT/AV ROOMS, ETC.



# INTERIOR EXPERIENCE

## OPTION 2

\*THIS RENDERING DOES NOT REPRESENT FINAL DESIGN. ALTERNATE OPTIONS FOR MEETING OFFICE GLAZING GUIDELINES WILL BE EXPLORED, INCLUDING BUT NOT LIMITED TO: SOLID DOOR PANEL WITH GLAZED SIDELIGHT ONLY, TRANSOM WINDOWS, ALTERNATE TRANSLUCENT GLAZING PATTERNS, AND GLAZING THAT DOES NOT EXTEND TO THE FLOOR. ALTERNATES TO THE WRITABLE SURFACE SHOWN WILL ALSO BE EXPLORED INCLUDING WRITABLE GLASS AND WHITEBOARDS.



# INTERIOR EXPERIENCE

## OPTION 2

\*THIS RENDERING DOES NOT REPRESENT FINAL DESIGN. ALTERNATE OPTIONS FOR MEETING OFFICE GLAZING GUIDELINES WILL BE EXPLORED, INCLUDING BUT NOT LIMITED TO: SOLID DOOR PANEL WITH GLAZED SIDELIGHT ONLY, TRANSOM WINDOWS, ALTERNATE TRANSLUCENT GLAZING PATTERNS, AND GLAZING THAT DOES NOT EXTEND TO THE FLOOR. ALTERNATES TO THE WRITABLE SURFACE SHOWN WILL ALSO BE EXPLORED INCLUDING WRITABLE GLASS AND WHITEBOARDS.





# OFFICE STRATEGY

## PROS AND CONS

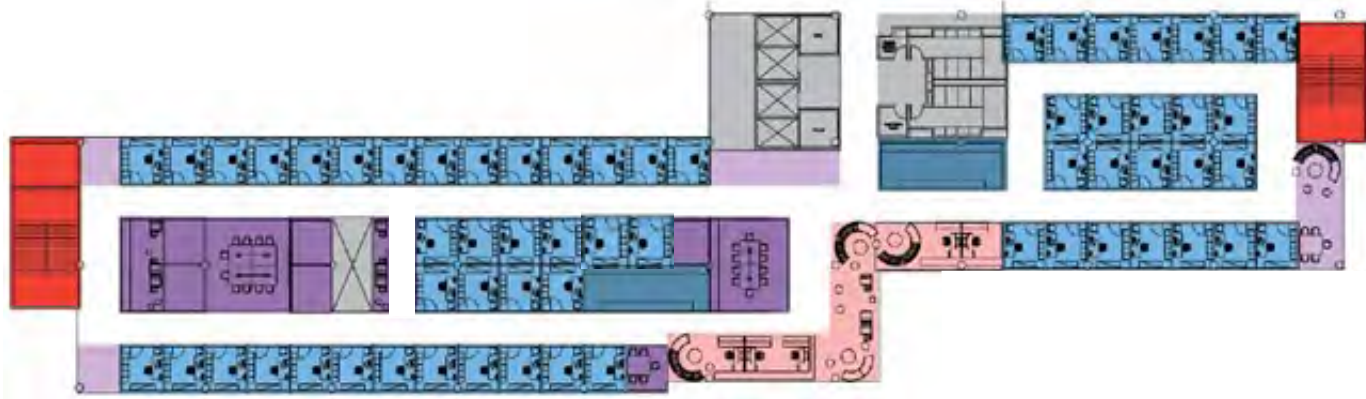

### OPTION 1

MOST EFFICIENT  
STATUS QUO

1/3 OF OFFICES HAVE LIMITED ACCESS TO DAYLIGHT & NO VIEW TO OUTSIDE  
LIMITED FLEXIBILITY OVER THE LONG TERM  
LIMITED ACCESS TO COLLABORATION ZONES  
LESS PRIVACY (ALL OFFICES ARE ON A PRIMARY CORRIDOR)  
INTIMIDATING

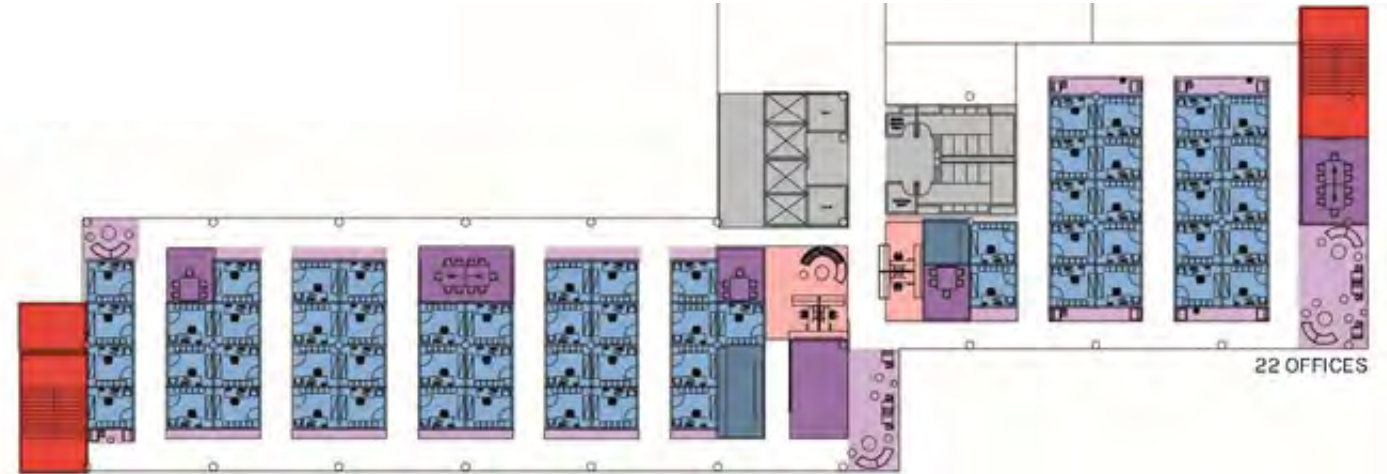

### OPTION 2

ALL OFFICES ARE EQUALLY DESIREABLE  
DAYLIGHT PENETRATES TO THE CENTER OF THE FLOOR  
VIEWS OUTSIDE ARE AVAILABLE TO ALL VIA CORRIDORS & COLLABORATION AREAS  
MORE OPEN AND WELCOMING FOR STUDENTS  
NEUTRAL MEETING AND COLLABORATIVE ZONES DISTRIBUTED THROUGHOUT  
FLEXIBLE MODULE CAN BE ADAPTED OVER TIME  
INCREASED PRIVACY (OFFICES ARE CLUSTERED ON CROSS CORRIDORS)

LESS EFFICIENT  
CULTURAL SHIFT

# DAYLIGHTING ANALYSIS

\*DAYLIGHT STUDIES BASED UPON GLAZING EXTENTS SHOWN IN RENDERINGS IN THIS DOCUMENT TO PROVIDE A BASELINE POINT OF COMPARISON BETWEEN DAYLIGHT PENETRATION IN OPTION 1 AND OPTION 2.

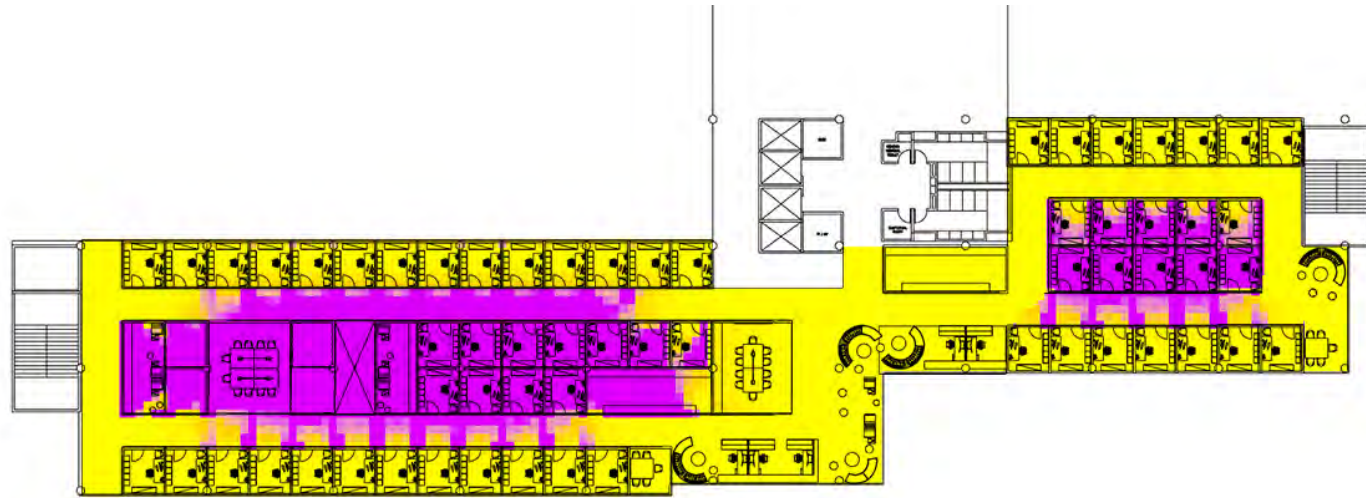

## OPTION 1

INTERNAL OFFICES AND CORRIDORS HAVE LIMITED ACCESS TO DAYLIGHT

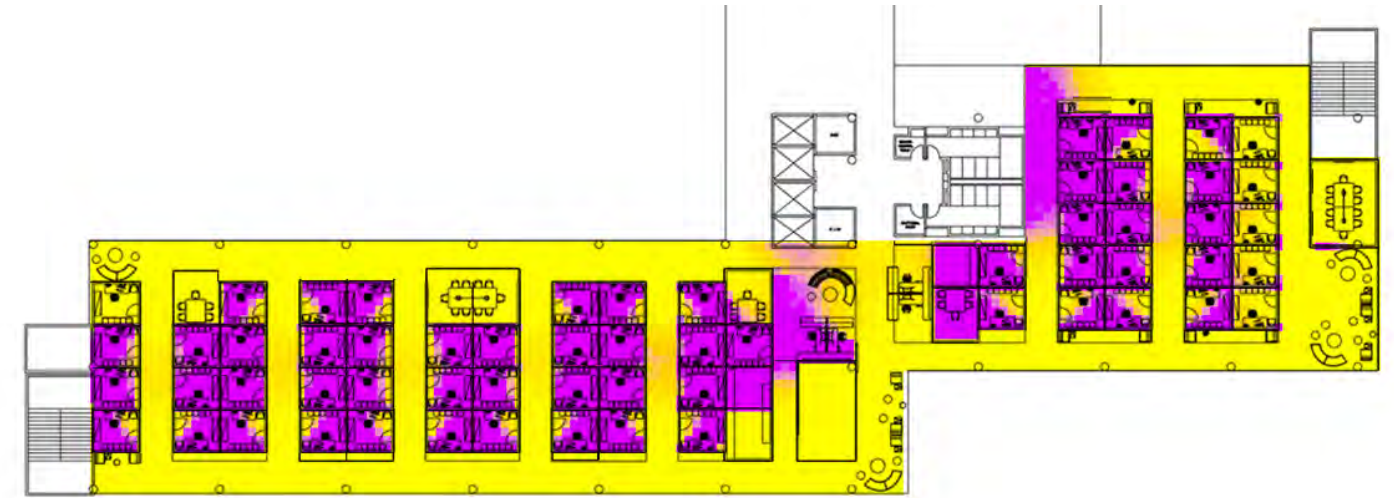

## OPTION 2

CORRIDORS AND COLLABORATIVE ZONES HAVE FULL EXPOSURE TO DAYLIGHT

CDA (%)

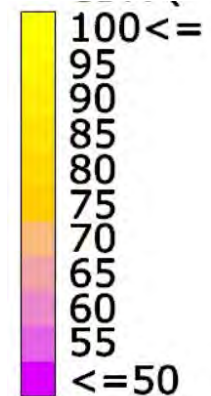

\*CONTINUOUS DAYLIGHT AUTONOMY (CDA) IS THE ANNUAL PERCENTAGE OF TIME THE SPACE'S REQUIRED LIGHTING LEVELS CAN BE ACHIEVED BY DAYLIGHTING ALONE



# OFFICE STRATEGY

## INTERIOR EXPERIENCE

\*THESE RENDERINGS DO NOT REPRESENT FINAL DESIGN. ALTERNATE OPTIONS FOR MEETING OFFICE GLAZING GUIDELINES WILL BE EXPLORED, INCLUDING BUT NOT LIMITED TO: SOLID DOOR PANEL WITH GLAZED SIDELIGHT ONLY, TRANSOM WINDOWS, ALTERNATE TRANSLUCENT GLAZING PATTERNS, AND GLAZING THAT DOES NOT EXTEND TO THE FLOOR. ALTERNATES TO THE WRITABLE SURFACE SHOWN WILL ALSO BE EXPLORED INCLUDING WRITABLE GLASS AND WHITEBOARDS.



OPTION 1



OPTION 2

# TYPICAL PRIVATE OFFICE

## REQUIREMENTS

TO PROMOTE PASSIVE ILLUMINATION VIA DAYLIGHTING, THE NEW SUSTAINABILITY GUIDELINES REQUIRE ALL OFFICES **WITH A DEDICATED EXTERIOR WINDOW** TO BE 50% GLASS ON THE WALL FACING THE CORRIDOR.

THE GLASS CAN BE OBSCURED WITH FROST OR CERAMIC FRIT TO PROVIDE VISUAL PRIVACY WHILE STILL EMITTING DAYLIGHT. (EXAMPLES PROVIDED BELOW)

*\*OFFICE FURNITURE LAYOUT FOR REFERENCE ONLY  
\*DOOR AND SIDE LIGHT DETAILS FOR REFERENCE ONLY*

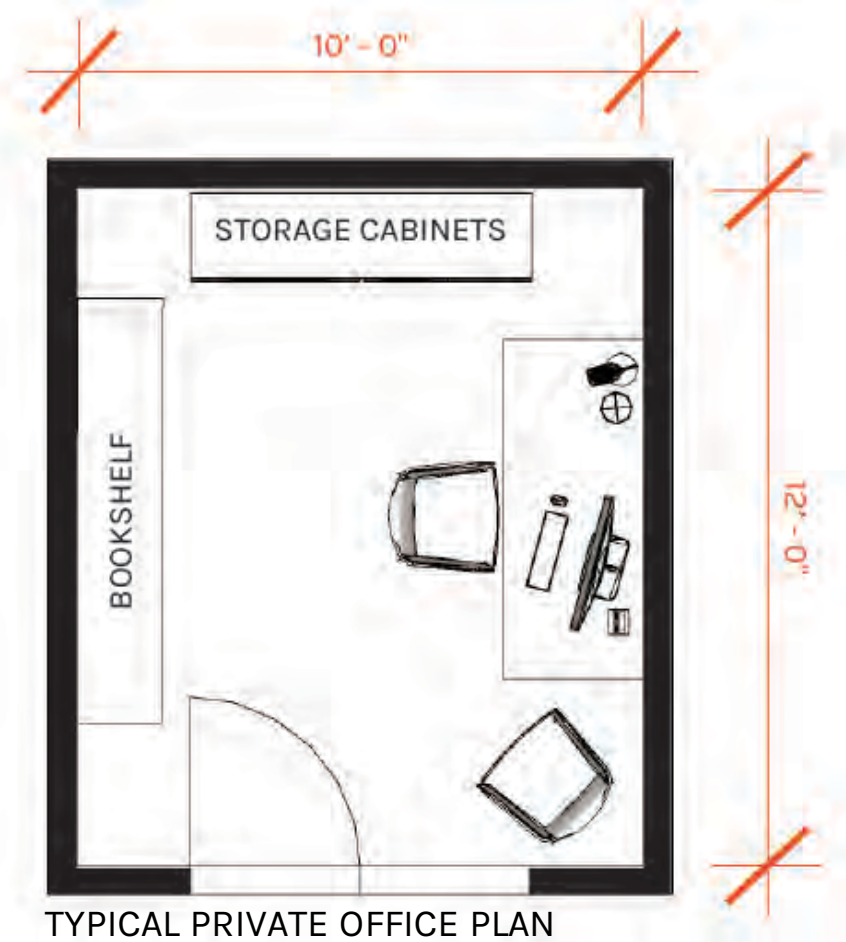
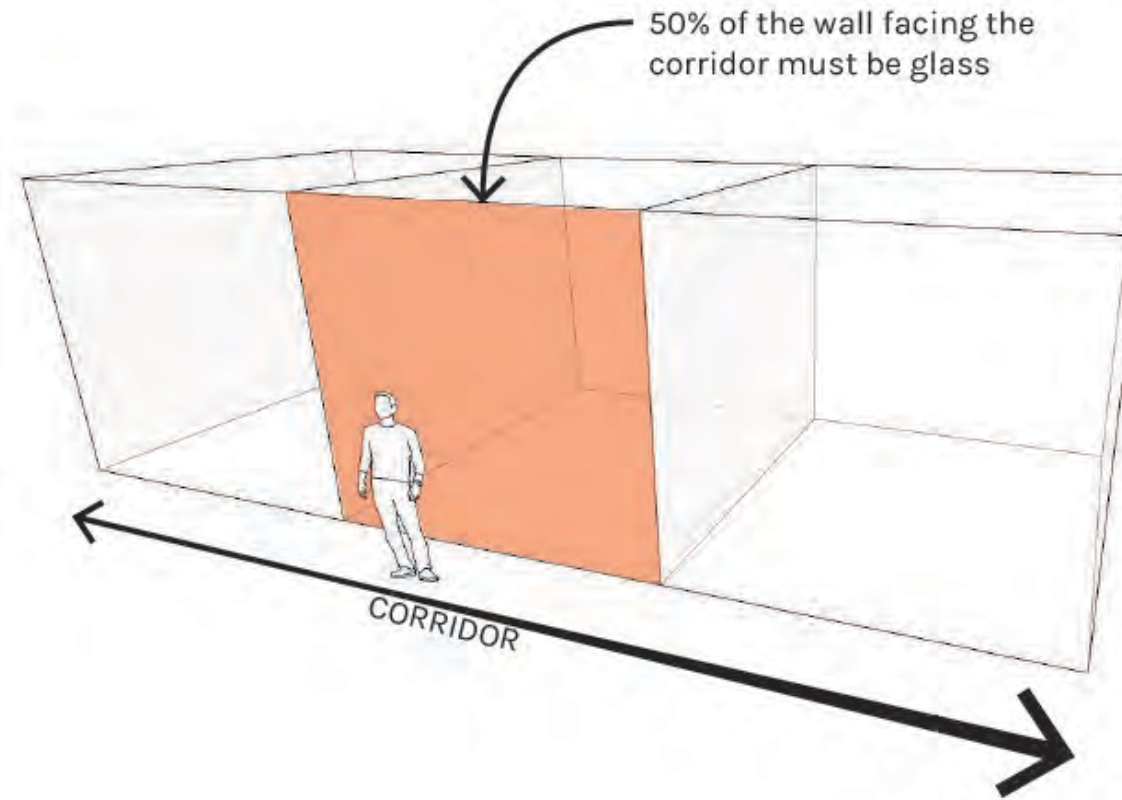

### EXAMPLES OF OBSCURE GLASS FOR REFERENCE:

LIGHT FROST

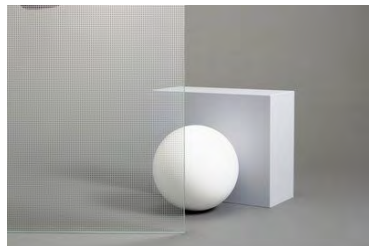

HEAVY FROST

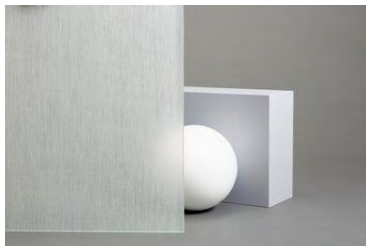

HEAVY FROST + PATTERN

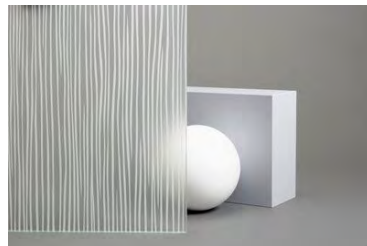

OPAQUE

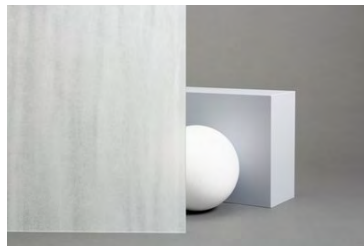





**STUDENT CENTERED**

Encourage faculty-student interaction

Meet students on neutral ground

Connect students to research

**COLLABORATIVE**

Unite departments

Facilitate variety of interactions

Complement the research in Phase 1

**FACE FORWARD**

De-mystify the sciences

Celebrate the work

Recruit and retain talent

# TECHNOLOGY

UW-LA CROSSE  
EAGLES

