



# PROGRAMMING - Math & Science Education Spaces

February 3, 2021

# Agenda

---

- **Project Vision**
- **Program Review**
- **2017 Guideplate Review**



PHASE I  
**PLATFORM**

**PROMISE**

PHASE II  
**COMMUNITY**

# PROJECT VISION



## STUDENT CENTERED

Encourage faculty-student interaction  
Meet students on neutral ground  
Connect students to research



## COLLABORATIVE

Unite departments  
Facilitate variety of interactions  
Complement the research in Phase 1



## FACE FORWARD

De-mystify the sciences  
Celebrate the work  
Recruit and retain talent

# PRAIRIE SPRING SCIENCE CENTER IN PHASES - UNITS

2021 UPDATE

- RIVER STUDIES CENTER
- RADIATION CENTER
- PHYSICS
- MISC. INSTR. / SUPPORT
- MICROBIOLOGY
- MATHEMATICS
- GEOGRAPHY & EARTH SCIENCE
- DEAN'S OFFICE
- CORE LABS
- CLASSROOMS
- CHEMISTRY
- BUILDING SUPPORT
- BIOLOGY

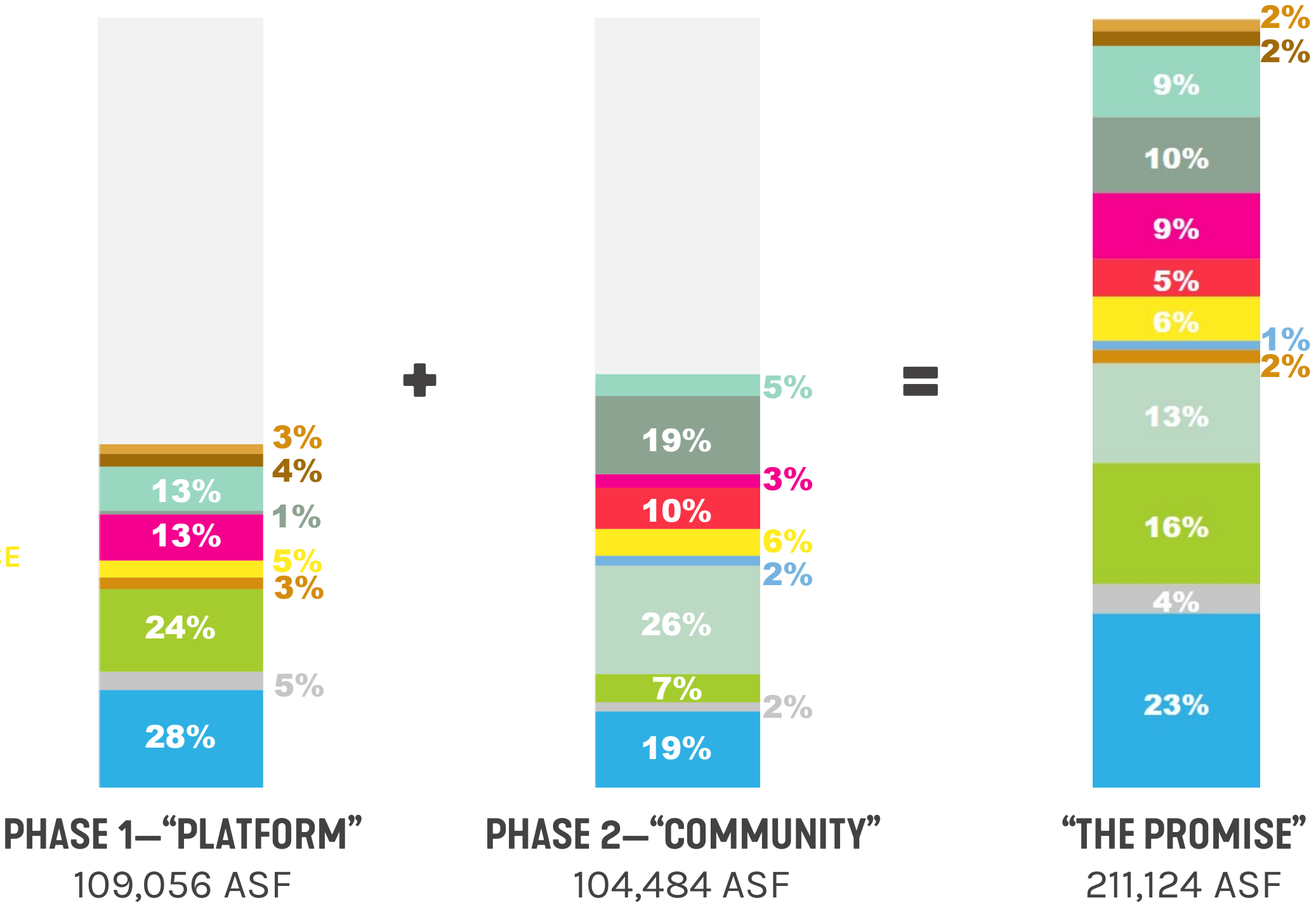

# PRAIRIE SPRING SCIENCE CENTER IN PHASES – SPACE TYPES

2021 UPDATE

- BUILDING SUPPORT
- SHARED – COLLABORATION
- STUDENT – COLLABORATION
- OFFICE – FACULTY
- OFFICE – DEPARTMENTAL
- OFFICE – COLLABORATION
- CORE LAB
- RESEARCH LABS
- CLASS LABS
- CLASSROOMS

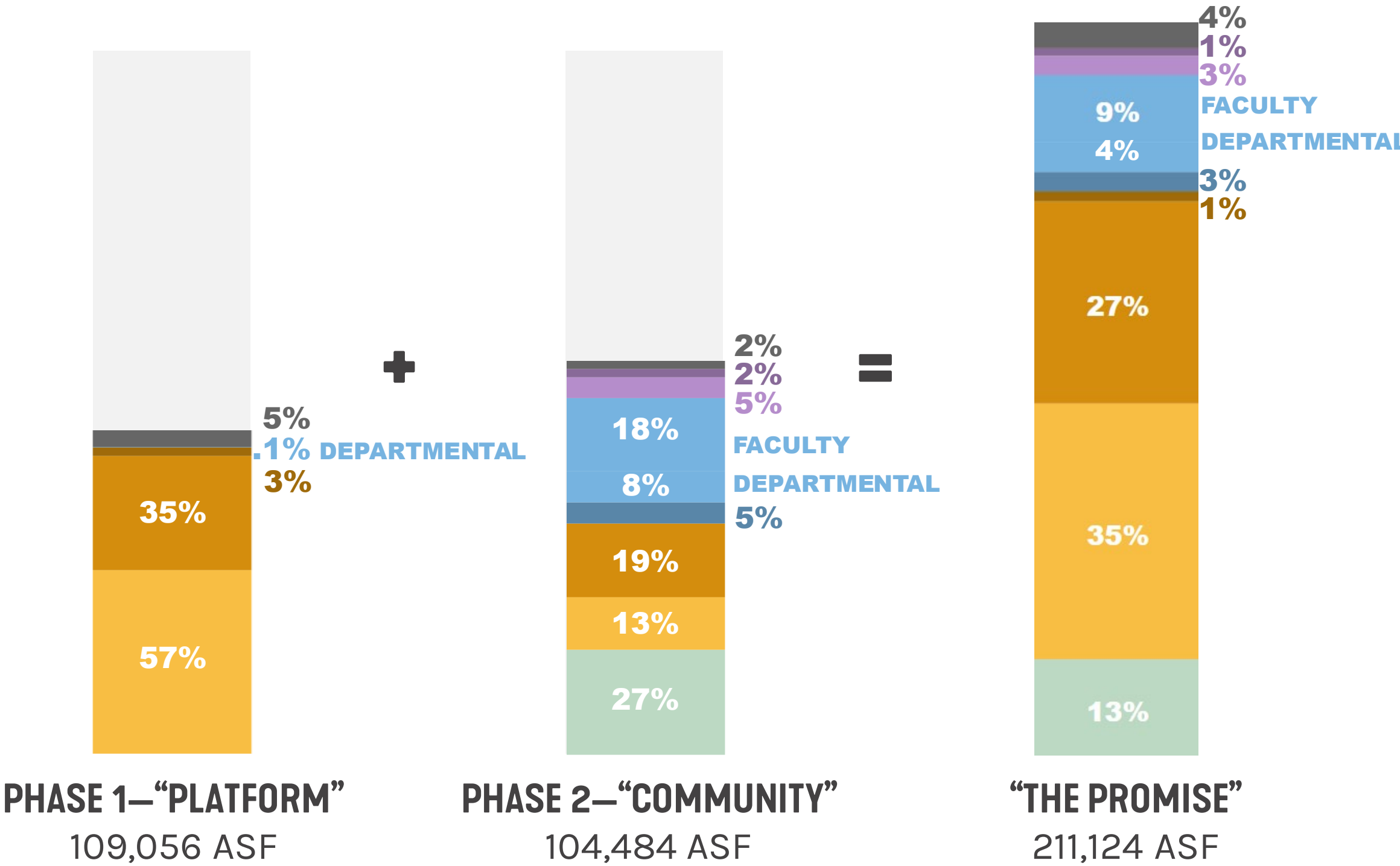

# EDUCATION METHODS PROGRAM

## WHAT WE HEARD

### Planning Priorities & Drivers

- Locate math ed and science ed in close proximity on the same level
- Right-size the amount of visibility into the teaching spaces

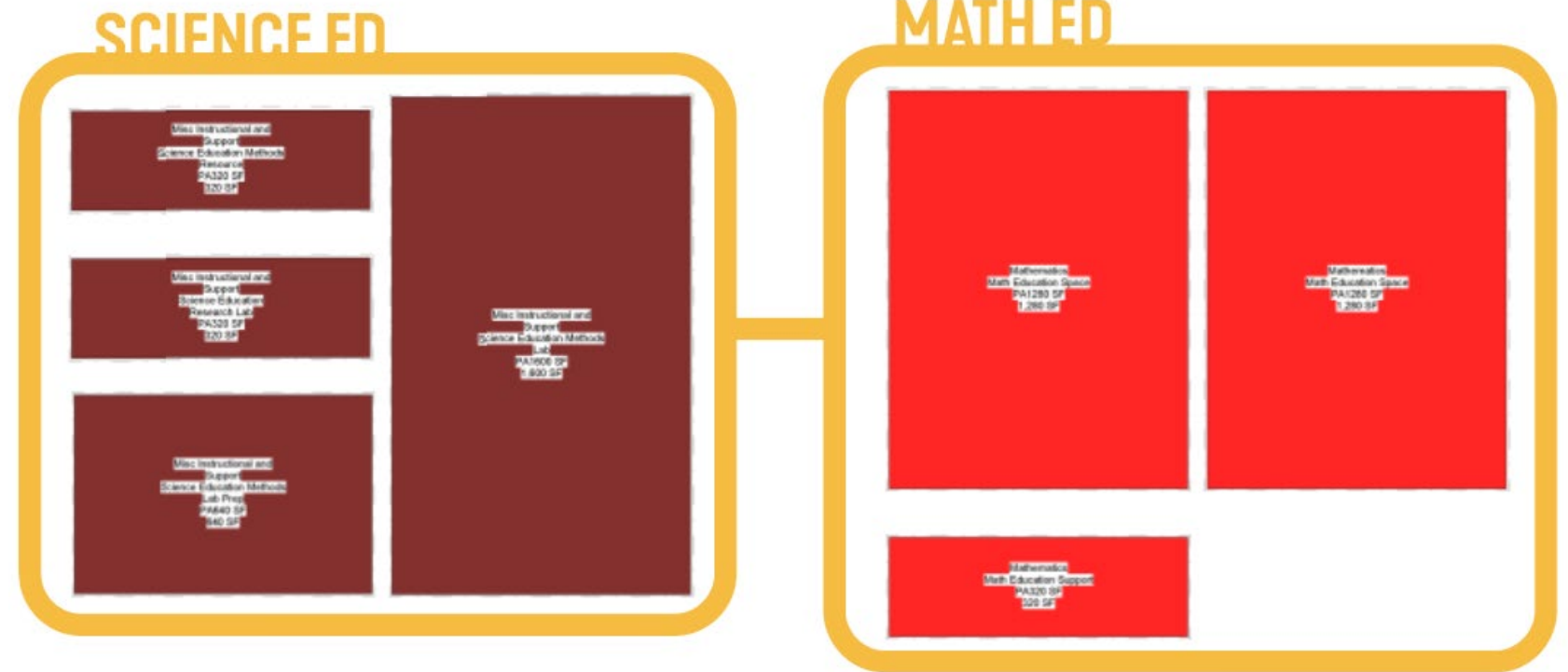

# EDUCATION METHODS PROGRAM

UNIT	ROOM NAME	NO. OF OCC.	ASF / OCC	ASF / SPACE	NO. OF SPACES	TOTAL PROGRAM AREA
<b>Mathematics</b>	Math Education Space	36	36	1,280	2	2,560
<b>Mathematics</b>	Math Education Storage	1	120	120	1	120
<b>Mathematics</b>	Math Education Support	1	320	320	1	320
<b>Misc. Instructional / Support</b>	Science Education Methods Lab	32	50	1,600	1	1,600
<b>Misc. Instructional / Support</b>	Science Education Methods Lab Prep			640	1	640
<b>Misc. Instructional / Support</b>	Science Education Methods Resource	4	80	320	1	320
<b>Misc. Instructional / Support</b>	Science Education Research Lab	4	80	320	1	320



# MATHEMATICS EDUCATION METHODS

## WHAT WE HEARD

- **Movable furniture**
- **4-5 seat pods**
- **One lab for primary education, one for secondary**
- **No change in size from previous program**
- **Adjacency, same floor as Science Methods required**

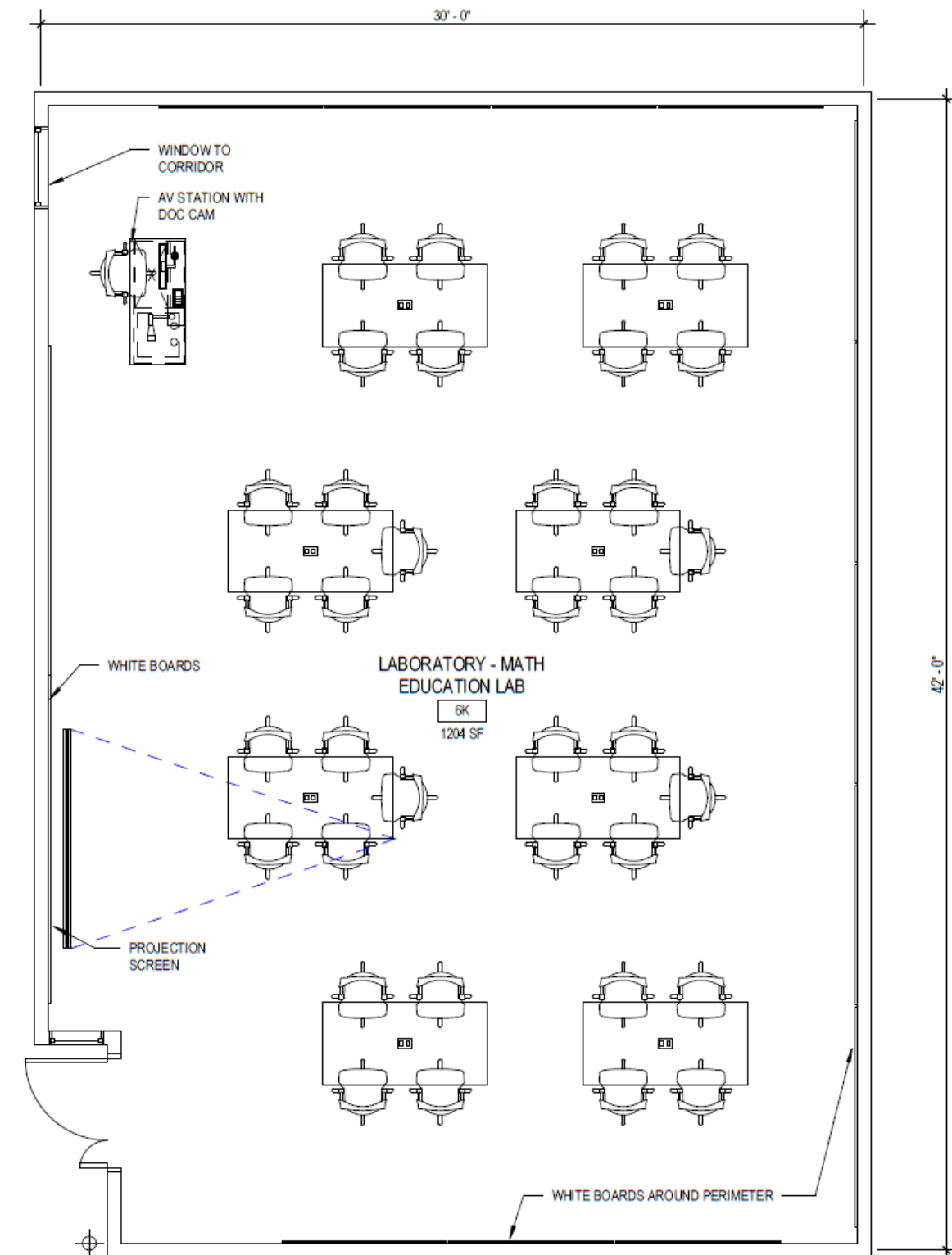

# MATHEMATICS EDUCATION METHODS

## WHAT WE HEARD

- **Support**
  - 2 workstations
  - Needs to be lockable
- **Storage Room**
  - Mix of storage for books and manipulatives
- **No change in size from previous program**

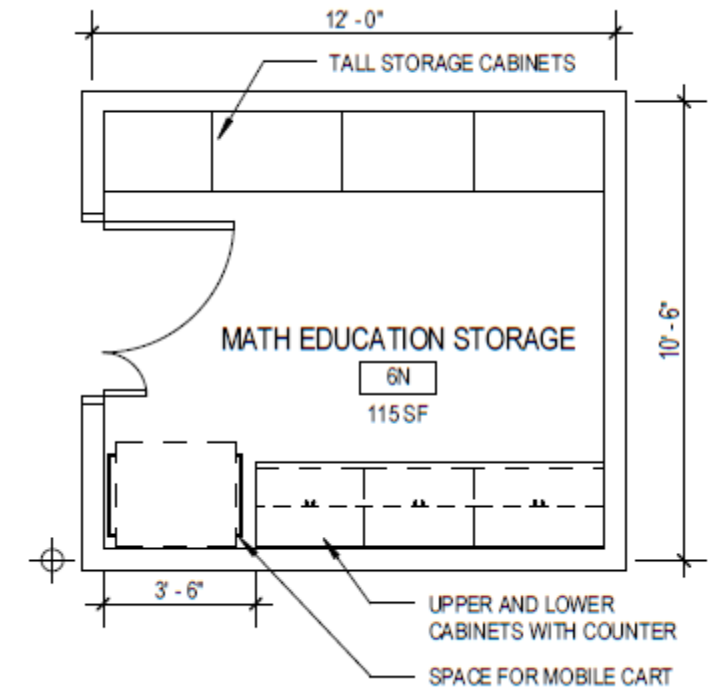
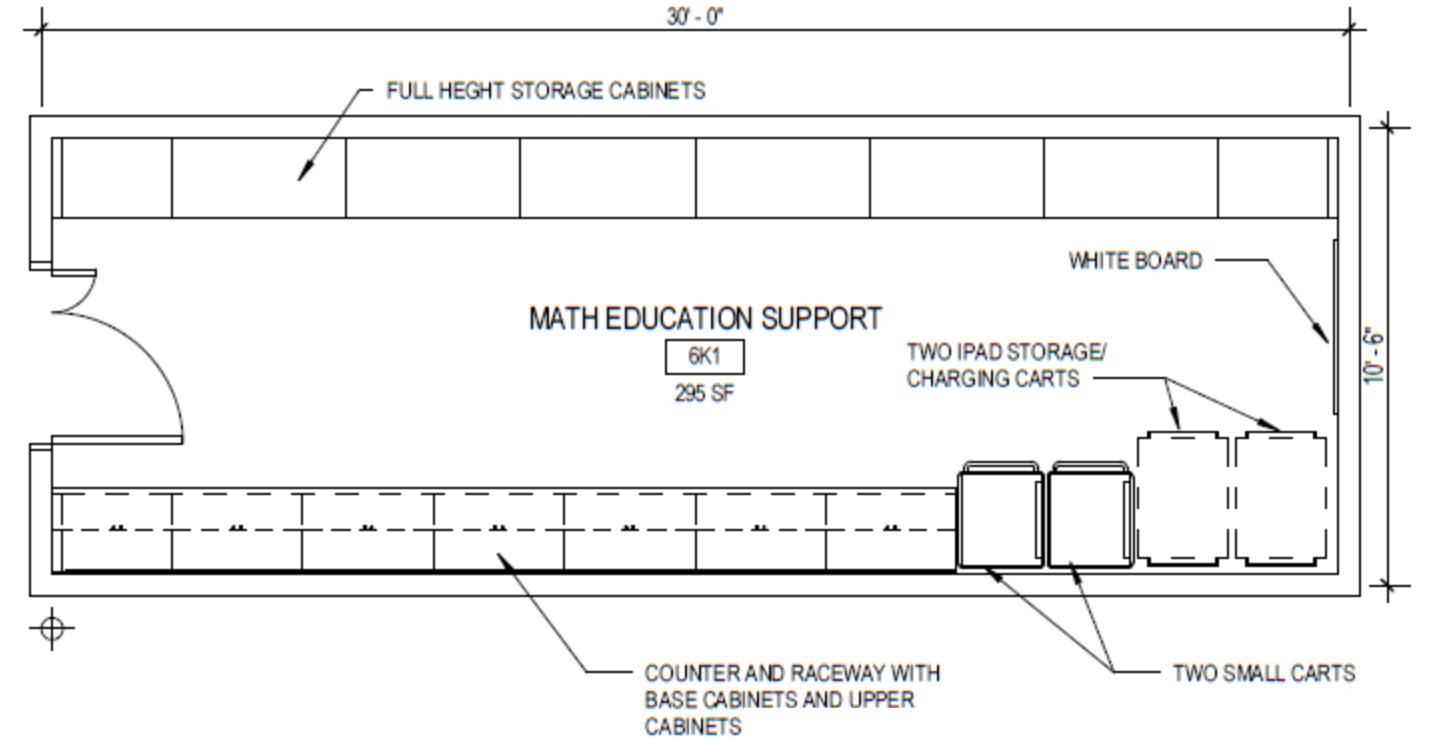

# SCIENCE EDUCATION METHODS

## WHAT WE HEARD

- **Science education needs**
  - **Smartboard**
  - **Horseshoe configuration**
  - **Power for laptops**
  - **Whiteboards and tackboards all walls**
  - **Movable instructor podium**
- **Nutrition needs**
  - **Undertable rolling storage cabinets**
  - **Kitchen 3-basin sink with drainboards both sides**
  - **Eange, stove, refrigerator, cabinets for dishes**
  - **Power at tables configured as group pods**
  - **One perimeter counter for placing finished product**
- **Enlarge to accommodate more casework and equipment for nutrition and pod seating setup**
- **Doors can be 3'-0"**
- **Adjacency, same floor as Mathematics Methods required**

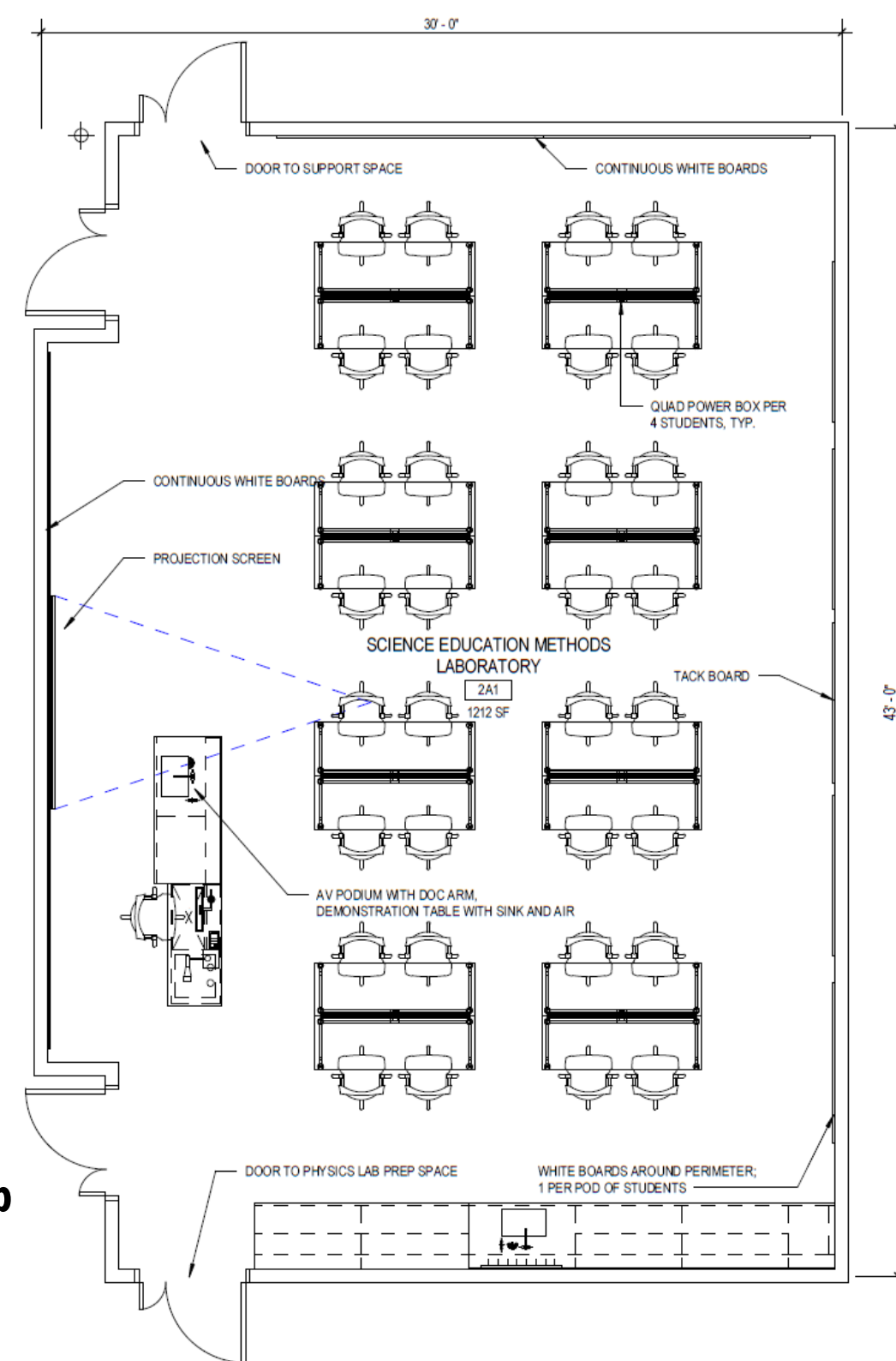

# SCIENCE EDUCATION METHODS

## WHAT WE HEARD

- **Science ed**
  - **Storage for equipment (microscopes, probeware, computers)**
- **Nutrition does not require support space**
- **Reduced from 2 spaces and reallocate space to lab**

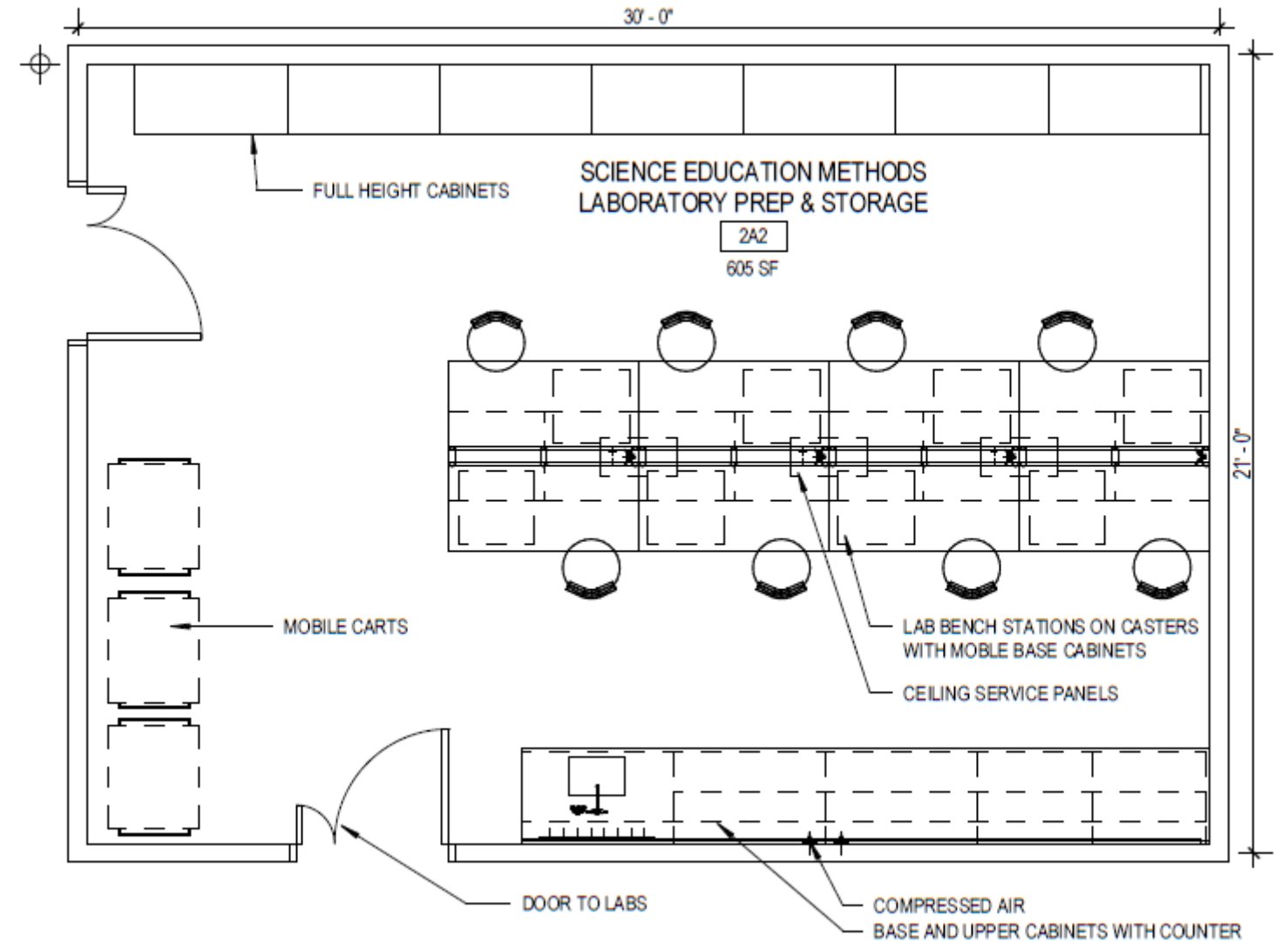

# SCIENCE EDUCATION METHODS

## WHAT WE HEARD

- **Adjacency, same floor as Science Methods lab not required**

